

B ISSUE FOR CONSTRUCTION - FULL PACK 18/07/16
A ISSUE FOR TENDER 18/06/29

Rev. Description Date



Architect: **Elvira Conajero Crespo**

Signature: _____

Job No.: **LB-PH-W01W-18**
Scale: **As indicated@A0**
Title: **BSMT FLOOR - GENERAL
ARRANGEMENT**
Sheet: **A-1.0 -L01** Rev. **B**

DEMISE AREA

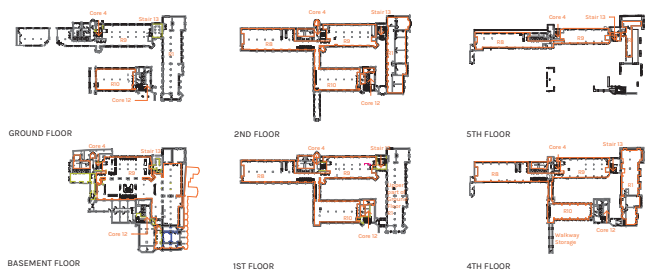

EXITING LEGEND

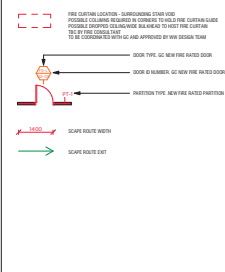

TOILETS COUNT

WW TOILETS COUNT		WW TOILETS COUNT		DESK COUNT	
TYPE	COUNT	TYPE	COUNT	LEVEL	DESK
1ST FLOOR		4TH FLOOR B3		4-1.0 -_DESK COUNT	
COUNT - DISABLED	1	COUNT - FEMALE WC	3	COLLAGE B301	1
COUNT - FEMALE WC	6	COUNT - MALE WC	2	COLLAGE B302	1
COUNT - MALE WC	5	COUNT - URINAL	2	COLLAGE B303	1
COUNT - URINAL	4	5TH FLOOR UPPER B3		COLLAGE B304	1
2ND FLOOR B3-B3		COUNT - MALE WC	1	COLLAGE B305	1
COUNT - DISABLED	1	COUNT - URINAL	2	COLLAGE B306	1
COUNT - FEMALE WC	6	5BMT FLOOR		COLLAGE B307	1
COUNT - MALE WC	5	COUNT - DISABLED	1	COLLAGE B308	1
COUNT - URINAL	4	COUNT - FEMALE WC	3	COLLAGE B309	1
4TH FLOOR B2		COUNT - MALE WC	3	COLLAGE B310	1
COUNT - DISABLED	1	COUNT - URINAL	2	COLLAGE B311	1
COUNT - FEMALE WC	2	6TH FLOOR		COLLAGE B312	1
COUNT - MALE WC	4	COUNT - FEMALE WC	3	COLLAGE B313	1
COUNT - URINAL	4	COUNT - MALE WC	2	COLLAGE B314	1
Grand total: 67		COUNT - URINAL	2	COLLAGE B315	1

SHEET NOTES

- MAIN CONTRACTOR SHALL SUBMIT FOR THE ARCHITECT'S APPROVAL DETAILED SHOP DRAWINGS FOR ALL JOINERY ITEMS PRIOR TO FABRICATION.
 - ALL EXISTING AND NEW FLOOR SLAB PENETRATIONS FOR CORE DRLLS AND/OR PIPING SHALL BE FULLY PACKED AND SEALED WITH APPROVED FIRE STOPPING MATERIALS.
 - RATIA, REPAIR, OR REPLACE AS REQUIRED FIREPROOFING ON BASE BUILDING STRUCTURE EITHER MISSING OR DAMAGED IN THE COURSE OF DEMOLITION OR CONSTRUCTION.
 - PROTECT ALL EXISTING CONDITIONS AND REPAIR ANY DAMAGE CAUSED BY THE WORKS.
 - BASE CONTRACTOR TO INSPECT AND PROTECT THE FINISHES PRIOR TO COMMENCING THE WORK AND REPORT TO THE OWNER AND ARCHITECT ALL DAMAGE FOUND.
 - BASE CONTRACTOR TO INSPECT AND PROTECT THE FINISHES PRIOR TO COMMENCING THE WORK AND REPORT TO THE OWNER AND ARCHITECT ALL DAMAGE FOUND.
 - ALL ENCLOSED SPACES WITH DOORS TO ACHIEVE MIN. OF 30MIN ADDITIONAL BATTING UNLESS OTHERWISE NOTED.
 - PARTITIONING MUST COMPLY AND COORDINATE WITH EXISTING GEOMETRY: SLOPED WALLS, CURVED CEILING, HANGING BEAM, ETC.
 - IF MORE PARTS OF THE BUILDING MIGHT EVACUATE THROUGH THESE STAIRS, FIRE STRATEGY SHOULD BE REVIEWED.
- ALL FIRE DOORS TO BE PROVIDED WITH SMALL SEALS**
REFER TO ENGINEERS FIRE STRATEGY REPORT FOR FURTHER DETAILS

DESK NOTES

