

**Construction Method Statement For Lowering Existing Basement Slab**

1. Install Horizontal Props at maximum 1800mm centers across the site. Use RMD or similar approved heavy duty props.
2. Carefully break out existing concrete slab at first underpin.
3. Excavate and cast first underpin.
4. Provide starter bars pushed into the earth each side for the adjacent underpins and the new basement slab.
5. 24 hours minimum later dry pack between underside of existing foundation and new foundation.
6. Repeat operations (2) to (4) second underpin.
7. Repeat this procedure all along each party wall until all the underpinning has been completed.

A	RC Wall Revised	12.07.18
Rev	Description	Date
Client		

Architect

Project  
 11A Parkhill Road  
 London  
 NW3

Drawing Title  
 Temporary Works Sheet 1

**howardcavanna**  
 consulting engineers

3a Sandiford Road  
 Sutton, Surrey  
 SM3 9RN

t: 020 8644 0905

w: www.howardcavanna.co.uk  
 e: mail@howardcavanna.co.uk

Scale. 1:25 @A3	Drawn by.	Date.
Drg. Status.		

Drg No.  
 2018 019/TWO1 A

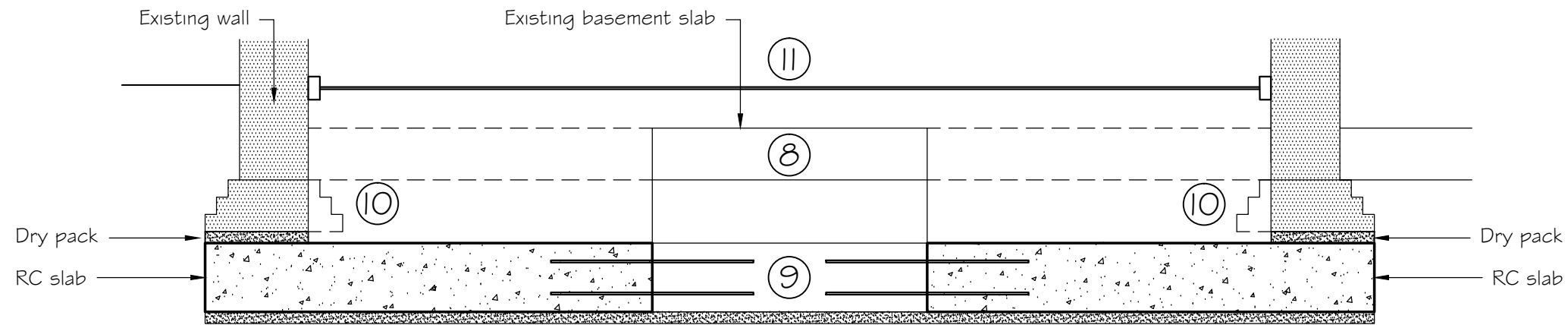

**Construction Method Statement For Lowering Existing Basement Slab**

- 8. Carefully break out remainder of existing basement slab.
- 9. Excavate and cast remainder of new basement slab.
- 10. When new concrete slab has reached its design strength carefully break away using hand tools the existing foundations projections.
- 11. Remove Horizontal props.

A	RC Wall Revised	12.07.18
Rev	Description	Date
Client		

Architect

Project  
 11A Parkhill Road  
 London  
 NW3

Drawing Title  
 Temporary Works Sheet 2

**howardcavanna**  
 consulting engineers

3a Sandiford Road  
 Sutton, Surrey  
 SM3 9RN  
 t: 020 8644 0905  
 w: www.howardcavanna.co.uk  
 e: mail@howardcavanna.co.uk

Scale. 1:25 @A3	Drawn by.	Date.
Drg. Status.		

Drg No.  
 2018 019/TW02 A

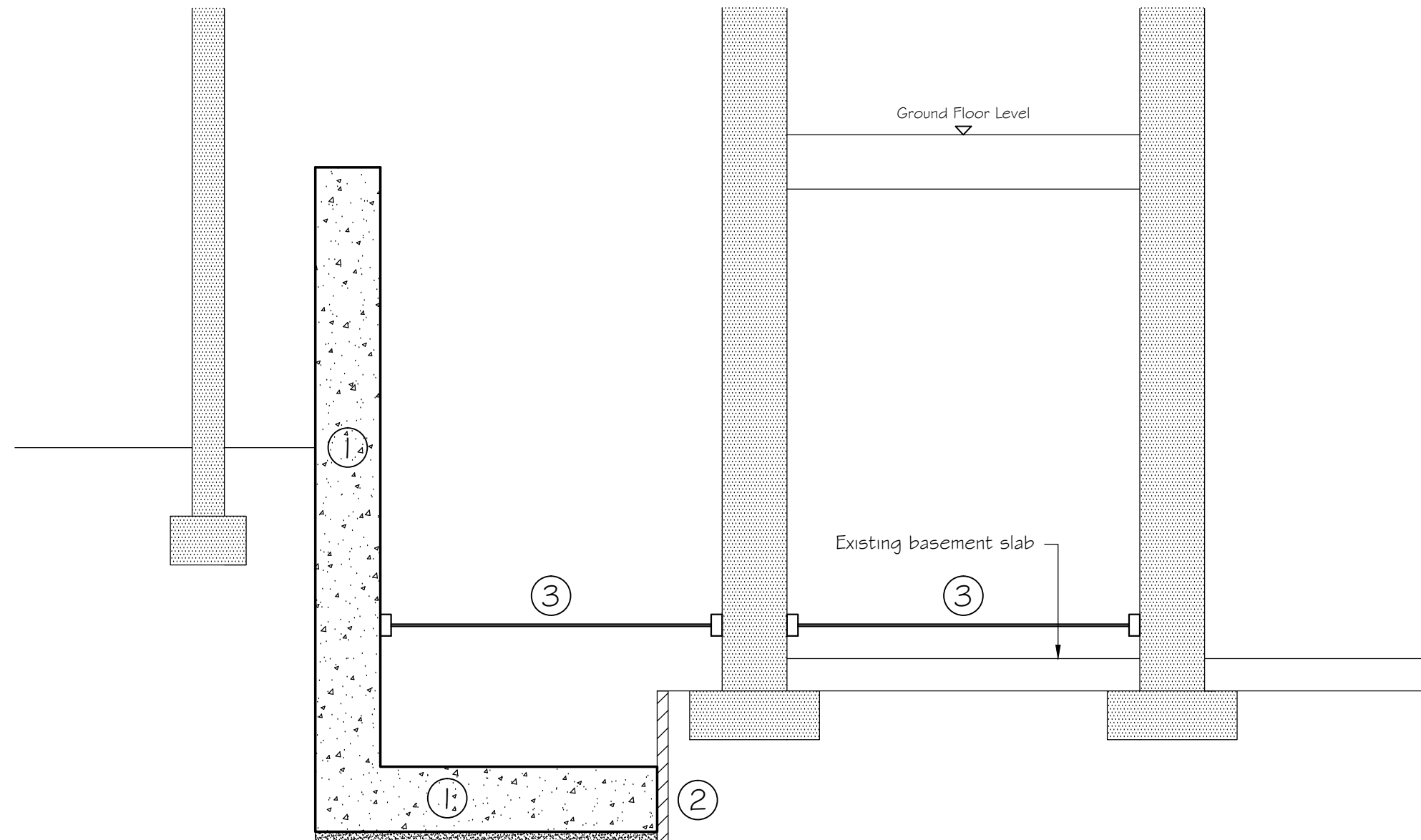

**Construction Method Statement For Construction Front Basement Area**

1. Locally excavate and cast first underpin base and wall section.
2. In conjunction with base section, push in trench sheeting to support earth under existing foundation.
3. Provide RMD or similar approved horizontal props across the site at lower level.
4. Provide starter bars pushed into the earth each side for the adjacent underpins.
5. Repeat operations (1) to (4) for the second underpin.
6. Repeat this procedure until all the underpinning along this side wall has been completed.

A	RC Wall Revised	12.07.18
Rev	Description	Date
Client		

Architect

Project  
 IIA Parkhill Road  
 London  
 NW3

Drawing Title

Temporary Works Sheet 3

**howardcavanna**  
 consulting engineers

3a Sandiford Road  
 Sutton, Surrey  
 SM3 9RN

t: 020 8644 0905

w: www.howardcavanna.co.uk  
 e: mail@howardcavanna.co.uk

Scale. 1:25 @A3	Drawn by.	Date.
Drg. Status.		

Drg No.  
 2018 019/TW03 A

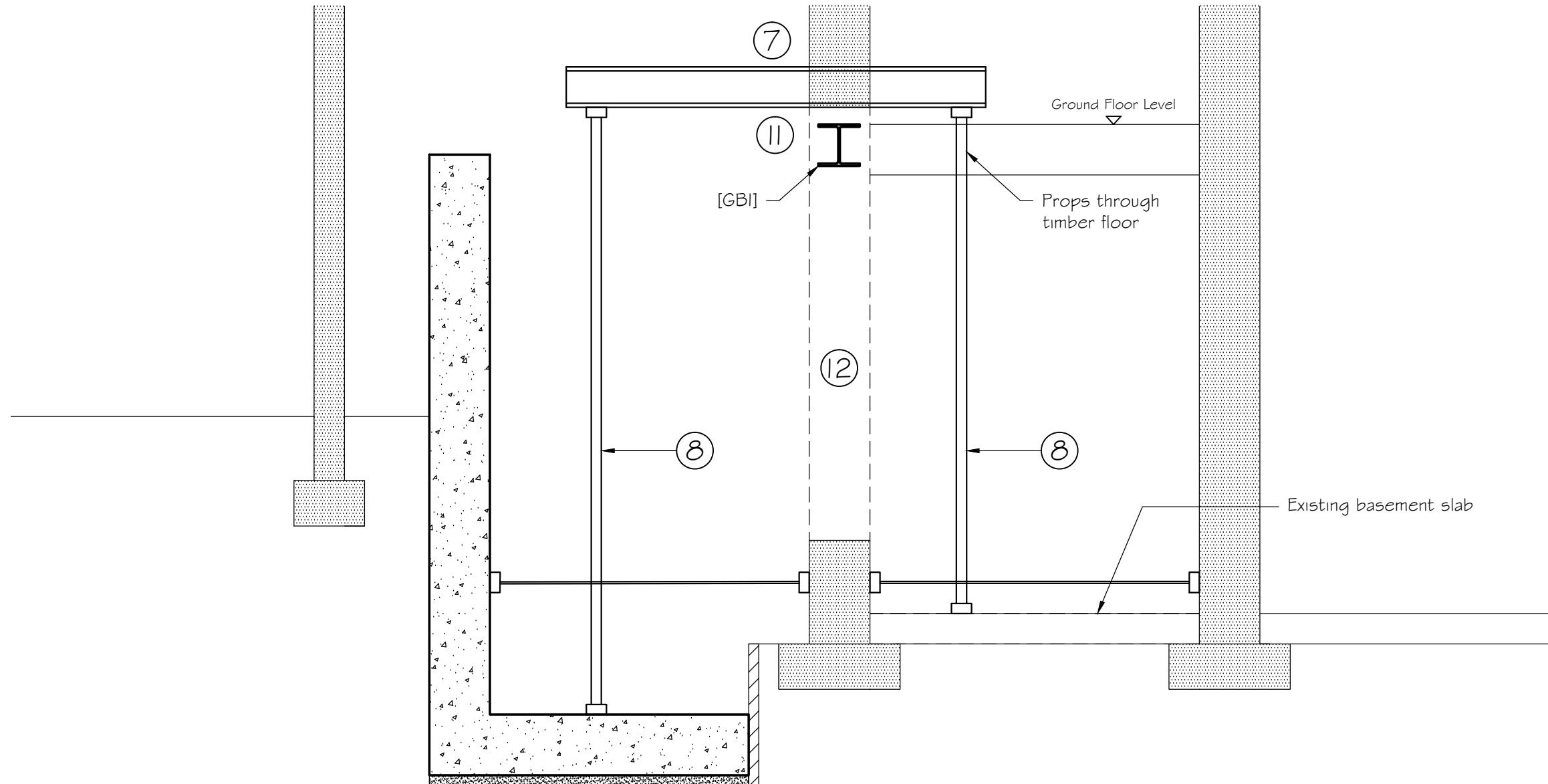

**Construction Method Statement For Construction Front Basement Area**

7. Carefully cut out pockets for 152x152x30 UC needles dry packed into position one at a time at 750mm centers.
8. Provide Acrow prop support to steel needles onto concrete underpinning and existing basement slab.
9. Excavate and cast underpin at front to receive column [C2].
10. Excavate and cast base for column [C3].
11. Install new beam [GBI] dry packed in place under existing masonry. With columns each end.
12. When dry pack has reached its design strength remove existing wall. Down to existing props.

A	RC Wall Revised	12.07.18
Rev	Description	Date
Client		

Architect

Project  
 IIA Parkhill Road  
 London  
 NW3

Drawing Title  
 Temporary Works Sheet 4

**howardcavanna**  
 consulting engineers

3a Sandiford Road  
 Sutton, Surrey  
 SM3 9RN  
 t: 020 8644 0905  
 w: www.howardcavanna.co.uk  
 e: mail@howardcavanna.co.uk

Scale. 1:25 @A3	Drawn by.	Date.
Drg. Status.		

Drg No.  
 2018 019/TW04 A

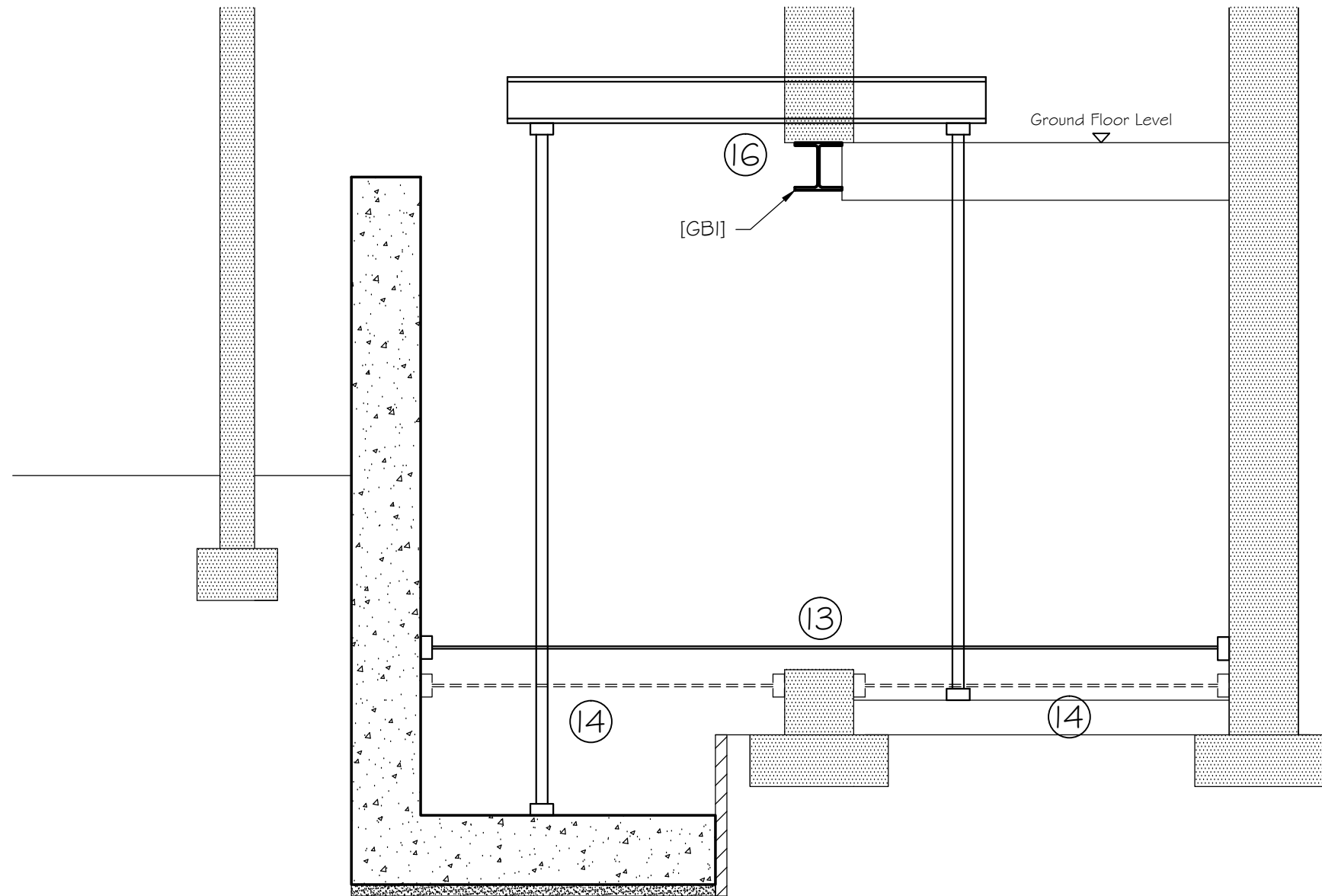

**Construction Method Statement For Construction Front Basement Area**

13. Install horizontal props at maximum 1800mm crs across the site. Use RMD or similar approved heavy duty props.

14. Remove low level props.

15. In conjunction with these works, the internal support pier to [GB1] would have been underpinned and beam [GB2] installed.

16. Carefully remove steel needles and props. Make good pockets with new brickwork dry packed in place.

A	RC Wall Revised	12.07.18
Rev	Description	Date
Client		

Architect

Project  
 IIA Parkhill Road  
 London  
 NW3

Drawing Title

Temporary Works Sheet 5

**howardcavanna**  
 consulting engineers

3a Sandiford Road  
 Sutton, Surrey  
 SM3 9RN

t: 020 8644 0905

w: www.howardcavanna.co.uk  
 e: mail@howardcavanna.co.uk

Scale. 1:25 @A3	Drawn by.	Date.
Drg. Status.		

Drg No.  
 2018 019/TW05 A

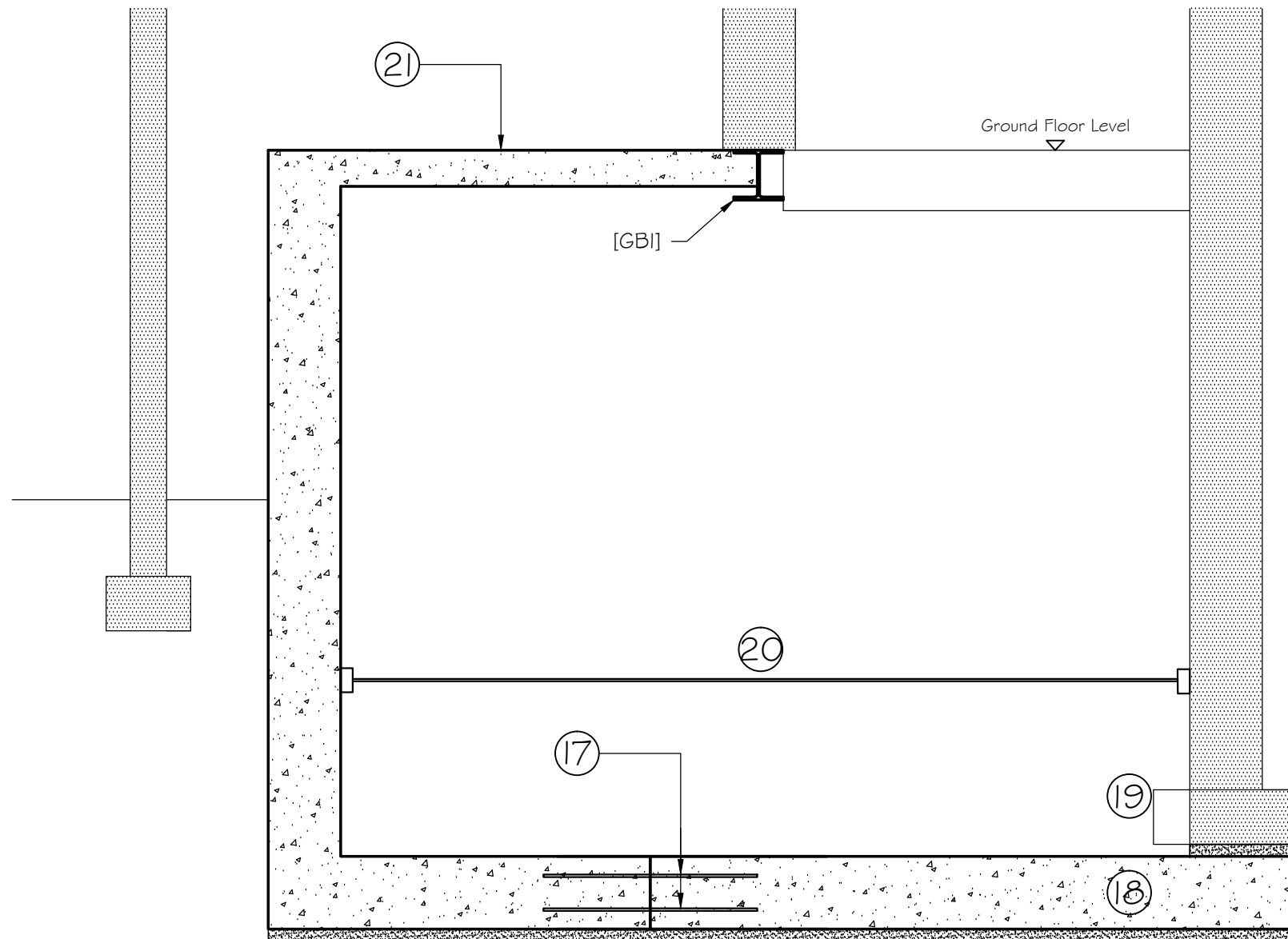

**Construction Method Statement For Construction Front Basement Area**

17. Resin bond T12 lap bars top and bottom into concrete for new slab.

18. The existing basement slab is to be lowered and the party wall undrinned in accordance with the method statement on Sheet TWO1, TWO2.

19. When basement slab has reached its design strength. The existing foundation projections can be carefully broken off using hand tools.

20. The temporary horizontal props can be removed.

21. Cast high level slab.

A	RC Wall Revised	12.07.18
Rev	Description	Date

Client

Architect

Project

I1A Parkhill Road  
London  
NW3

Drawing Title

Temporary Works Sheet 6

**howardcavanna**  
consulting engineers

3a Sandiford Road  
Sutton, Surrey  
SM3 9RN

t: 020 8644 0905

w: www.howardcavanna.co.uk  
e: mail@howardcavanna.co.uk

Scale. 1:25 @A3

Drawn by.

Date.

Drg. Status.

Drg No.

2018 019/TW06 A