

NOTES

DO NOT SCALE FROM THIS DRAWING

PLANNING

existing planting and timber box to be retained

existing painted hardwood window panels with double glazed sealed units

existing painted hardwood door / window panels potentially rehung in new extension position

existing party wall

existing painted hardwood window panels with double glazed sealed units

existing chimney

existing planting and balustrade to be retained

A

A

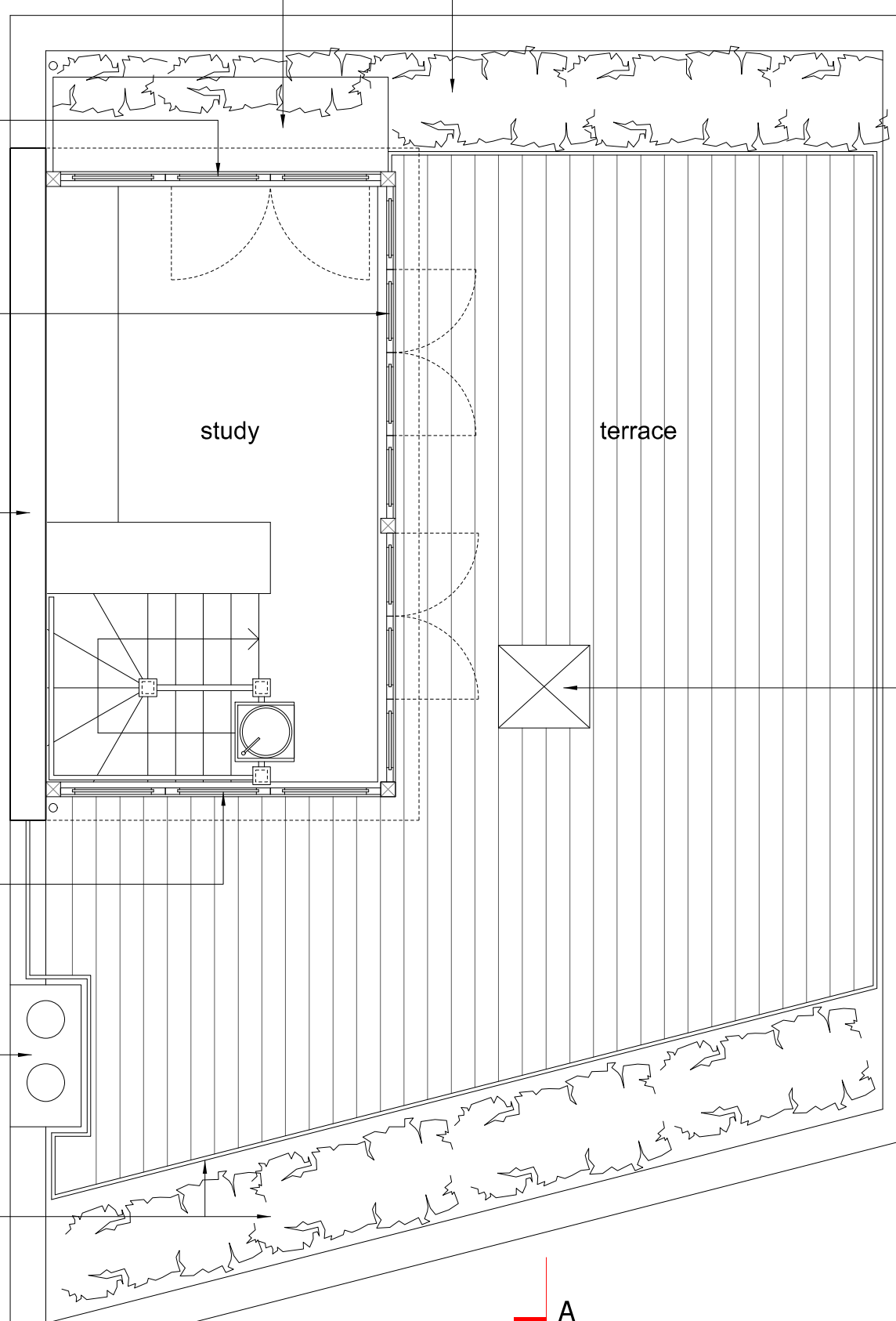

existing rooflight retained

23 Perrins Walk

24 Perrins Walk

**Martin Evans**  
Architects©

18 Charlotte Road  
London EC2A 3PB  
tel 020 7729 2474

**JOB**  
Mr and Mrs Paul Knight  
23 PERRINS WALK

**TITLE**  
EXISTING  
TERRACE PLAN

**DATE** 12.03.2018  
**SCALE** 1:50 @ A3

**DRAWING NO.** PER-PL-GA-02

NOTES

DO NOT SCALE FROM THIS DRAWING

# PLANNING

A

A

single ply roof to be adapted for new extension

concrete coping stone on top of the party wall

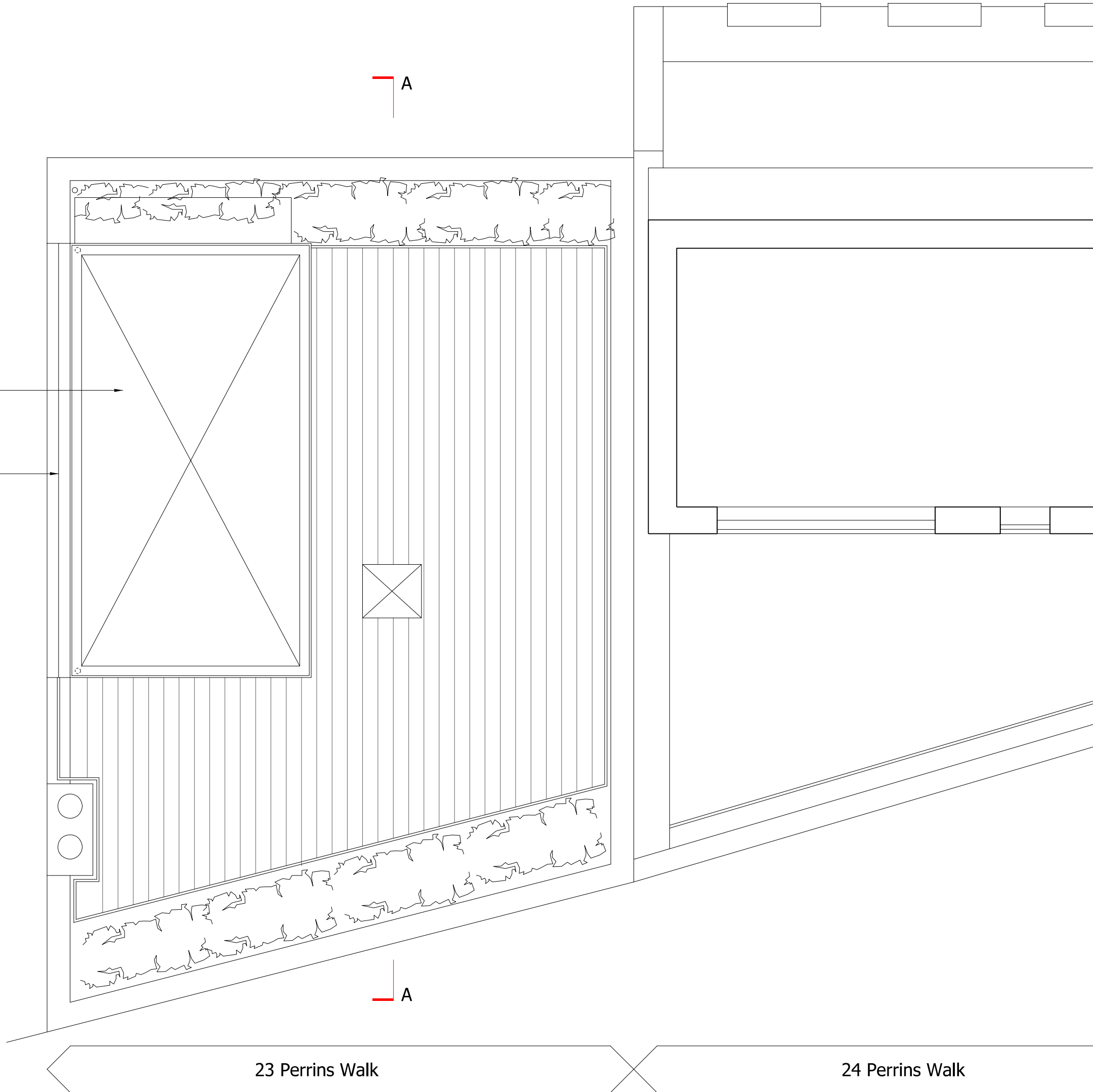

**Martin Evans**  
Architects©

18 Charlotte Road  
London EC2A 3PB  
tel 020 7729 2474

**JOB**  
Mr and Mrs Paul Knight  
23 PERRINS WALK

**TITLE**  
EXISTING  
ROOF PLAN

**DATE** 12.03.2018  
**SCALE** 1:50 @ A3

**DRAWING NO.** PER-PL-GA-03

23 Perrins Walk

24 Perrins Walk

NOTES

DO NOT SCALE FROM THIS DRAWING

PLANNING

concrete coping stone

existing painted hardwood window panels with double glazed sealed units

existing planting and balustrade to be retained



23 Perrins Walk

24 Perrins Walk

**Martin Evans**  
Architects©

18 Charlotte Road  
London EC2A 3PB  
tel 020 7729 2474

**JOB**  
Mr and Mrs Paul Knight  
23 PERRINS WALK

**TITLE**  
EXISTING  
FRONT ELEVATION

**DATE** 12.03.2018  
**SCALE** 1:50 @ A3

**DRAWING NO.** PER-PL-GA-04

NOTES

DO NOT SCALE FROM THIS DRAWING

PLANNING



**Martin Evans**  
Architects©

18 Charlotte Road  
London EC2A 3PB  
tel 020 7729 2474

**JOB**  
Mr and Mrs Paul Knight  
23 PERRINS WALK

**TITLE**  
EXISTING  
REAR ELEVATION

**DATE** 12.03.2018  
**SCALE** 1:50 @ A3

**DRAWING NO.** PER-PL-GA-05

NOTES

DO NOT SCALE FROM THIS DRAWING

PLANNING



23 Perrins Walk

24 Perrins Walk

26 Perrins Walk

**Martin Evans**  
Architects©

18 Charlotte Road  
London EC2A 3PB  
tel 020 7729 2474

**JOB**  
Mr and Mrs Paul Knight  
23 PERRINS WALK

**TITLE**  
EXISTING  
CONTEXT ELEVATION

**DATE** 12.03.2018  
**SCALE** 1:100 @ A3

**DRAWING NO.** PER-PL-GA-06

NOTES

DO NOT SCALE FROM THIS DRAWING

PLANNING

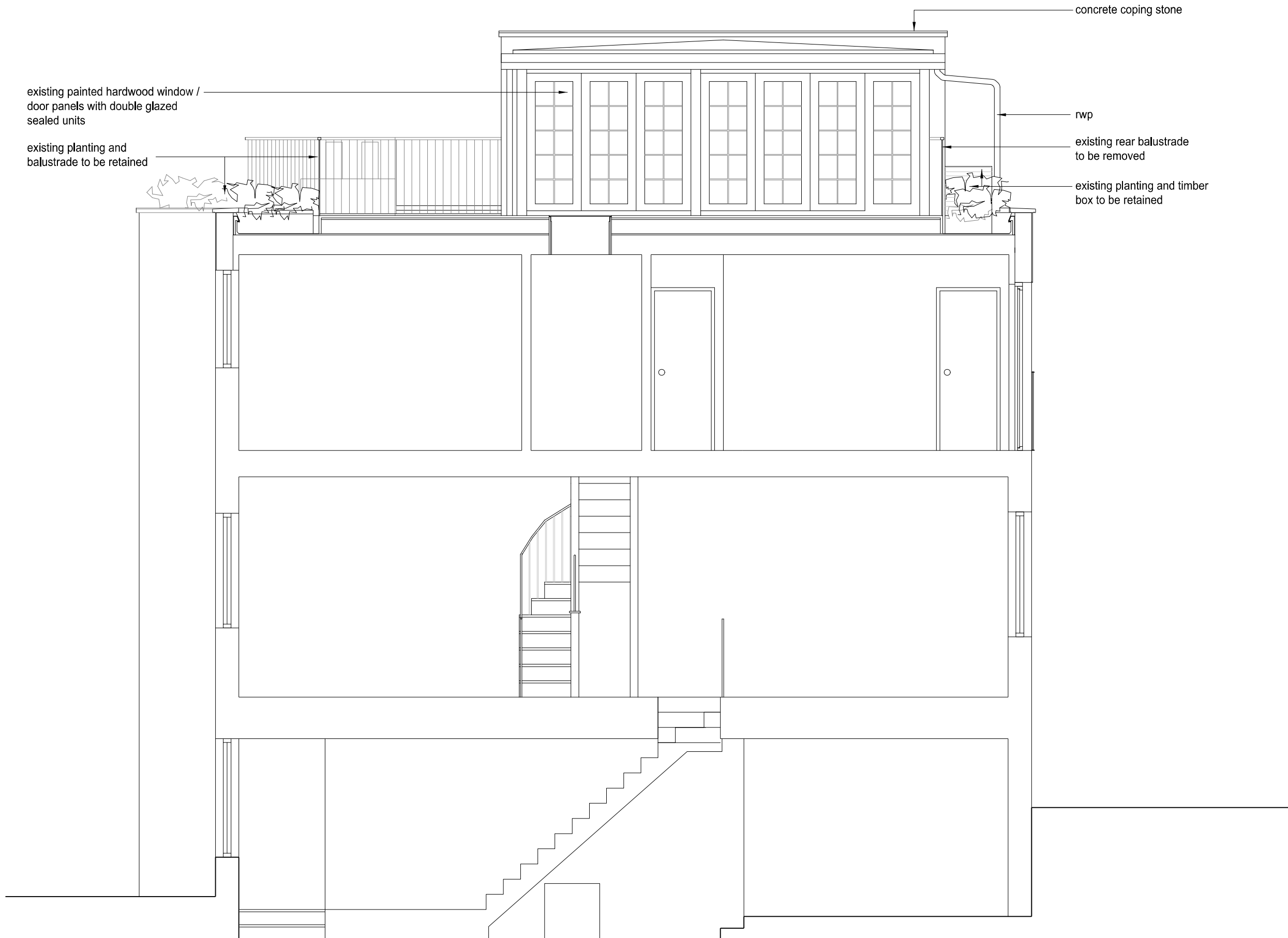

existing painted hardwood window / door panels with double glazed sealed units

existing planting and balustrade to be retained

concrete coping stone

nwp

existing rear balustrade to be removed

existing planting and timber box to be retained

**Martin Evans**  
Architects©

18 Charlotte Road  
London EC2A 3PB  
tel 020 7729 2474

**JOB**  
Mr and Mrs Paul Knight  
23 PERRINS WALK

**TITLE**  
EXISTING  
SECTION AA

**DATE** 12.03.2018  
**SCALE** 1:50 @ A3

**DRAWING NO.** PER-PL-GA-07