

South

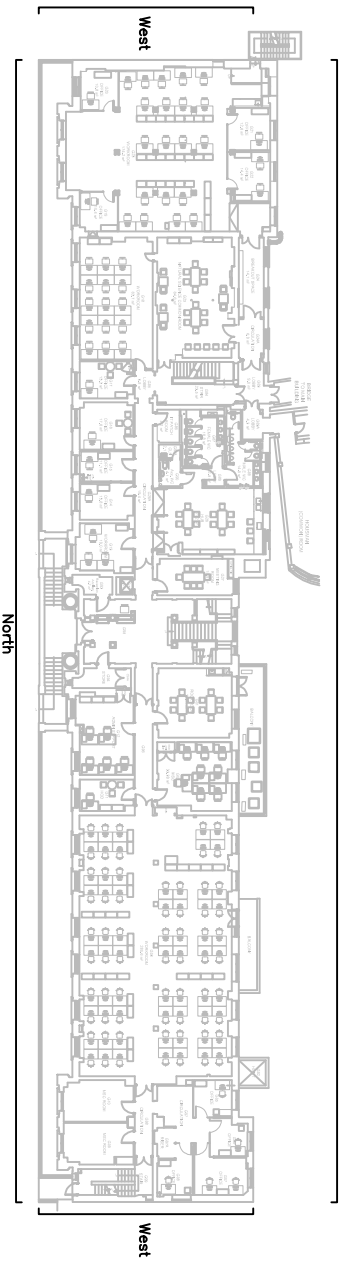

1 Elevation Identification Plan

NTS @ A3

- G** - SOW ref 4.15.
- I** - SOW ref 4.17.

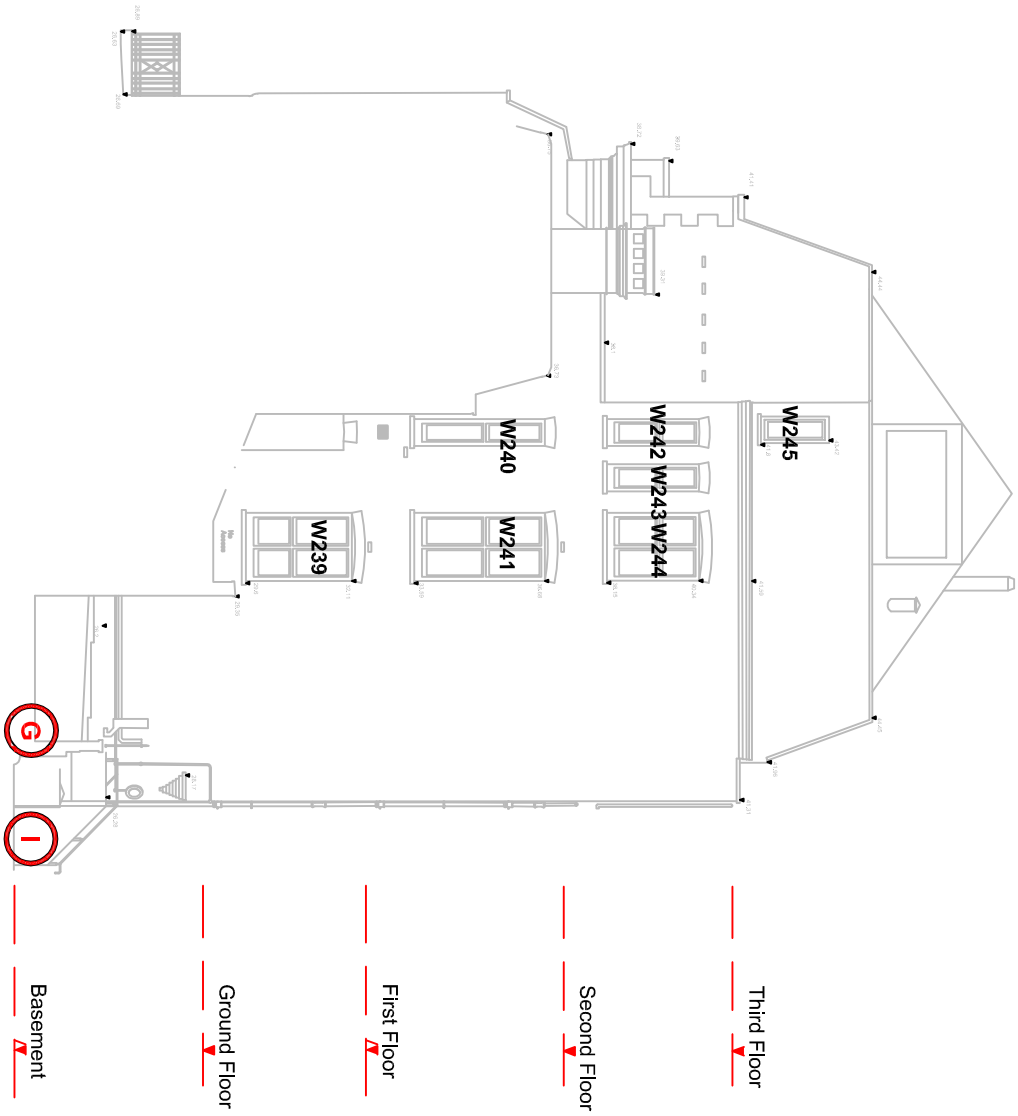

2 Side Elevation (West)

1 : 200 @ A3

Rev Description	Date
- Tender	14.03.2018

Client: University College London

Project Location: Kathleen Lonsdale Building
Gower Street,
London
WC1E 6BT

Project Status: Tender

Project Name: KLB, External Decorations 2018

Scale: 1:200 Sheet Size: 297 mm x 420 mm @ A3

Sheet Name: Side Elevation (West)

LA675 | 106

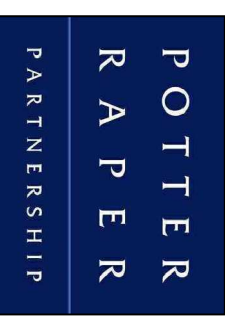

101 St. Martin's Lane
London,
WC2N 4AZ
Tel: 020 7436 5005