

- C - SOW ref 4.09.
- D - SOW ref 4.10.

1 Elevation Identification Plan
NTS @ A3

Section D

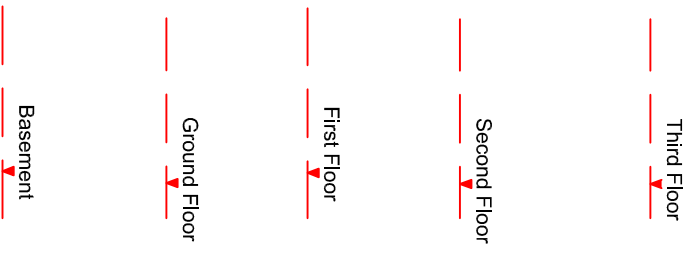
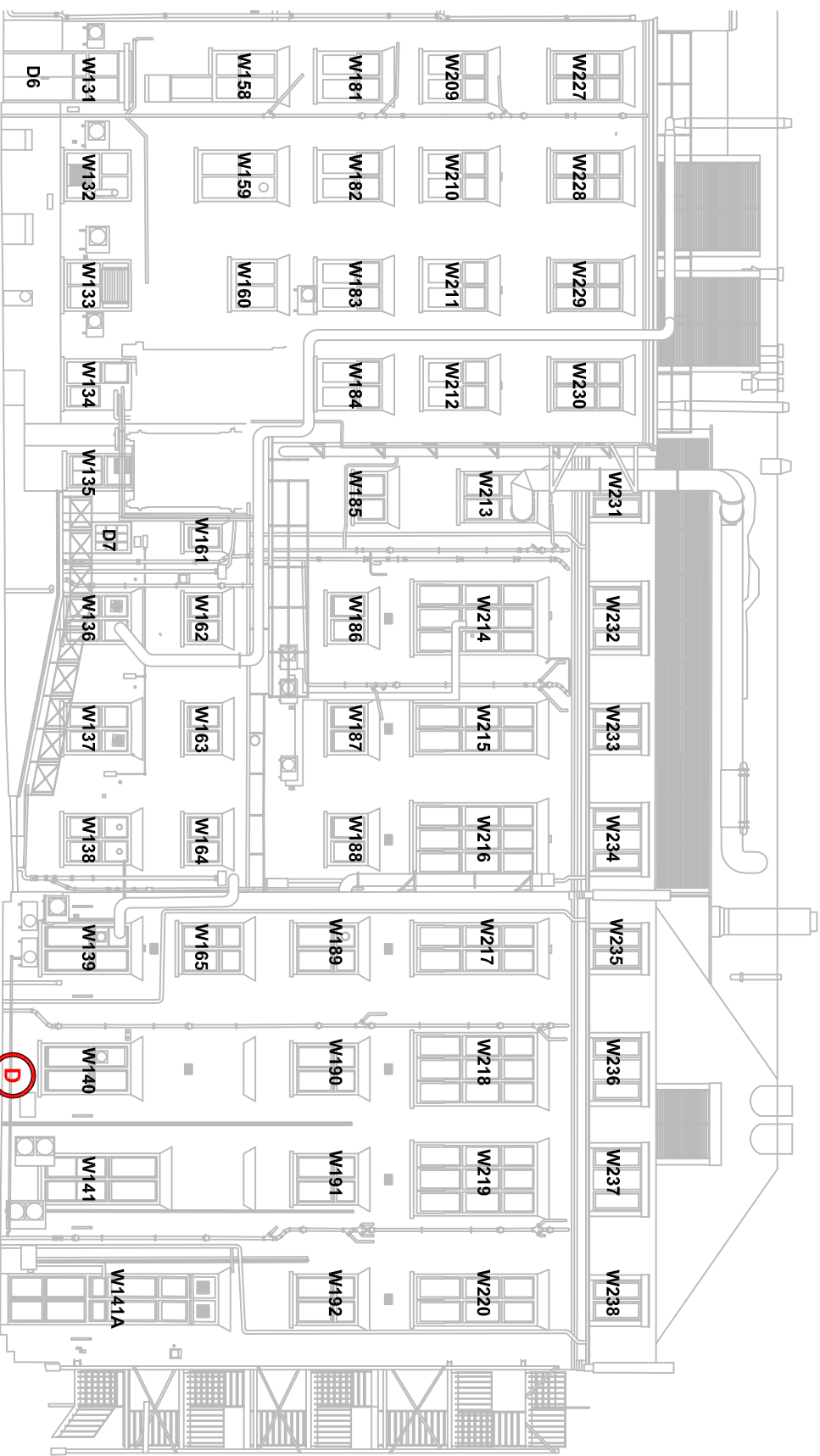

2 Rear Elevation - Section D
1 : 200 @ A3

Site Boundary Line

Rev Description	Date
- Tender	14.03.2018

Client: University College London

Project Location: Kathleen Lonsdale Building
Gower Street,
London
WC1E 6BT

Project Status: Tender

Project Name: KLB, External Decorations 2018

Scale: 1:200 Sheet Size: 297 mm x 420 mm @ A3

Sheet Name: Rear Elevation - Section D

LA675 | 105

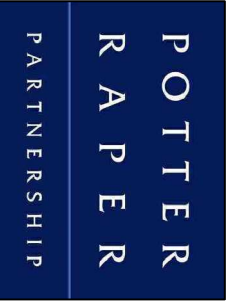

101 St. Martin's Lane
London,
WC2N 4AZ
Tel: 020 7436 5005