

M&E equipment to be confirmed by specialist

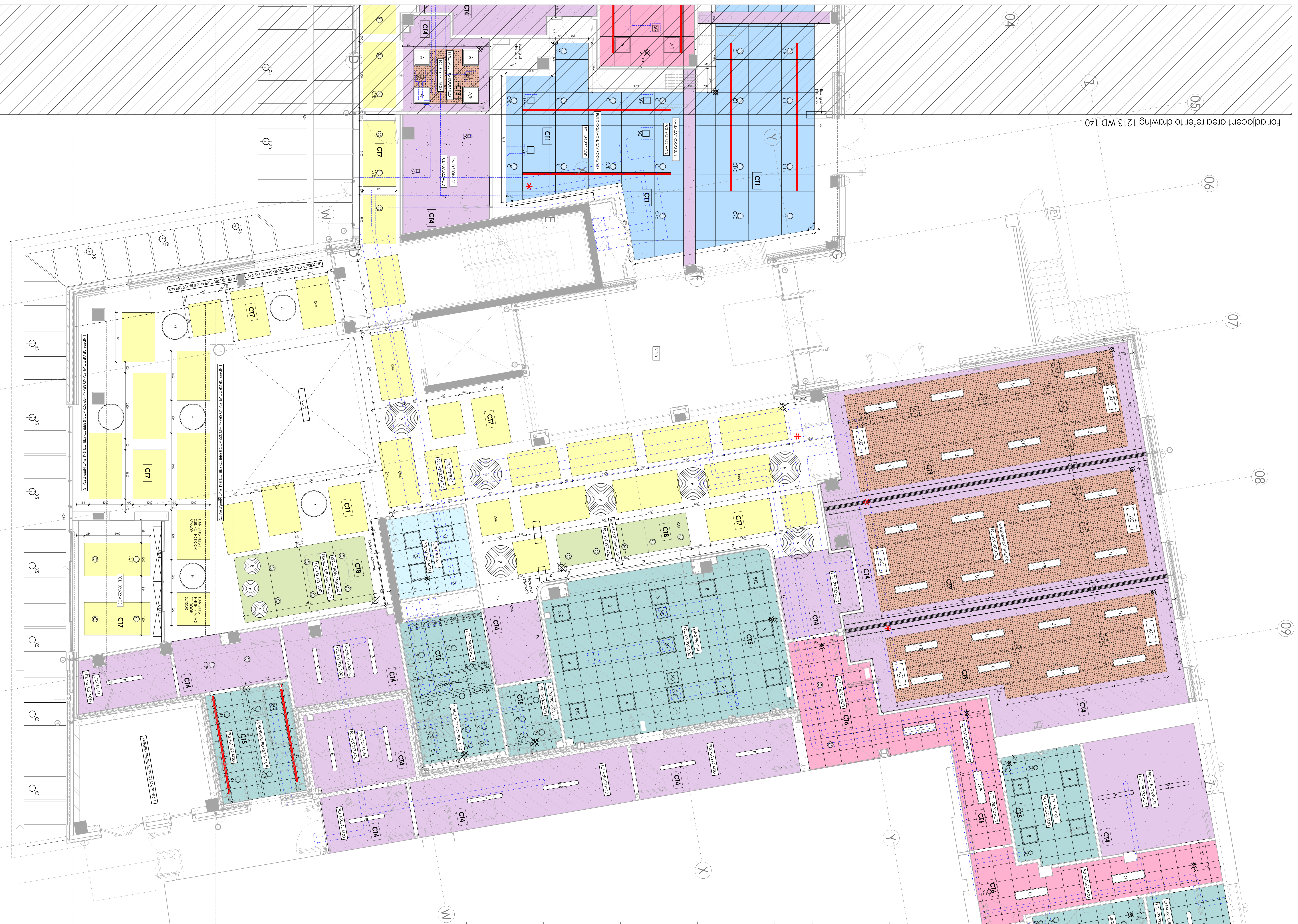

For adjacent area refer to drawing 1213.WD.140

For adjacent area refer to drawing 1213.WD.140

KEY
CEILING TYPES

- CT1: Armstrong Axiom C** suspended canopy system. Exposed concrete ceiling to perimeter to allow for positive cooling. 600 x 600 Ultimec+ Vector ceiling tile.
- CT2: Armstrong Axiom C** suspended ceiling system. No exposed perimeter. 600 x 600 Ultimec+ Vector ceiling tile.
- CT3: Armstrong Axiom C** suspended canopy system. Exposed concrete ceiling to perimeter to allow for positive cooling. 600 x 600 Ultimec+ Vector ceiling tile.
- CT4: Flatboard**
- CT5: Armstrong Hydroboard** ceiling system. Preclude 24 corrosive resistant suspended ceiling system with 600 x 600 Armstrong Hydroboard ceiling tiles.
- CT6: Proprietary suspended ceiling system:** with 600 x 600 Ultimec+ ceiling tiles.
- CT7: Armstrong Optima Canopy:** Independently suspended preformed acoustic canopy. 1200 x 1200/1800/2400
- CT8: Feature Armstrong Optima Canopy:** Multiple connected Optima Canopy panels with concealed aluminium frame system for lowered ceiling.
- CT9: Acoustic Flatboard:** Ceiling M&E system with Reglone 12/20/66 boards.

Radiation:
 Ceings under steel deck roof to receive 100mm Rockwool Fibre Insulation

Host Trunk location:

Indicative position of **ceiling fixing eyes** for window maintenance. Position & sizing to be confirmed by manufacturer.

ELECTRICAL / VENTILATION REFER TO SPECIALIST M&E DRAWINGS FOR DETAILS

- Sealing out position
- Extract Cable (Varying types)
- Supply Cable (Varying types)
- Ventilation Ductwork: Refer to M&E drawings for detailed information.
- Drainage locations: Refer to M&E drawings for detailed information.
- Beam locations: Refer to Structural Engineers drawings for detailed information.
- Recessed LED Light panel
- Recessed LED Light panel
- Recessed LED Downlight
- 1/8 Denolux Emergency luminaire
- Feature pendant lamp
- Dust & Moisture resistant LED
- Recessed LED Light panel
- 1/8 Denolux Emergency luminaire
- Feature pendant lamp
- Linear LED separable strip light
- Suspended LED globe light
- Suspended LED Light
- Suspended dome pendant
- Recessed LED Lights
- LED Emergency lighting
- Suspended Fluoresc LED
- Dislodged Alarm pull cord

- External Recessed Light
- All Conditioning Unit
- Overhead Door Header

GENERAL NOTE:

For detailed location & sizing of beams refer to structural engineers drawings.

For electrical & ventilation layouts and specifications refer to specialist M&E drawings. Access hatch locations in non-pendant ceiling locations to be confirmed by M&E engineers.

Location of disabled alarm pull cords (indicated by 'D' shown), to be positioned in relation to disabled WC layouts.

M&E drawings to be updated to locations marked with an 'X' to avoid ceiling clashes.

RC SOFFIT NOTE:
 * Generally: Where ceiling soffits are visible on room margins or spaces between canopies they will receive 1 coat of paint or dust sealer and an additional 2 further coats, colour RBC by client.
 Sub-note: Ceiling to receive 2 coats of white emulsion for dust proofing

PCIKO 3, 5, 8, 10, 12, 14, 16, 18, 20, 22, 24, 26, 28, 30, 32, 34, 36, 38, 40, 42, 44, 46, 48, 50, 52, 54, 56, 58, 60, 62, 64, 66, 68, 70, 72, 74, 76, 78, 80, 82, 84, 86, 88, 90, 92, 94, 96, 98, 100, 102, 104, 106, 108, 110, 112, 114, 116, 118, 120, 122, 124, 126, 128, 130, 132, 134, 136, 138, 140, 142, 144, 146, 148, 150, 152, 154, 156, 158, 160, 162, 164, 166, 168, 170, 172, 174, 176, 178, 180, 182, 184, 186, 188, 190, 192, 194, 196, 198, 200, 202, 204, 206, 208, 210, 212, 214, 216, 218, 220, 222, 224, 226, 228, 230, 232, 234, 236, 238, 240, 242, 244, 246, 248, 250, 252, 254, 256, 258, 260, 262, 264, 266, 268, 270, 272, 274, 276, 278, 280, 282, 284, 286, 288, 290, 292, 294, 296, 298, 300, 302, 304, 306, 308, 310, 312, 314, 316, 318, 320, 322, 324, 326, 328, 330, 332, 334, 336, 338, 340, 342, 344, 346, 348, 350, 352, 354, 356, 358, 360, 362, 364, 366, 368, 370, 372, 374, 376, 378, 380, 382, 384, 386, 388, 390, 392, 394, 396, 398, 400, 402, 404, 406, 408, 410, 412, 414, 416, 418, 420, 422, 424, 426, 428, 430, 432, 434, 436, 438, 440, 442, 444, 446, 448, 450, 452, 454, 456, 458, 460, 462, 464, 466, 468, 470, 472, 474, 476, 478, 480, 482, 484, 486, 488, 490, 492, 494, 496, 498, 500, 502, 504, 506, 508, 510, 512, 514, 516, 518, 520, 522, 524, 526, 528, 530, 532, 534, 536, 538, 540, 542, 544, 546, 548, 550, 552, 554, 556, 558, 560, 562, 564, 566, 568, 570, 572, 574, 576, 578, 580, 582, 584, 586, 588, 590, 592, 594, 596, 598, 600, 602, 604, 606, 608, 610, 612, 614, 616, 618, 620, 622, 624, 626, 628, 630, 632, 634, 636, 638, 640, 642, 644, 646, 648, 650, 652, 654, 656, 658, 660, 662, 664, 666, 668, 670, 672, 674, 676, 678, 680, 682, 684, 686, 688, 690, 692, 694, 696, 698, 700, 702, 704, 706, 708, 710, 712, 714, 716, 718, 720, 722, 724, 726, 728, 730, 732, 734, 736, 738, 740, 742, 744, 746, 748, 750, 752, 754, 756, 758, 760, 762, 764, 766, 768, 770, 772, 774, 776, 778, 780, 782, 784, 786, 788, 790, 792, 794, 796, 798, 800, 802, 804, 806, 808, 810, 812, 814, 816, 818, 820, 822, 824, 826, 828, 830, 832, 834, 836, 838, 840, 842, 844, 846, 848, 850, 852, 854, 856, 858, 860, 862, 864, 866, 868, 870, 872, 874, 876, 878, 880, 882, 884, 886, 888, 890, 892, 894, 896, 898, 900, 902, 904, 906, 908, 910, 912, 914, 916, 918, 920, 922, 924, 926, 928, 930, 932, 934, 936, 938, 940, 942, 944, 946, 948, 950, 952, 954, 956, 958, 960, 962, 964, 966, 968, 970, 972, 974, 976, 978, 980, 982, 984, 986, 988, 990, 992, 994, 996, 998, 1000

GREENWOOD CENTRE
 Ground Floor
 Retailed Ceiling Plan
 (2 of 2)
 CONSTRUCTION
 DATE: 15/04/24
 DRAWN: 2017/24
 CHECKED: JF
 PROJECT: 1213.WD.141