

1 SECTION A-A  
SCALE 1:20

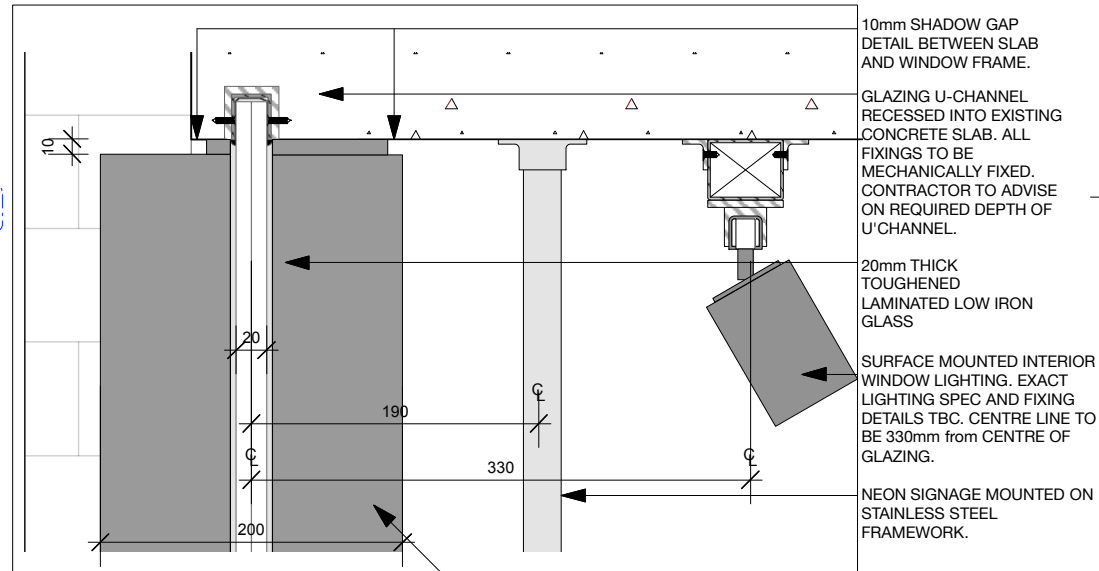

2 DETAIL a  
SCALE 1:5

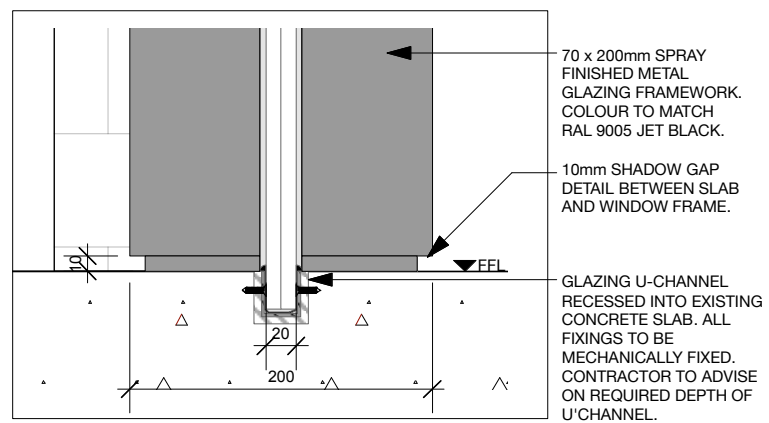

3 DETAIL b  
SCALE 1:5

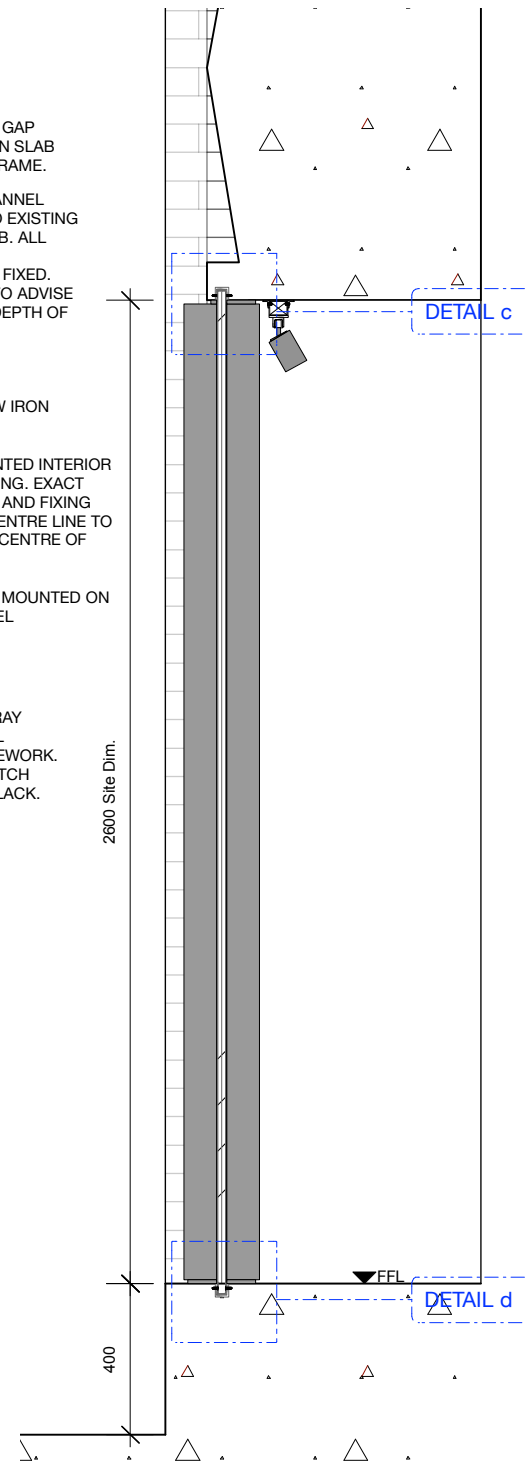

4 SECTION B-B  
SCALE 1:20

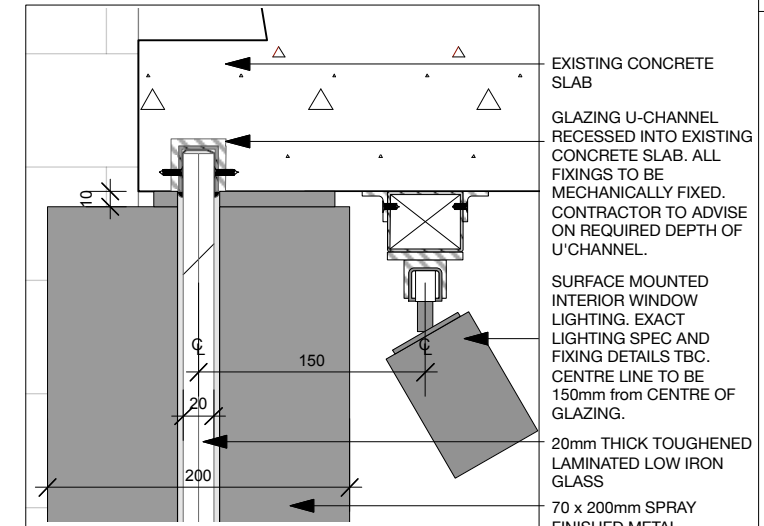

5 DETAIL c  
SCALE 1:5

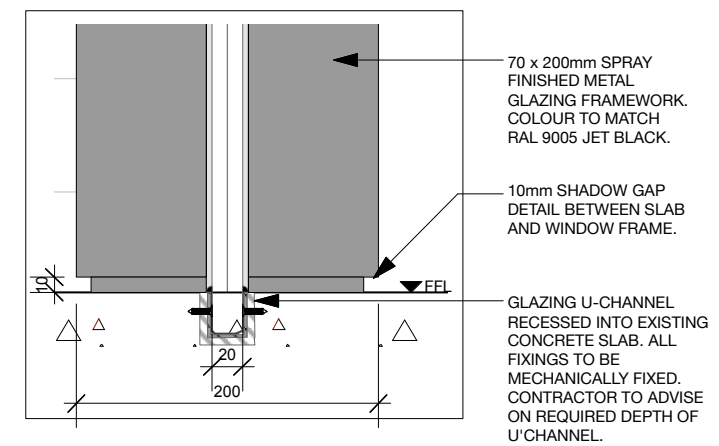

6 DETAIL d  
SCALE 1:5

PLEASE NOTE:  
**-DO NOT SCALE DRAWING.**  
 -CONTRACTOR TO CHECK ALL DIMENSIONS FROM DRAWINGS TO SITE AND NOTIFY THE ARCHITECT OF ANY DISCREPANCIES PRIOR TO FABRICATION TO ALLOW FOR MODIFICATIONS  
 -DISCREPANCIES NOT BROUGHT TO THE ATTENTION OF THE ARCHITECT WILL BE THE RESPONSIBILITY OF THE RELEVANT CONTRACTOR.  
 -THIS DRAWING SHOULD BE READ IN CONJUNCTION WITH ALL SPECIFICATIONS AND ALL RELEVANT DESIGN, ENGINEERS AND SPECIALIST DRAWINGS.  
 -THE CONTRACTOR MUST ADVISE ON ALL DETAILS TO ENSURE STABILITY AND STRENGTH OF CONSTRUCTION ALL MATERIALS TO BE MATCHED AND BALANCED AS APPROPRIATE.  
 -THE WORKS DESCRIBED AND SPECIFIED ON THIS DRAWING AND ASSOCIATED DRAWINGS SHALL BE UNDERTAKEN IN ACCORDANCE WITH CURRENT HEALTH AND SAFETY PLAN PREPARED BY THE PLANNING SUPERVISOR FOR THE PROJECT.

**NOTES:**  
 ALL HEIGHTS OF FACADE GLAZING AND DOORS DETERMINED BY HEIGHT OF INTERNAL BULK-HEAD DURING STRIPOUT WORKS.  
 A FULL SURVEY OF EXISTING FACADE TO BE CARRIED OUT BY CONTRACTOR PRIOR TO ANY MANUFACTURING OF NEW FACADE.

/ 20.06.2018 FOR APPROVAL

REVISION: DATE: DESCRIPTION:

**LINE**

JOB NAME: MADE STUDIO LONDON

SITE ADDRESS: 100 CHARING CROSS ROAD  
LONDON  
WC2

DRAWING: PROPOSED FACADE

DWG NO: C-402 JOB NO: 002 ISSUE NO: /

STATUS: FOR APPROVAL

SCALE: VARIOUS DATE: 20.06.2018

DRAWN BY: OF CHECKED BY: DW

© LINE INTERIOR ARCHITECTURE