

RED LINES INDICATE EXISTING DOORS
TO BE OMITTED/ RELOCATED

1 EXISTING FACADE PLAN
SCALE 1:200

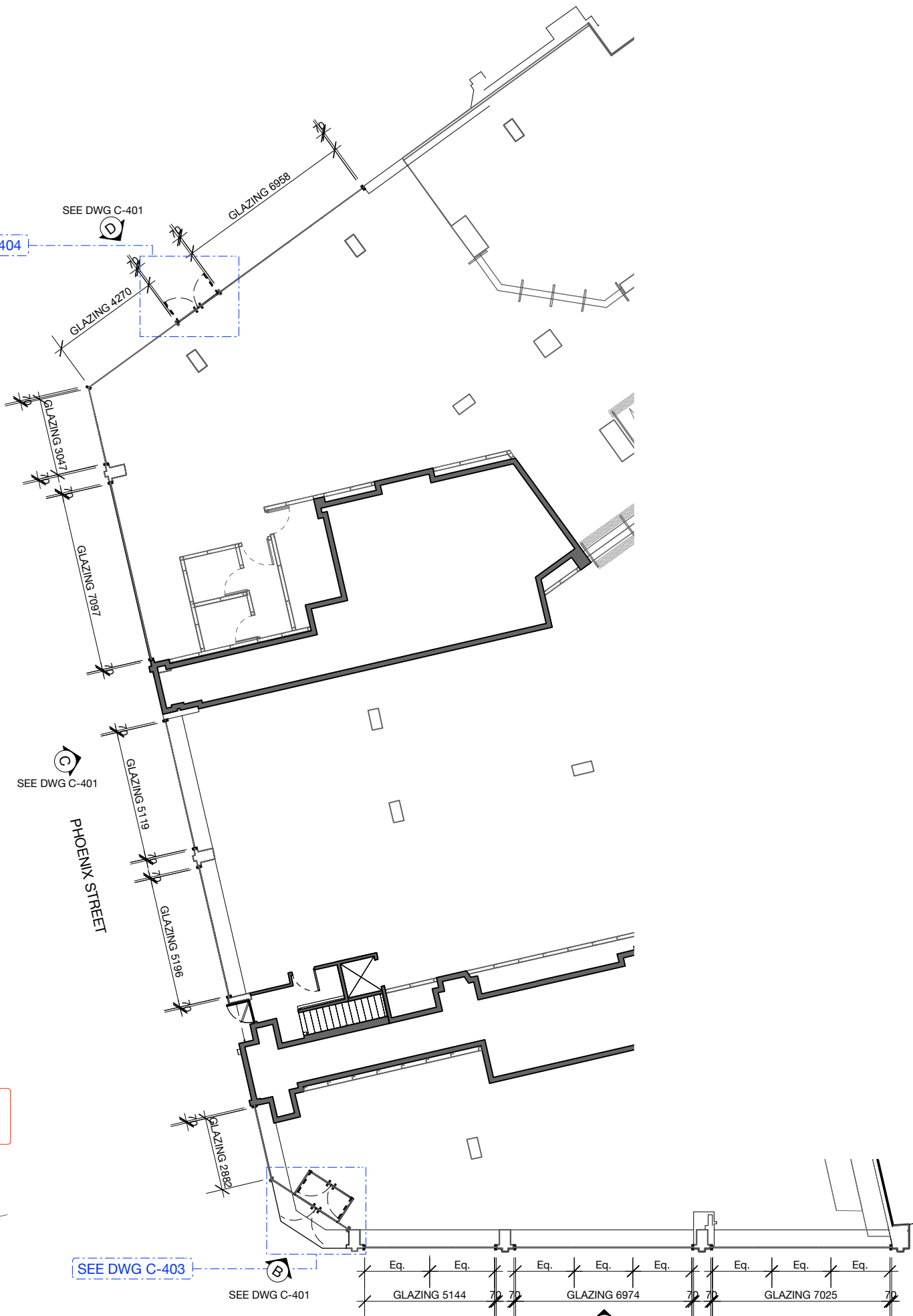

2 PROPOSED FACADE PLAN
SCALE 1:200

PLEASE NOTE:
-DO NOT SCALE DRAWING.
-CONTRACTOR TO CHECK ALL DIMENSIONS FROM DRAWINGS TO SITE AND NOTIFY THE ARCHITECT OF ANY DISCREPANCIES PRIOR TO FABRICATION TO ALLOW FOR MODIFICATIONS.
-DISCREPANCIES NOT BROUGHT TO THE ATTENTION OF THE ARCHITECT WILL BE THE RESPONSIBILITY OF THE RELEVANT CONTRACTOR.
-THIS DRAWING SHOULD BE READ IN CONJUNCTION WITH ALL SPECIFICATIONS AND ALL RELEVANT DESIGN, ENGINEERS AND SPECIALIST DRAWINGS.
-THE CONTRACTOR MUST ADVISE ON ALL DETAILS TO ENSURE STABILITY AND STRENGTH OF CONSTRUCTION ALL MATERIALS TO BE MATCHED AND BALANCED AS APPROPRIATE.
-THE WORKS DESCRIBED AND SPECIFIED ON THIS DRAWING AND ASSOCIATED DRAWINGS SHALL BE UNDERTAKEN IN ACCORDANCE WITH CURRENT HEALTH AND SAFETY PLAN PREPARED BY THE PLANNING SUPERVISOR FOR THE PROJECT.

NOTES:
ALL HEIGHTS OF FACADE GLAZING AND DOORS DETERMINED BY HEIGHT OF INTERNAL BULK-HEAD DURING STRIP-OUT WORKS.
A FULL SURVEY OF EXISTING FACADE TO BE CARRIED OUT BY CONTRACTOR PRIOR TO ANY MANUFACTURING OF NEW FACADE.

/ 20.06.2018 FOR APPROVAL

REVISION: DATE: DESCRIPTION:

LINE

JOB NAME: MADE STUDIO LONDON

SITE ADDRESS: 100 CHARING CROSS ROAD
LONDON
WC2

DRAWING: PROPOSED FACADE

DWG NO: C-400 JOB NO: 002 ISSUE NO: /

STATUS: FOR APPROVAL

SCALE: 1:200 @ A3 DATE: 20.06.2018

DRAWN BY: OF CHECKED BY: DW

© LINE INTERIOR ARCHITECTURE