

- A** NEW ALDI SIGNAGE FASCIA TO CONSIST OF NON-ILLUMINATED BLUE ALUMINIUM FASCIA PANELS WITH ILLUMINATED PROJECTING WHITE 'ALDI' LETTERING. OTHER LETTERING NON PROJECTING/NON ILLUMINATED. (West Elevation)
- B** NEW ILLUMINATED LOGO SIGN. (West Elevation)
- C** VINYL ALDI LOGO TO BE APPLIED TO THE INSIDE OF GLAZED PANELS AT FRONT AND REAR ENTRANCE DOORS.
- D** NEW ILLUMINATED PROJECTING BLADE SIGN "ALDI LOGO". FIXED THROUGH MAIN ALDI SIGNAGE BOARD BACK TO THE EXISTING PILASTER.
- E** VINYL ALDI LOGO TO BE APPLIED TO THE INSIDE OF GLAZED PANELS AT FRONT ELEVATION

KILBURN HIGH ROAD

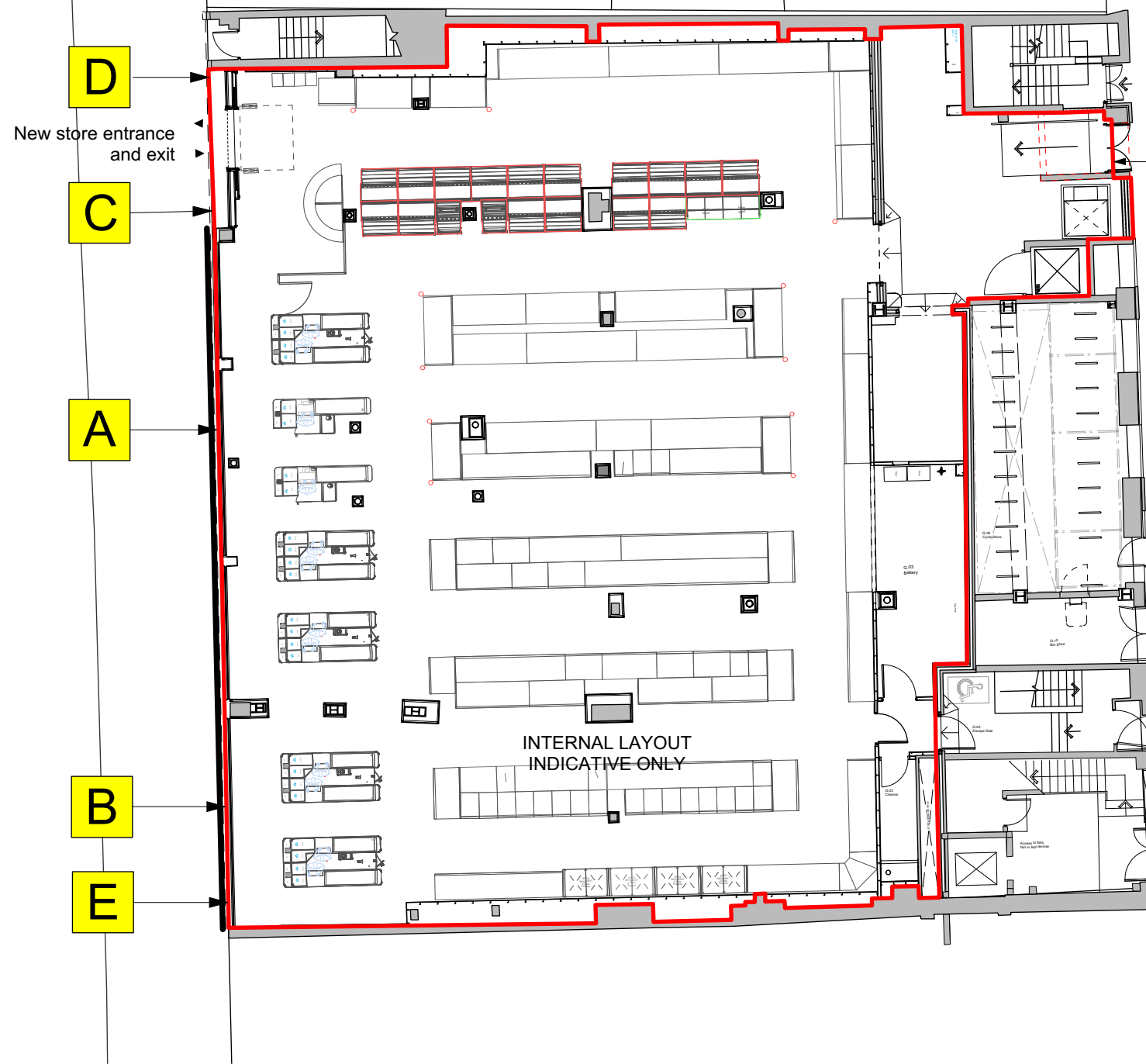

KINGSGATE PLACE

Good entrance position adjusted to allow lift improvements

NOTE: REFER TO ELEVATIONS AND SECTION 180431 - 1500 FOR FURTHER INFORMATION

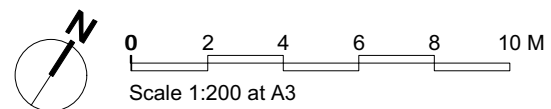

Chartered Architects
Chartered Building Surveyors
Interior Designers
CDM Co-ordinators

Glentworth Court, Lime Kiln Close
Stoke Gifford, Bristol BS34 8SR
+44 (0)117 931 2062
www.kendallkingscott.co.uk

Project
**ALDI Stores
Kilburn, Store Alterations**

Client
ALDI Stores Ltd

Scale	Paper Size	Filename
1:200	A3	Filename.vwx
© Copyright. Do not scale this drawing.		

2 2/7/18 MWGS Draft omitted. Layout note added.
Rv. Date By Ap Note

Drawing Title
Proposed Site Plan

Project No.	Drawing No.	Rev.	
180431 - 1400 - P2			
Date	Drawn	Checked	Status
29/6/18	SK	MW	PLANNING
Check all dimensions and levels on site.			