

○ Emergency Lighting

■ Illuminated exit sign

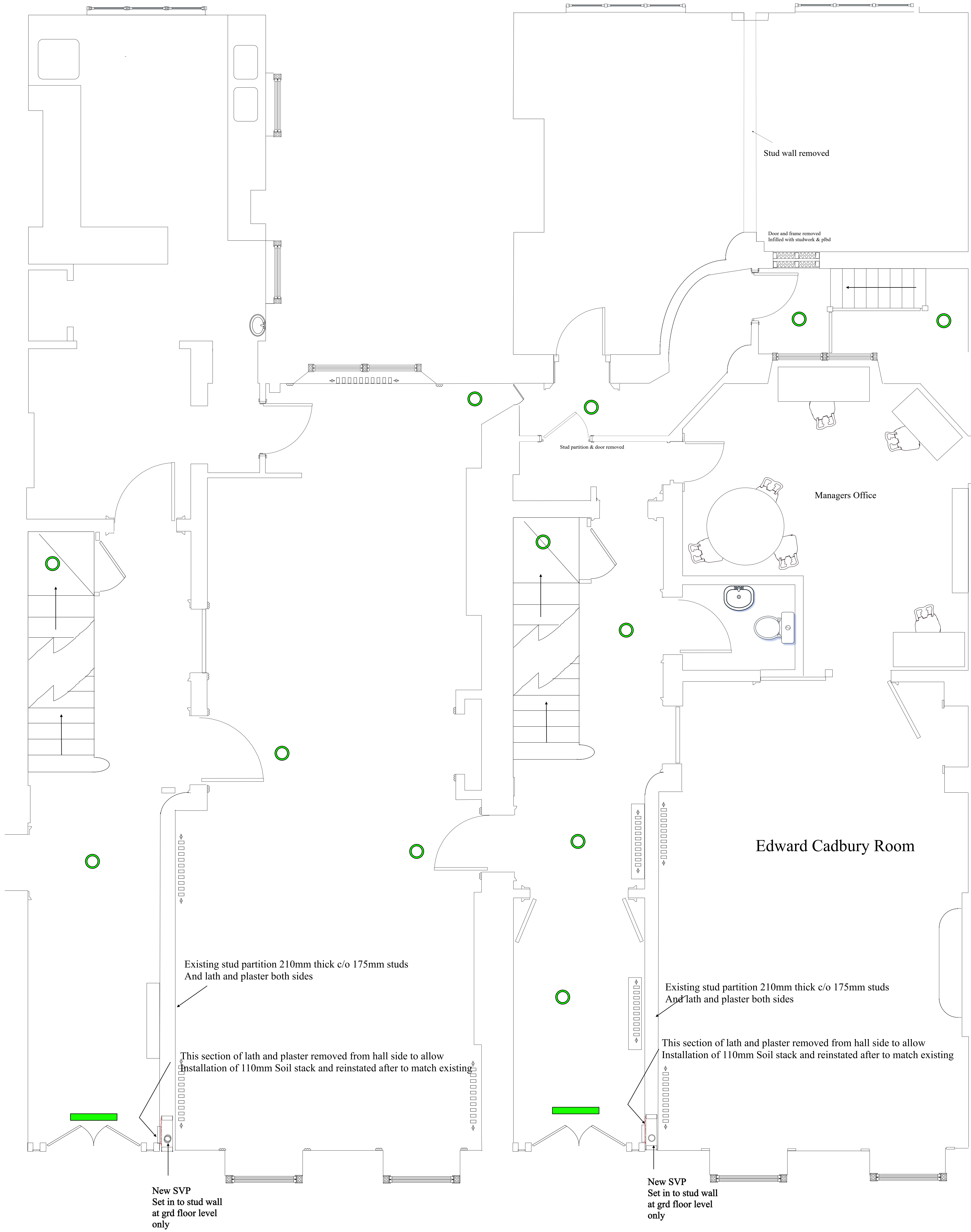

REVISIONS
A. 04/07/2018
Soil pipe set into stud wall
Door into reception and associated works
confirmed. Cadbury rooms to remain as is

Scale: 1:25 Date: 13.02.2018
Site: The Penn Club
House 21/22 Grd Floor
As Proposed
Dwg No: 198/03/A
LTC Design
3 Somerville Point
London SE16 5EQ
07539820768