

EXISTING WINDOWS (3no.)  
Metal Casement.

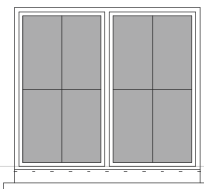

PROPOSED WINDOWS (2no.)  
(timber casement with glazing proportions similar to existing openings elsewhere in the building).

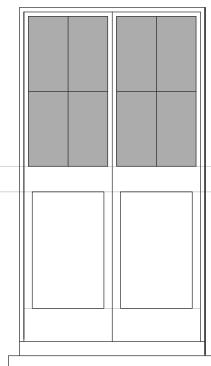

PROPOSED DOOR (1no.)  
ALTERNATIVE 1  
Proposed doors to garden - glazed / solid split to reflect dimensions / levels of existing window opening.

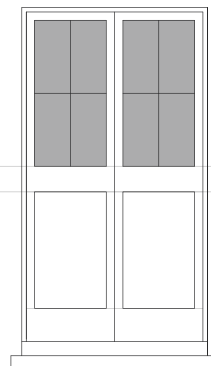

PROPOSED DOOR (1no.)  
ALTERNATIVE 2  
As alternative 1 + stile width increase appropriate for a door frame.

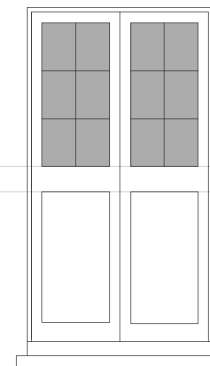

PROPOSED DOOR (1no.)  
ALTERNATIVE 3  
As alternative 1 + stile width increased further, base rail reduced in height to balance the width of the stiles / rails. Glazing unbalanced in context of elevation.

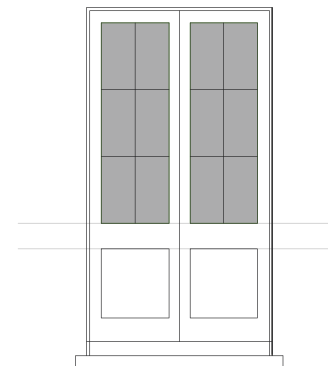

PROPOSED DOOR (1no.)  
ALTERNATIVE 4  
Middle rail lowered to increase glazing and reduce the solid area, to reflect a more appropriate design for the era of the building. Base rail slightly increased in height. Glazing pane size proportionate to existing context of wider elevation.

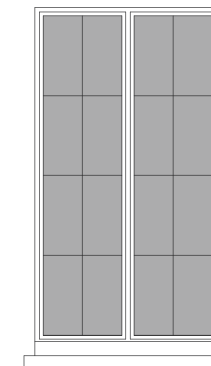

DOOR AS PREVIOUSLY  
PROPOSED  
Refer to historical NMA application drawings.



## SKETCH

Project HEATH HOUSE, HAMPSTEAD, NW3 7ET		
Drawing SKETCH ALTERNATIVES FOR LGF DOOR		
Drawing No. SK110	Scale 1:100 / 1:50 @ A1	Date 02.07.2018

**CLIVE CHAPMAN**  
ARCHITECTS  
SUSTAINABILITY CONSULTANTS  
4 EEL PIE ISLAND  
TWICKENHAM MDDX  
TW1 3DY  
TELEPHONE 020 8891 4837  
EMAIL INFO@CCAR.CO.UK  
WEBSITE WWW.CCAR.CO.UK