

NOTE:  
TENDER DOCUMENTATION IS BASED ON  
PERFORMANCE DUTIES AND REPRESENTS THE AGREED  
SERVICING STRATEGY AND MINIMUM STANDARDS TO BE  
ACHIEVED. WHERE ADDITIONAL DETAILS HAVE BEEN SHOWN  
THIS HAS BEEN PROVIDED IN ORDER TO CONVEY GREATER  
UNDERSTANDING OF THE CONCEPTUAL REQUIREMENTS  
AND SHALL NOT BE TAKEN AS DETAILED DESIGN. ALL DESIGN  
RESPONSIBILITY REMAINS WITH THE CONTRACTOR.  
THE CONTRACTOR WILL BE RESPONSIBLE FOR DESIGN  
OF THE BUILDING ENGINEERING SERVICES IN ACCORDANCE  
WITH A DESIGN AND BUILD CONTRACT. PLANT SIZING IS  
INDICATIVE AND THE CONTRACTOR SHALL BE  
FULLY RESPONSIBLE FOR THE DETAILED DESIGN  
OF ALL PLANT AND EQUIPMENT.

- NOTES
- 1 THIS DRAWING TO BE READ IN CONJUNCTION WITH ARCHITECTURAL AND OTHER RELATED DRAWINGS
  - 2 DO NOT SCALE THIS DRAWING
  - 3 FOR THE PURPOSE OF COORDINATION ALL RELEVANT PARTIES MUST CHECK THIS INFORMATION PRIOR TO IMPLEMENTATION AND REPORT ANY DISCREPANCIES TO THE ENGINEER
  - 4 ALL MEASUREMENTS TO BE VERIFIED ON SITE
  - 5 ALL PLANT AND EQUIPMENT TO BE INSTALLED IN ACCORDANCE WITH MANUFACTURERS RECOMMENDATIONS INCLUDING ADEQUATE SPACE FOR MAINTENANCE AND REPLACEMENT
  - 6 EXTERNAL GRILLE COLOUR TO MATCH WALL COLOUR
  - 7 GRILLES TO BE CO-ORDINATED WITH LIGHTS
  - 8 FAN & ROOM AIR VOLUMES TO BE IN ACCORDANCE WITH TABLE 5.1A AD F

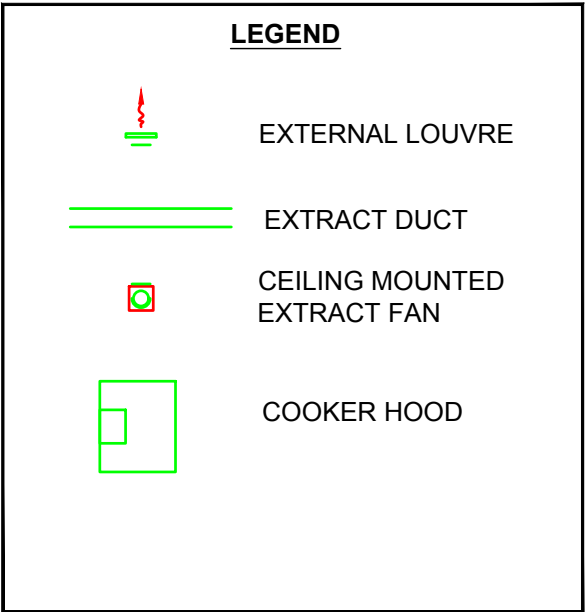
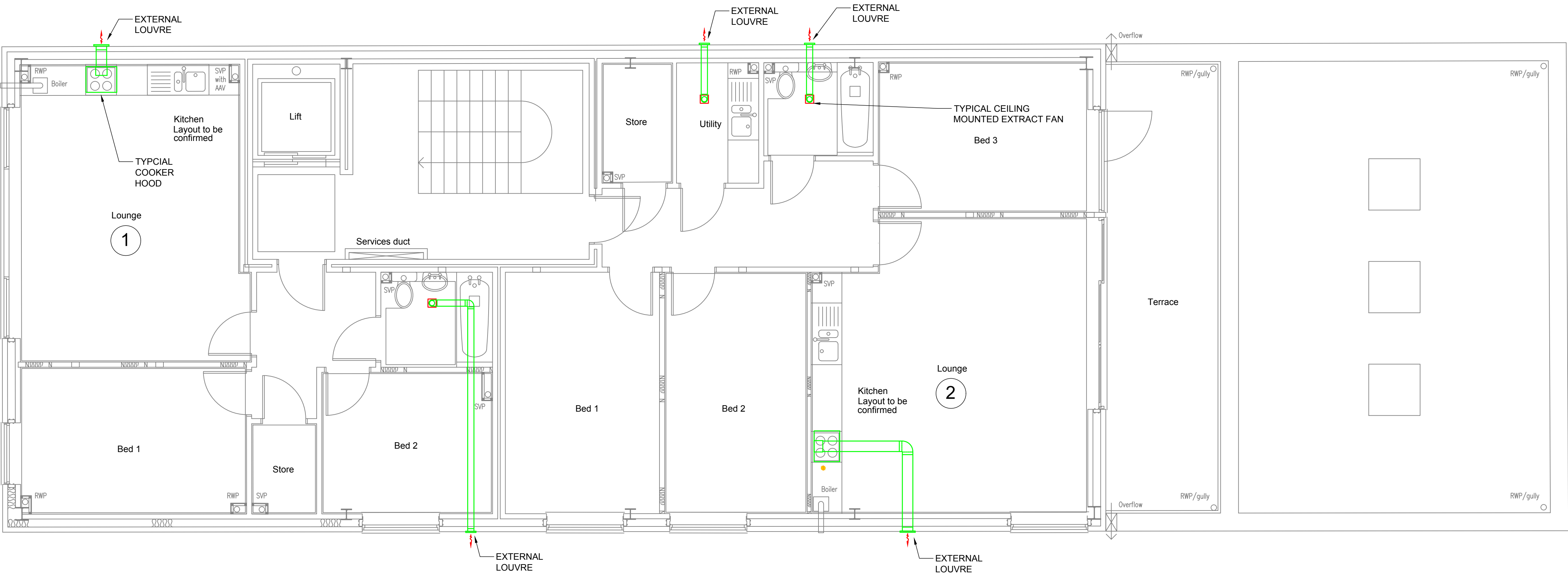

Rev	Date	Drawn	Issue
B	02.05.18	EF	VENT SYSTEMS CHANGED
A	19.04.18	EF	ISSUED FOR INFORMATION

Drawing Status INFORMATION

**centreline**  
Building Services Consultants

Studio C3,East Gores  
Salmons Lane  
Coggeshall  
Essex, CO6 1RZ

Tel. 01376 561133  
E-mail: info@centrel ine.eu.com

**LOW CARBON**  
ENERGY ASSESSORS

Client  
PALMHURST SECURITIES LTD

Project  
ROCHESTER MEWS  
16 ROCHESTER MEWS  
CAMDEN NW1 9JB

Title  
FIRST FLOOR  
VENTILATION

Drg No:	151012/MV/002	Rev	B
Scale	1:50@A1	Date	JAN 16
Drawn	TJH	Checked	PL