

# STEVE HOOPER TREEWORK

DESIGN  
 LANDSCAPING  
 GARDENING  
 TREE SURGERY

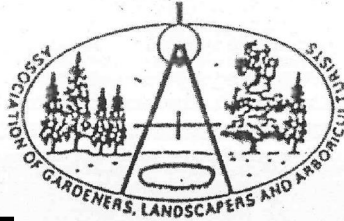

GARDEN AND LANDSCAPE DESIGN

TREE REPORT: DATE 4.6.18

WP

INS/RA

CON

Client: RACHEL MUNRO-PEEBLES

Parking Please reserve two spaces

Address:

Site Address: 5 THE HEXAGON, LONDON, N6 6 HR

PLAN:

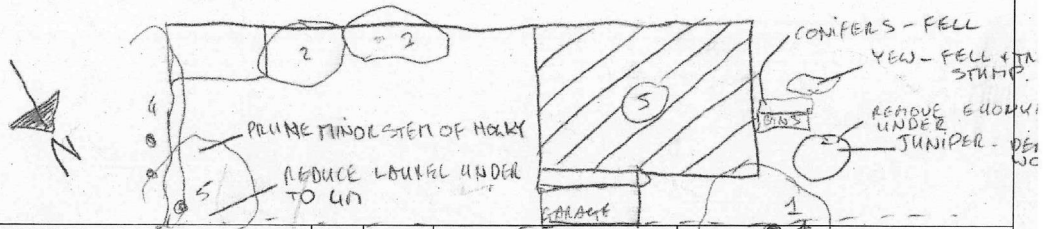

T	SPECIES	HT	DBH	CONDITION	RECOMMENDATION
1	TILIA SP.	20m	70cm	FAIR: 6m from S.	RAISE CROWN TO 6M, S SIDE OF BOUNDARY ONLY, REMOVE SUCKERS
2	PYRAECANTHA (FIREHORN)	4m	MULTI	FAIR:	FELL & TREAT STUMP.
3	SYRINGA (LILAC)	5m	"	FAIR/POOR: FUNGAL INFECTION IN MAIN STEM.	PRUNE OUT MAIN STEM, REDUCE TO 4M
4	LIMES & OTHER VEGETATION	8m	60cm	FAIR:	PRUNE BACK TO BOUNDARY
5	TILIA SP. (LIME)	10m	50cm	FAIR: POLLARD	RE-POLLARD, REMOVE SUCKERS

Signed

S. T. Hooper B. A. (Hons) and A. Elphick B. A. (Hons)

STEVE HOOPER TREEWORK

SHT IS FULLY INSURED PLEASE ASK TO SEE INSURANCE CERTIFICATE. WE ARE CERTIFIED WASTE CARRIERS REG. NO. CBDL118498. WASTE IS RECYCLED BY BYWATERS. WE DO NOT ASK FOR A DEPOSIT UNLESS THE VALUE OF THE WORK EXCEEDS £1,500. PLEASE PAY THE TREE SURGEONS ON COMPLETION. WE RESERVE THE RIGHT TO CHARGE FOR LOSS OF EARNINGS IF THE WORK IS CANCELLED WITH LESS THAN 2 WORKING DAYS NOTICE. WE RETAIN THE COPYRIGHT ON SPECIFICATIONS CONTAINED IN OUR RECOMMENDATION. WE RESERVE THE RIGHT TO PASS ON PARKING COSTS.