

**Notes:**  
 This drawing is protected by copyright. No part of this document may be reproduced, altered, or transmitted in any form or by any means without permission.  
 Do not scale off these drawings for construction purposes. If any discrepancies are found, please contact Proctor Watts Cole Rutter.

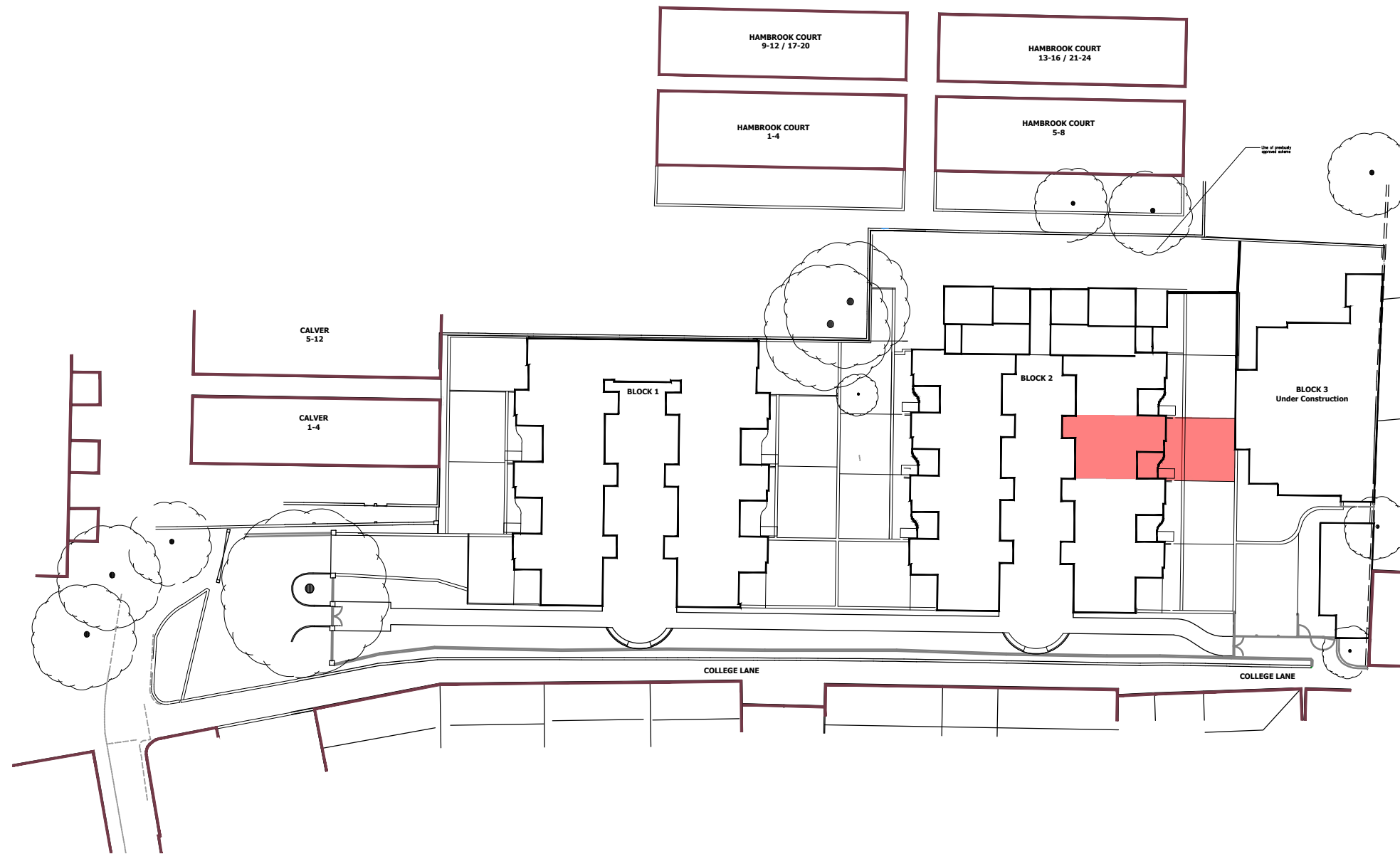

**Site Plan**  
 Scale 1:500

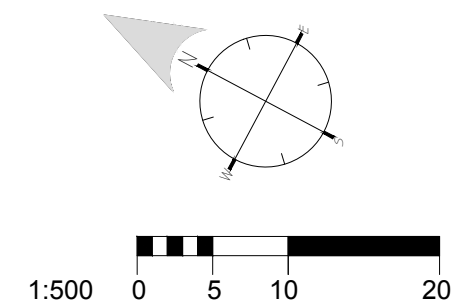

Rev.	Description:	By	Date
-	-	-	-
Client: Mr Edward Dewhirst And Miss Natalie Petrie		Drawn By:	JP
Title: Site Plan		Checked By:	-
Project: 18 Wiblin Mews, College Lane, Kentish Town, London		Scale: 1:500@A3	Date: 21 June 2018
Job No: 4672	Dwg No: S25	Revision:	-

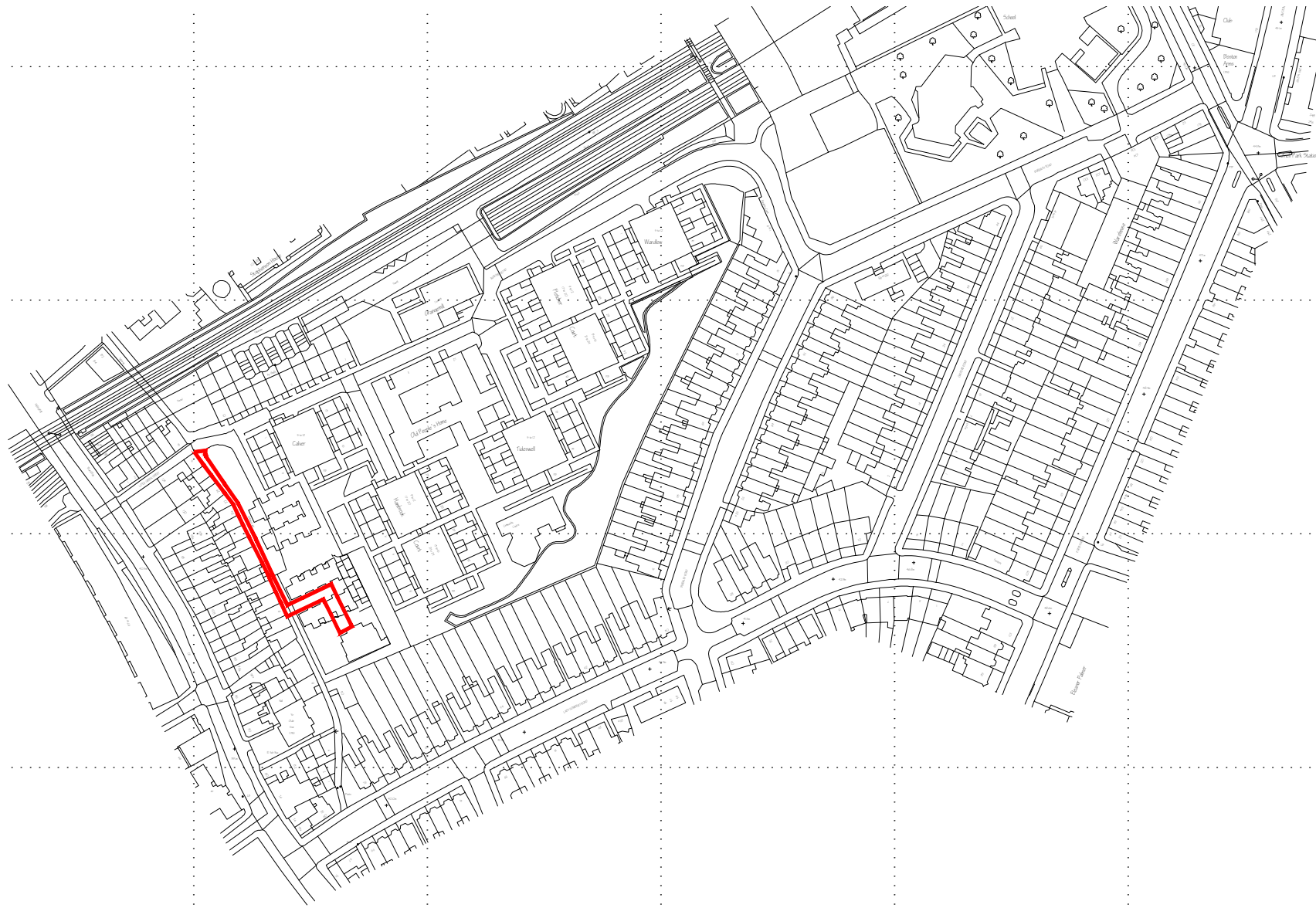

# Location Plan

Scale 1:2500

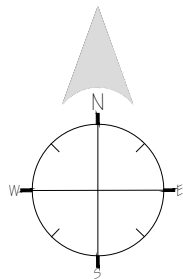

**Proctor Watts Cole Rutter**

Chartered Architects & Town Planners

Grosvenor House, Bleke Street, Shaftesbury, Dorset, SP7 8AW.

Phone: 01747 851881 Fax: 01747 851081

mail@pwcr.co.uk www.pwcr.co.uk

Client: Mr Edward Dewhirst & Miss Natalie Petire

Dwg: 18 Wibun Mews, Kentish Town

Drawn By: JP

Checked By:

Job No:  
4672

Dwg No:  
S26

Notes:

Date: 21 June 2018

Scale: 1:2500@A4