

Longitudinal Sectional Elevation

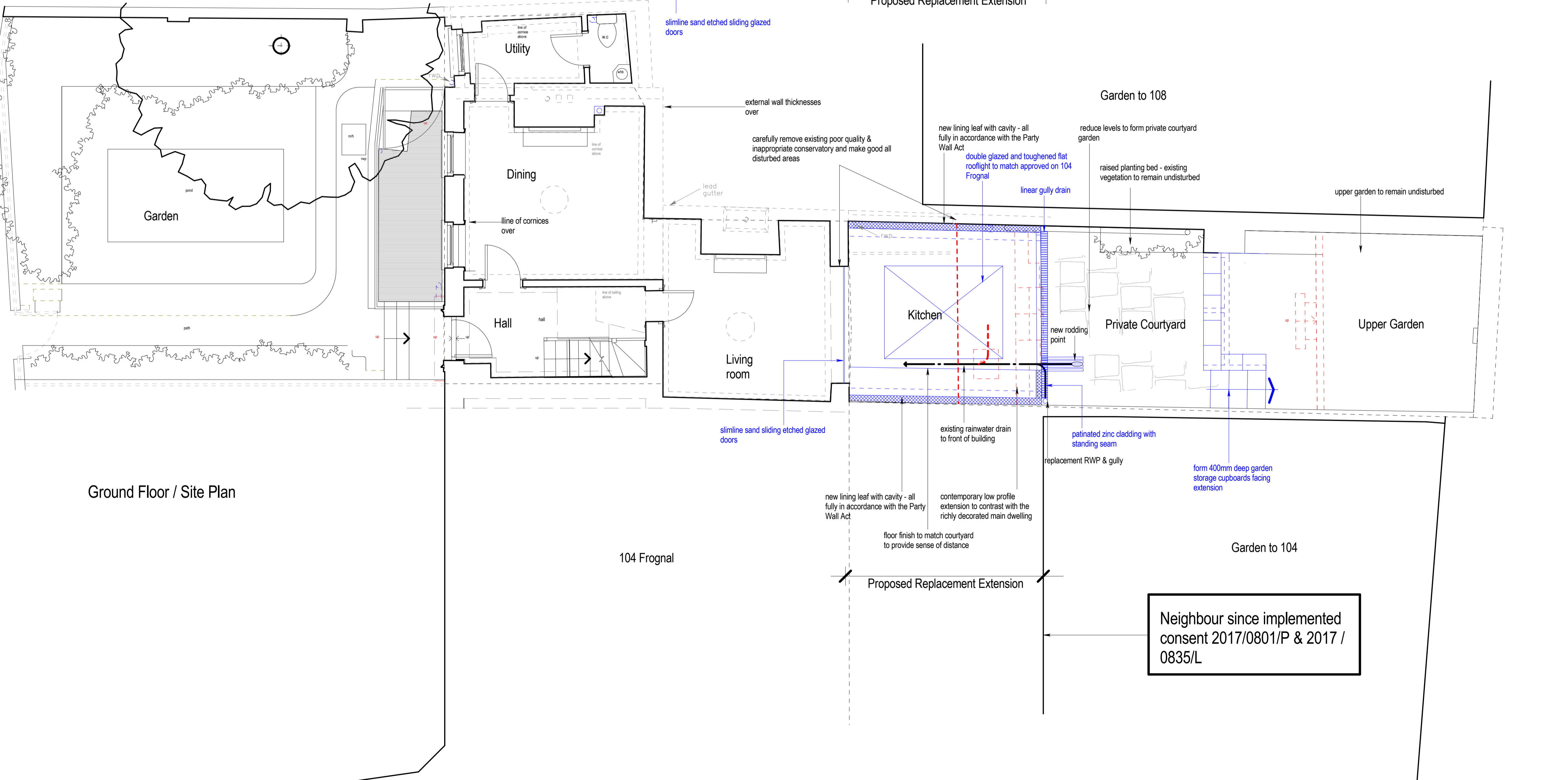
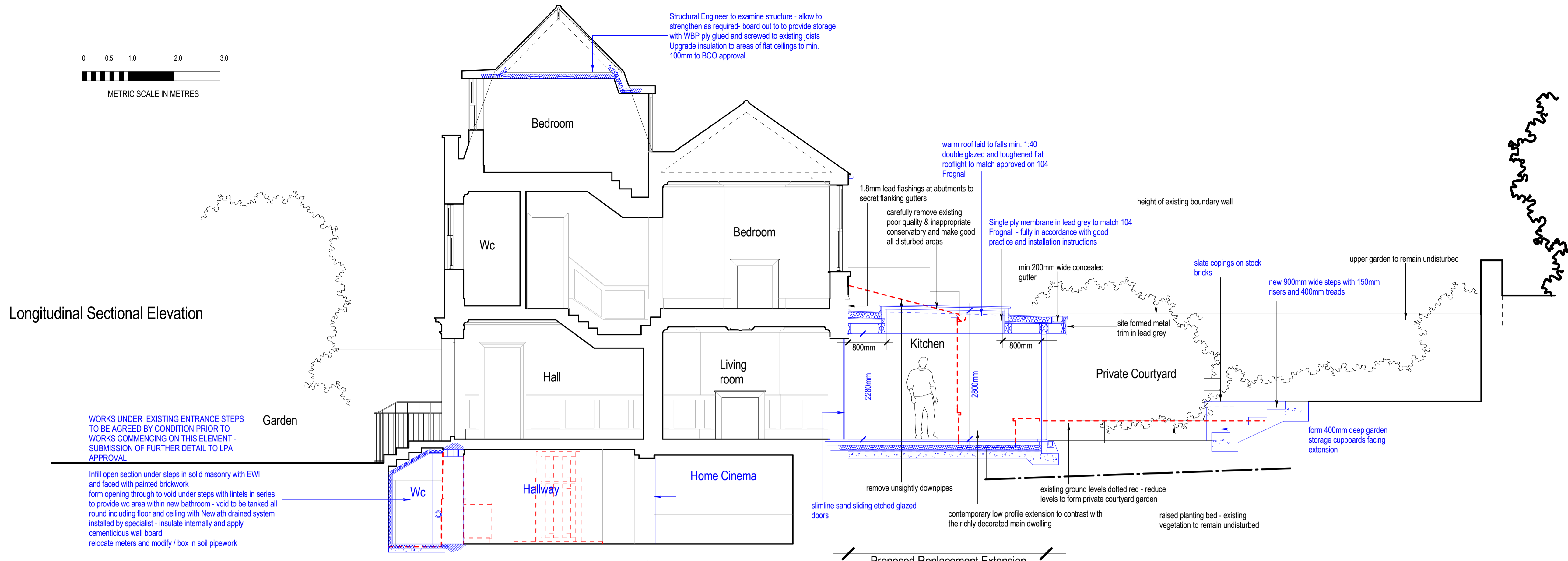

Ground Floor / Site Plan

NOTES

THESE DRAWINGS ARE PROTECTED BY THE COPYRIGHT ACT THE DOCUMENT OR ANY INFORMATION CONTAINED THEREIN MUST NOT BE COPIED, PUBLISHED OR DISCLOSED TO ANY THIRD PARTY WITHOUT THE EXPRESS WRITTEN CONSENT OF ALEX P GATH

ENSURE PROVISION OF A CONSTRUCTION PHASE PLAN - OBSERVE ALL MATTERS OF HEALTH AND SAFETY AND ENSURE ALL SITE WORKERS WEAR HARD HATS AND OTHER PPE. IF IN DOUBT CONTACT THE HEALTH AND SAFETY EXECUTIVE FOR ADVICE.

WHERE ITEMS ARE COVERED BY DRAWINGS OF A DIFFERENT SCALE THE LARGER SCALE DRAWINGS ARE TO BE WORKED TO.

REDUCE CONSTRUCTION WASTE BY USING RECYCLED OR APPROPRIATE RECLAIMED MATERIALS. RETAIN AND REUSE SURPLUS MATERIALS FROM PREVIOUS PROJECTS. SALVAGE ALL NATURAL STONE.

IT IS THE CONTRACTORS RESPONSIBILITY TO VERIFY ALL DIMENSIONS ON SITE AT SETTING OUT STAGE PRIOR TO ANY CONSTRUCTION. CONSIDERABLE CARE SHOULD BE TAKEN AT THIS IMPORTANT STAGE ESPECIALLY ON HISTORIC OR OLDER BUILDINGS WHERE A DEGREE OF TOLERANCE SHOULD BE EXPECTED AND WHERE IN PROXIMITY TO BOUNDARIES OR NEIGHBOURING PROPERTY. ANY DISCREPANCIES TO BE CONFIRMED TO THE DESIGNER.

ALL WORK TO BE UNDERTAKEN IN ACCORDANCE WITH THE ROBUST CONSTRUCTION METHODS LIMITING THERMAL BRIDGING AND VOL 2 - SOUND RESISTANCE AS INDICATED IN DEFRA PUBLICATION ROBUST DETAILS CONTACT TEL: 029 2039 5548 FOR COPIES.

ALL DRAWINGS ARE TO BE READ IN CONJUNCTION WITH ALL DRAWINGS AND DESIGN DETAILS INCLUDING CALCULATIONS PREPARED BY SPECIALIST SUPPLIERS.

CONSIDERABLE CARE SHOULD BE TAKEN BY THE CONTRACTOR TO ENSURE THAT ALL ADEQUATE PROPPING AND TEMPORARY SUPPORT IS PROVIDED IN ORDER TO MAINTAIN THE CONTINUED STABILITY OF THE STRUCTURE AND BUILDING.

LOCATE, IDENTIFY & PROTECT ALL EXISTING LIVE SERVICES PRIOR TO COMMENCING ANY WORKS. THE CONTRACTOR IS TO NOTE AND SUPPLY ALL DETAILS & LOCATIONS OF BURIED OR HIDDEN SERVICES DISCOVERED OR INSTALLED DURING THE WORKS

EXAMINE THE ADEQUACY OF EXISTING WALLS TO TAKE NEW LOADINGS.

- Starting work on these proposals?
- Ensure that planning consent has been obtained
  - Ensure that all conditions on the planning consent have been discharged in writing by the Council - failure to do so could invalidate the permission
  - Ensure that Building Regulation Approval or a Building Notice has been obtained prior to starting.
  - Ensure that any structural design and calculations have been prepared and approved by the Council
  - Ensure the work is inspected regularly by the Council Building Inspector
  - Ensure provision of the Building Regulation completion certificate

PROPOSED AMENDMENTS TO CURRENT CONSENT HIGHLIGHTED IN BLUE

REVISION A June 2018 - Additional info prior to submission  
[www.apg-design.co.uk](http://www.apg-design.co.uk)

alex p gath Limited

collaborative planning and design



wayside west charleton kingsbridge TQ7 2AJ T 01548 531767 E info@apg-design.co.uk

sensitively influencing development in south devon

project	106 FROGNAL HAMPSSTEAD LISTED BUILDING CONCEPT PROPOSALS - PLAN & SECTION		
client	MR & MRS C NICHOLLS		
date	JANUARY 2018		
scale	1:50 (A1)		
drawing number	A1176 14	P23	A

PLANNING PROPOSALS