

+28.33m
Existing Second Floor F.F.L

3.340

+24.99m
Existing First Floor F.F.L

3.340

+21.65m
Existing Ground F.F.L

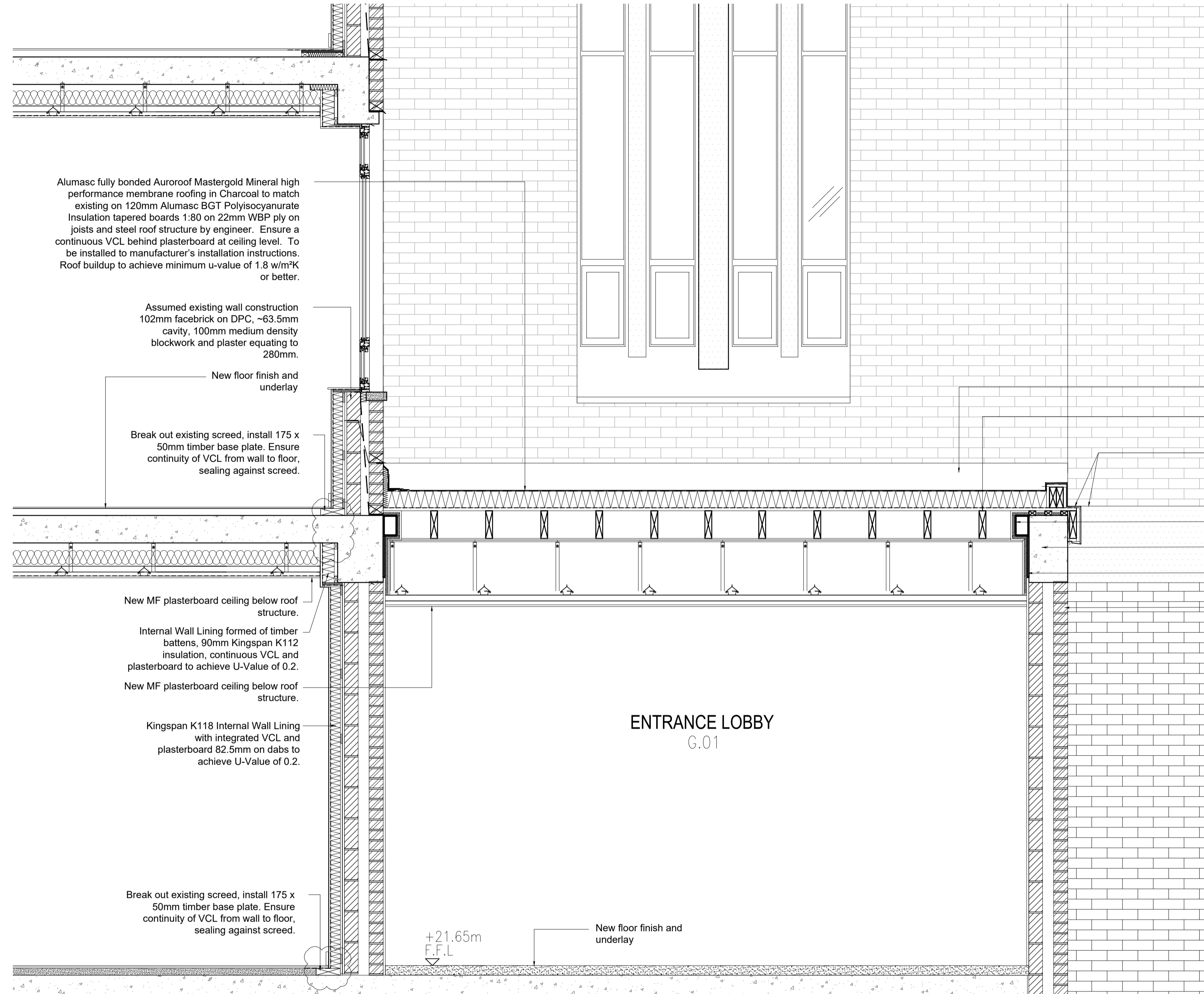

- ALUMASC flashing detail installed to manufacturer's installation instructions.
- Canopy structure to structural engineer's details.
- PPC aluminium cover flashing by Alumasc or similar. To align with top of existing RC edge beam.
- Steel beam and fixing plate to structural engineer's details to be insulated as indicated on drawings.
- Existing concrete beam retained. Projecting nib cut back to take new steels.
- New steel plate painted to match RC beam.
- Assumed existing wall construction to be retained

01 Proposed Detail Section-10
SC-306 1:20

DO NOT SCALE THIS DRAWING. ALL DIMENSIONS MUST BE CHECKED ON SITE. INFORM THE ARCHITECT OF ANY DISCREPANCIES PRIOR TO CONSTRUCTION.

KEY PLAN

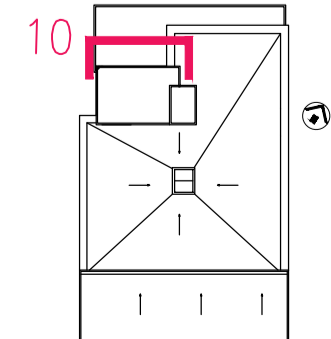

NOTES

ALL DIMENSIONS TO BE CHECKED AND CONFIRMED ON SITE. ANY DISCREPANCIES TO BE REFERRED TO THE ARCHITECT FOR COMMENT BEFORE INSTALLATION.
REFER TO THE GA PLANS, GA SECTIONS FOR FULL LAYOUTS.
PLEASE ALSO REFER TO THE ELEVATION DRAWINGS, EXTERNAL WINDOW AND DOOR SCHEDULES AND DETAIL DRAWINGS AS REFERENCED ON THE SECTIONS.
FOUNDATIONS, NEW STRUCTURE, BLOCKWORK, TIES, LINTELS AND WINDOWPOSTS TO BE DESIGN.

PLEASE ALSO REFER TO THE FOLLOWING DRAWINGS FOR THE ENTRANCE CANOPY DETAILS:

- 0001-SC-300
- 0001-SC-301
- 0001-SC-307
- 0001-02-107

P01 06.03.18 ISSUED FOR COMMENT - SUBJECT TO PLANNING APPROVAL
P02 23.04.18 COLD BRIDGE DETAILS UPDATED

JC BG
JC BG

DRAWING TITLE
DETAIL SECTION 10

SCALE 1:200A1

A1 SHEET

STATUS
PRELIMINARY

DRAWING NO
0001-SC-306

REV
P02

**connected
architecture**

CLIENT
Sisters Faithful Companions of Jesus
PROJECT
St. Aloysius Convent Refurbishment