



STARBUCKS
COFFEE COMPANY
 11 Bathurst Road, Petersham Green
 London NW4 4LJ
 Tel: 020 8724 4900

ALL DRAWINGS TO BE
 READ IN CONJUNCTION
 WITH UK STANDARD
 DETAIL MANUAL

REV DATE DESCRIPTION
 A 06/04/07 Building revised

FOR PLANNING

24/09/07

SITE ADDRESS:
102-116 New Oxford St
LONDON
WC1A 1HH
 COUNTRY:
ENGLAND

PROJECT No.:
 CONSULTANT:
 P.T.L. No.:
 P.T.L. CHECK:
 STORE PLANNER: A. COOK

SCALE: 1:50 @ A1
 (DO NOT SCALE DRAWINGS)

DRAWING TITLE:
**OUTDOOR SEATING
 PLAN**

DRAWING NUMBER: **A2.1**
 REVISION: **A**
 PROJECT CODE: 9/04/4

FOR PLANNING

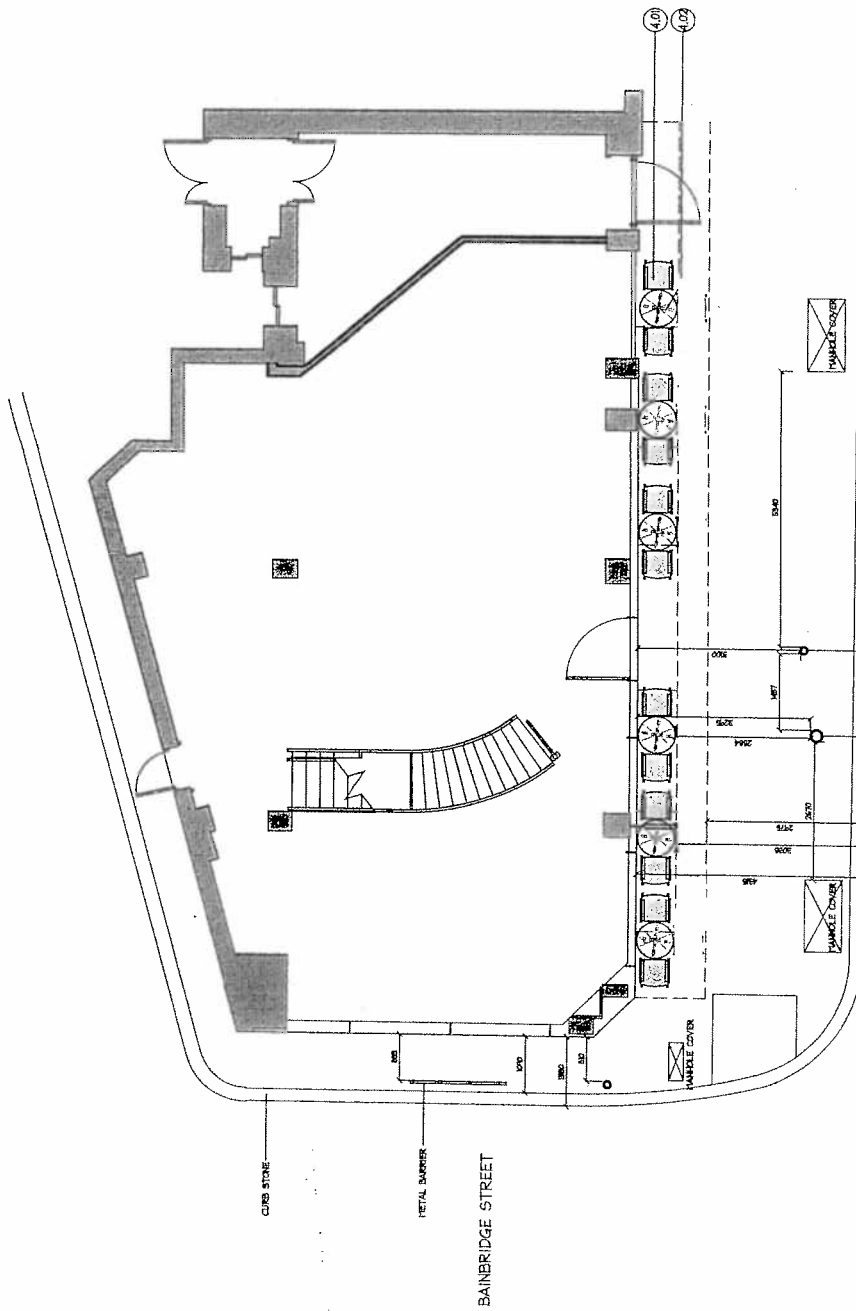

NEW OXFORD STREET

BAINBRIDGE STREET

CURB STONE

METAL BARRIER

LAMP POST TRAFFIC LIGHT

MANHOLE COVER

MANHOLE COVER



PROPOSED OUTDOOR SEATING PLAN
 SCALE 1:50

DRAWING ORIGINATED FROM:
 THIS DRAWING HAS BEEN CONSTRUCTED FROM A FULL SITE SURVEY CONDUCTED BY RPA.
 THIS DRAWING HAS BEEN CONSTRUCTED FROM DRAWINGS PRODUCED BY BLUR '1

STANDARD DETAIL REFERENCES:
 ALL REFERENCES TO STANDARD DETAIL REFERENCES ARE
 REFERENCED TO STANDARD DETAIL MANUAL NOVEMBER 2004
 EDITION.