





CONSTRUCTION KEY

-  existing retained
-  line over/under/behind
-  demolished
-  new construction

GROSS INTERNAL FLOOR AREAS:

- Overall: 177.2 m²
- Communal Circulation: 6.5 m²
- Lower Maisonette: 73 m²
- Upper Maisonette: 96.5 m²

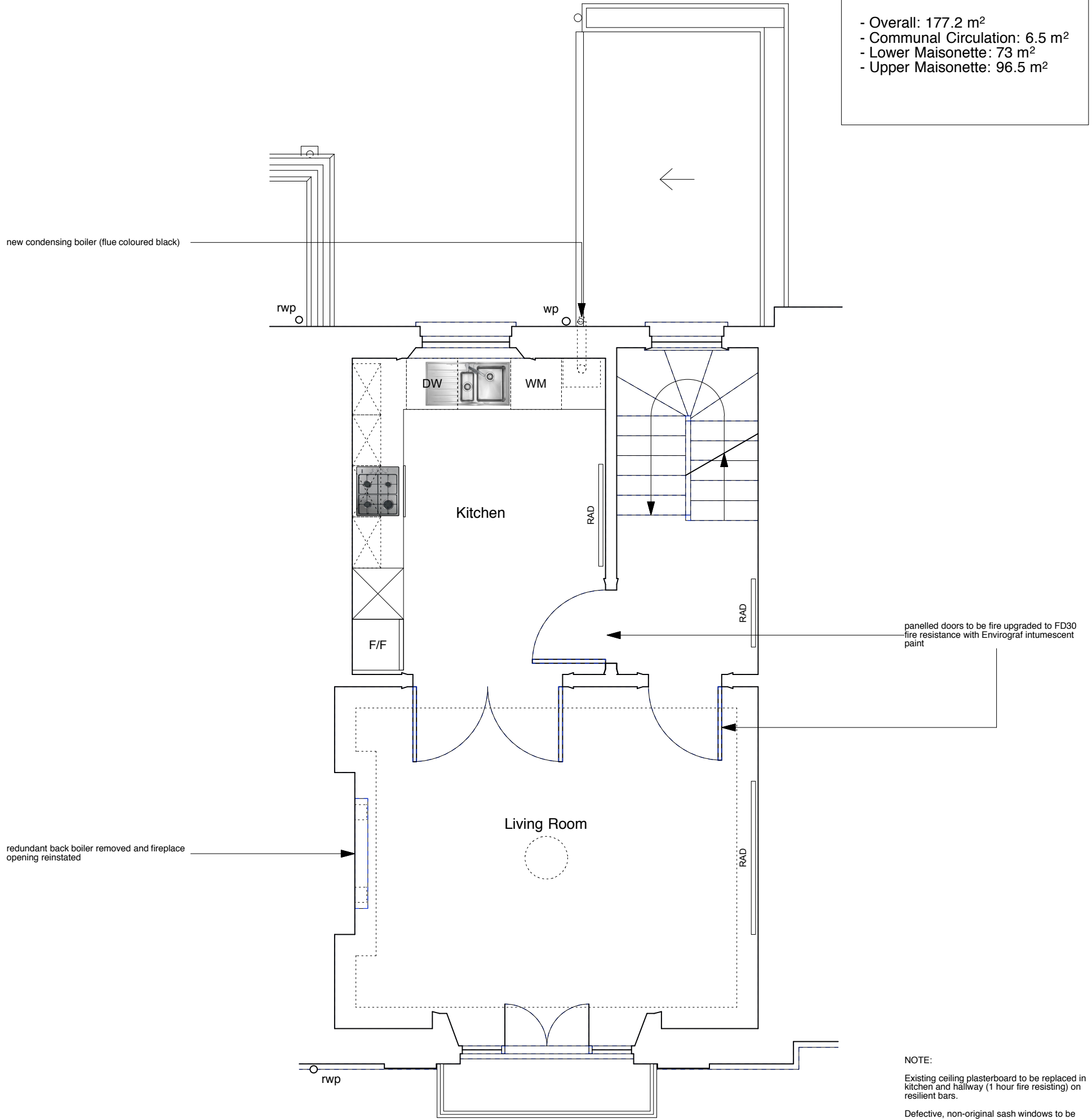

NOTE:

Existing ceiling plasterboard to be replaced in kitchen and hallway (1 hour fire resisting) on resilient bars.

Defective, non-original sash windows to be replaced like-for-like but without horns and using stretched ovolo mouldings/glazing bars & hardwood cills.