

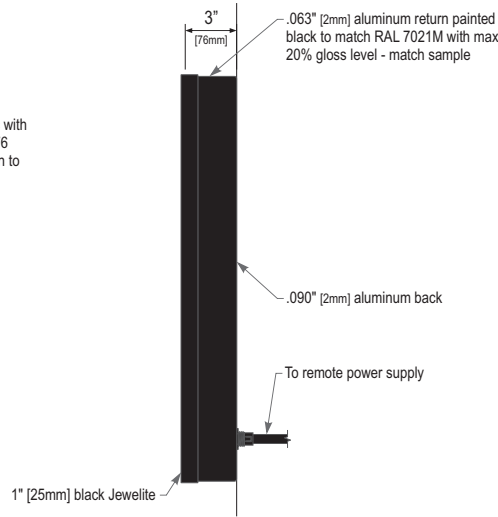

**Front Elevation View**

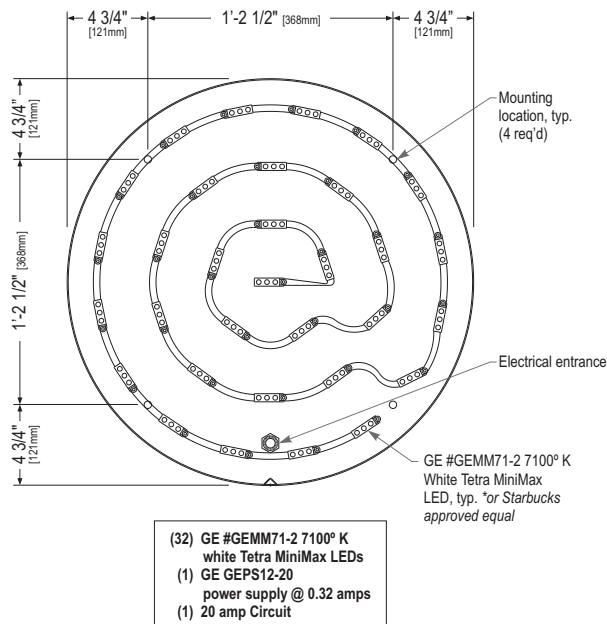

**Right Side View**



**Illumination View & Mounting Locations**

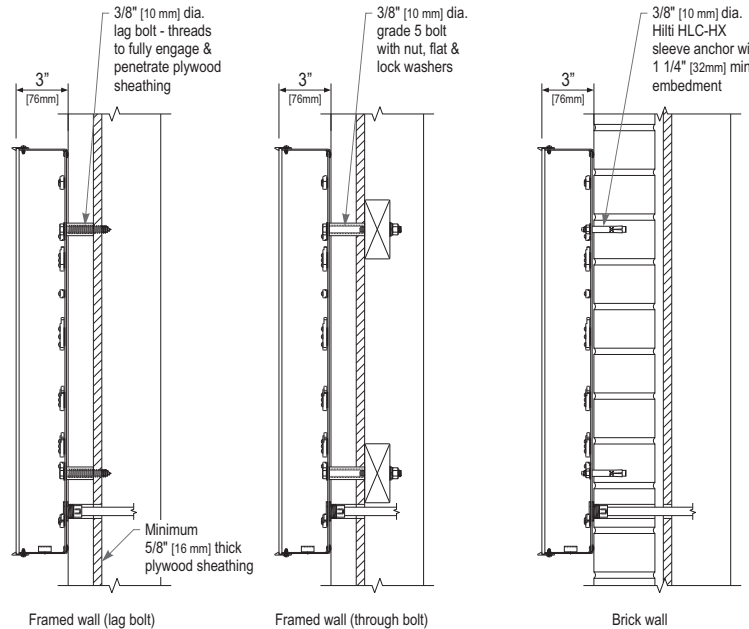

**Section View at Installation Detail**

**Sign Specifications:**

**Cabinet:**

- .063" [2mm] aluminum returns painted black to match RAL 7021M.
- Areas using black paint to match RAL 7021M shall have a max 20% gloss level, match sample.
- 1" [25mm] Black Jewelite trim.
- Back to be .090" [2mm] aluminum.
- 3/16" [3mm] #7328 white acrylic face with first surface applied 3M 3630-76 Holly Green vinyl. White siren to be weeded out of green vinyl.
- Interior aluminum surfaces of sign cabinet to be painted white with Lacryl Starbrite.
- All exposed fasteners painted black to match RAL 7021M.
- All fasteners used in the assembly of internal components shall be coated to prevent corrosion.
- Internal structure of cabinet shall be per approved shop drawings.
- Graphic elements are internally illuminated using GE Tetra MiniMax LED system or Starbucks approved equal.

**Regulatory:**

- Sign must meet all regulations in the National Electric Code as well as any local or state electrical codes.
- As per NEC 600.6, sign is equipped with a service disconnect switch.
- Sign must be listed as an Electric Sign per Underwriters Laboratories UL48 and/or CSA and bear the appropriate UL, CUL or CSA relevant certification marks.
- Primary power by electrical contractor per NEC.



These Drawings and Specifications are confidential and shall remain the sole property of Starbucks Corporation, which is the owner of the copyright in this work. They shall not be reproduced (in whole or in part), shared with third parties or used in any manner on other projects or extensions to this project without the prior written consent of Starbucks Corporation.

This drawing is a Design Development Document. Site specific modifications made under the responsible charge of the Architect and/or Engineer-of-Record will be required prior to using this document for Bidding, Permitting, or Construction.

Size	Sq. Ft. <sup>1</sup>	Sq. Ft. <sup>2</sup>	Volts	Amps
24" (610mm)	3.96	4.0	120	0.32

1: Figured as illuminated center part  
2: Figured as complete signage



Design ID #13161-HW

**Siren Logo Illuminated Wall Mount - 24in 610mm - High Wind Load Design**

Starbucks does not manufacture the item(s) drawn or specified. Incorporation of design item is to be coordinated with item supplier and Architect and/or Engineer-of-Record. Manufacturer's name and contact information clearly visible on finished item. All items manufactured to final engineering specifications, provided by Architect of Record.

# ID# 13161

**NOTE:** The Hyperion R-Lite™ strip is sold in 12.5ft & 25ft strips.  
 direct illumination/face lit/ single face wall mount  
 self - contained power supply  
 remote power supply

24" TALL FABRICATED ALUMINUM CHANNEL LETTER  
 STARBRITE ER 2MILS WHITE PAINT OR AMERIMAX MAXXBRITE  
 PREPAINTED ALUMINUM COIL RECOMENDED

HYPERION R-LITE SYSTEM CC WHITE  
 APPLIED ON PAINTED ALUMINUM  
 INSTALLATION TEMPERATURE RANGE 50° – 95° F (10° – 35° C)

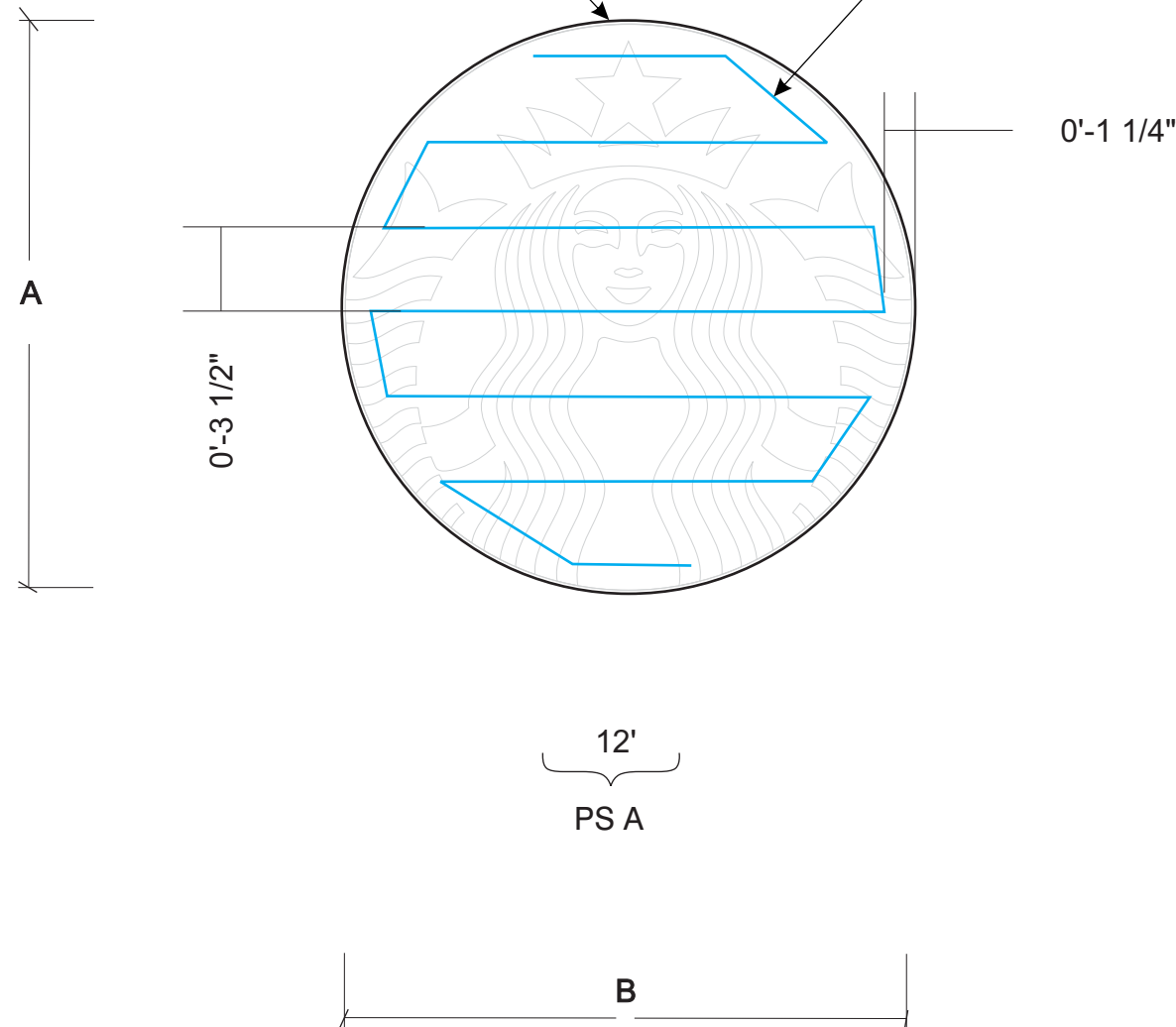

**NOTE:** INDIVIDUAL FOOTAGE ARE ESTIMATES. ACTUAL LENGTHS MAY VARY.  
 DO NOT PRECUT STRIPS. ALWAYS WORK FROM the R-Lite REEL to avoid shortages  
 and unnecessary use of jumpers.

**IMPORTANT! Required for ALL FIELD RETROFITS:**

- 1.) Thoroughly Clean surface area with non-oil based solvent (409, alcohol or heptan).
- 2.) To ensure adhesion of LED strip to channel letter / cabinet place a support clamp across the LED strip every 4 inches. It is required that you utilize support clamps and / or use silicone adhesive across the LED strip every 4 inches. See page 1 of installation manual for detailed retrofit instructions.

**INSTALLATION NOTE:** PLEASE READ INSTALL MANUAL BEFORE INSTALLATION.  
 IF YOU HAVE ANY QUESTIONS, PLEASE CONTACT YOUR SALES REPRESENTATIVE OR  
 OUR CUSTOMER SUPPORT TEAM. 877-383-4032

**NOTE:** It is recommended to test one or more letters before installation  
 for acceptable color and illumination.

**IMPORTANT:** When sending files for quotes all files must be in vector file format.  
 Raster images, photos or bitmaps are not recommended due to low resolution and  
 non-scalability which can have an affect on product selection, quantities, application  
 and illumination. Prices and quantities are estimates which are subject to change  
 based on raster images,photos or bitmap files.



Layouts/quotes/estimates are based upon Lumificient standards for typical usage. We utilize information that is provided to us, apply our standards, and provide you with layouts/quotes/estimates for the materials typically required to complete the project. Guidelines do not take into account individual preferences or end customer preferences. FINAL MATERIAL REQUIREMENTS ARE THE RESPONSIBILITY OF THE SIGN MANUFACTURER.

General Info		
	Unit of Measure feet/inches	Unit of Measure meter/millimeter
LETTER HEIGHT (A):	24"	610mm
SIGN LENGTH (B):	24"	610mm
LETTER DEPTH:	3" - 6"	76mm-152mm
MAX LETTER STROKE:	0.00"	0.0mm
MIN LETTER STROKE:	0.00"	0.00mm
Power Requirements		
INPUT VOLTS:		120V
INPUT AMPERES:		0.2 max
TOTAL WATTAGE:		12 Watts
HRL-W-24-Starbucks logo disk 13161 wall.cdr		
File	Quote# 40407	
No.	Revision / Issue	Date

Material List		
	Unit of Measure feet	Unit of Measure meter
TOTAL LINEAR FOOTAGE:	12 ft	3.66m
HRLSB-6500 White	12 ft	3.66m
HRLSB-HC Power Connector:	1	
HRLSB-JC JUMPER:		
HRLSB-24 Power Unit:		
HRLSB-24EU: Power Unit:	1	
HRLSB-96 Power Unit:		
HRLSB-277 Power Unit:		

Added Material List for Retrofits		
HRLSB-SC		36

Customer Name and Address  
 Starbucks Coffee Company  
 2401 Utah Avenue South 8th floor  
 Seattle, WA 98134

Customer Contact  
 Katie O'Donnell

Project	24" Starbucks Coffee Logo Disk SF	
TAG	13161 - 24" (610 mm)	
Location / Store#	XX	
Date	03/25/2011	1 / 2 Sheet
Scale	1:8	

**LUMificient™**  
 A Nexxus Lighting Company

**Lumificient**  
 8752 Monticello Lane N.  
 Maple Grove, MN 55369  
 Phone: (763) 424 3702  
 Fax: (763) 390 3135

Designed By: LeeAnn

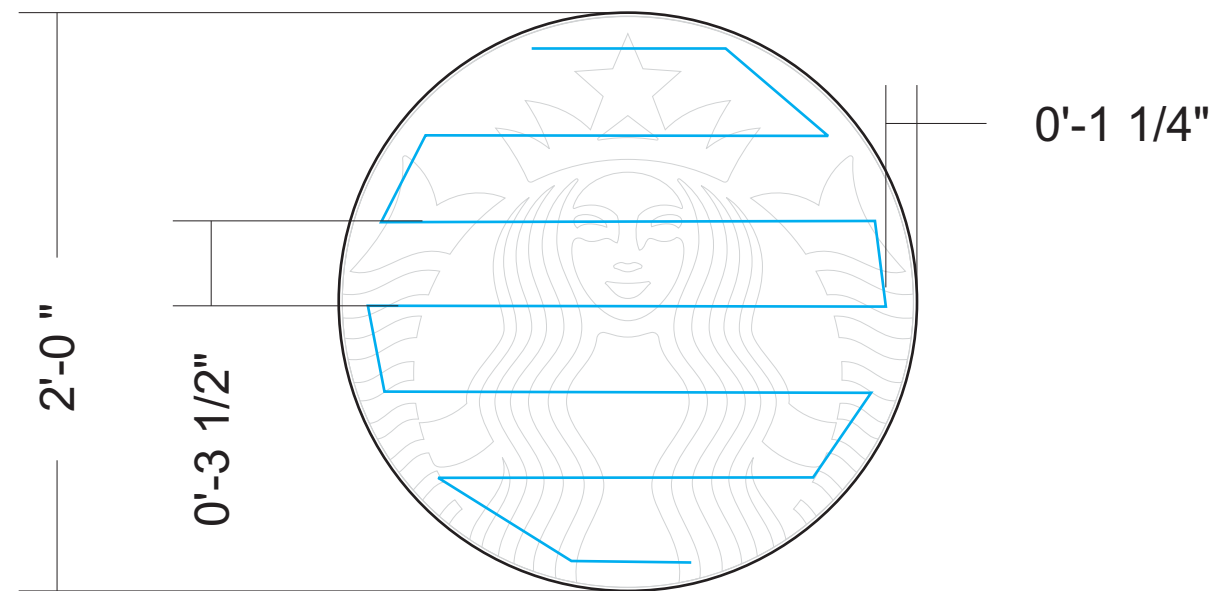

Project	24" Starbucks Coffee Logo Disk SF	
TAG	13161 - 24" (610 mm)	
Location / Store#	XX	
Date	03/25/2011	2 / 2 Sheet
Scale	1:8	

**LUMificient™**  
A Nexus Lighting Company

**Lumificient**  
8752 Monticello Lane N.  
Maple Grove, MN 55369  
Phone: (763) 424 3702  
Fax: (763) 390 3135

Designed By: LeeAnn