

STEVE HOOPER TREEWORK

DESIGN

LANDSCAPING

GARDENING

TREE SURGERY

www.stevehooperlandscapes.co.uk

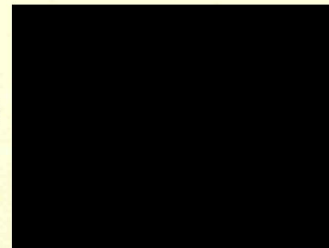
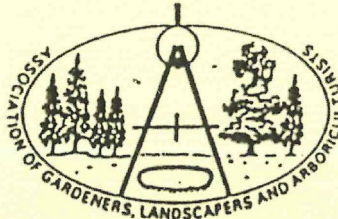

GARDEN AND LANDSCAPE DESIGN

TREE REPORT: DATE 7.6.18

WP

INS/RA BUILDINGS ON SITE

CON

Parking Please reserve two spaces

Client: ANIELA SHUCKBURGH

CP2

Address:

Site Address: 9 DARTMOUTH PARK AVE., LONDON, NWS 1JL

PLAN:

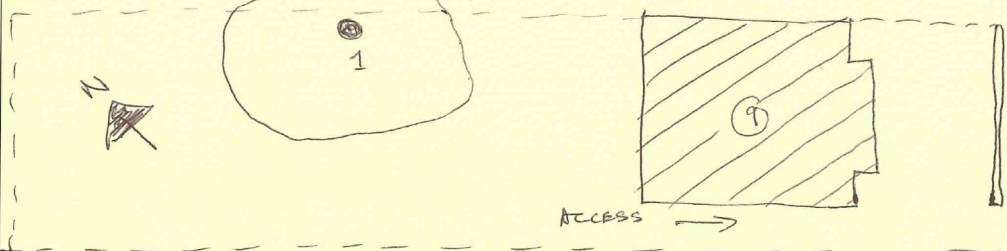

T	SPECIES	HT	DBH	CONDITION	RECOMMENDATION
1	MALUS SP. (APPLE)	10m	60cm 20cm x 2 15cm	FAIR: MATURE	CROWN REDUCE BY 30%, DEADWOOD.

S. T. Hooper B. A. (Hons) and A. Elphick B. A. (Hons)

STEVE HOOPER TREEWORK

SHT IS FULLY INSURED. PLEASE ASK TO SEE INSURANCE CERTIFICATE. WE ARE CERTIFIED WASTE CARRIERS REG. NO. CBDL118498. WASTE IS RECYCLED BY BYWATERS. WE DO NOT ASK FOR A DEPOSIT UNLESS THE VALUE OF THE WORK EXCEEDS £1,500. PLEASE PAY THE TREE SURGEONS ON COMPLETION. WE RESERVE THE RIGHT TO CHARGE FOR LOSS OF EARNINGS IF THE WORK IS CANCELLED WITH LESS THAN 2 WORKING DAYS NOTICE. WE RETAIN THE COPYRIGHT ON SPECIFICATIONS CONTAINED IN OUR RECOMMENDATION. WE RESERVE THE RIGHT TO PASS ON PARKING COSTS.