

MY HOME MOVE LIMITED  
DX724762  
ENDERBY 2

DX

Date  
12 August 2013

Your ref  
DGKW(PC)-217298.00001

Our ref  
RCS/NGL934516

## Completion of registration

Title number	<b>NGL934516</b>
Property	<b>Flat 6, 26-30 Cubitt Street, London (WC1X 0LR)</b>
Registered proprietor	<b>Peter Brian O'connell</b>

Your application lodged on 23 May 2013 has been completed. An official copy of the register is enclosed together with an official copy of the title plan.

The Lease and copy dated 7 May 2013 is enclosed.

You do not need to reply unless you think a mistake has been made. If there is a problem or you require this correspondence in an alternative format, please let us know.

The Title information document is enclosed for you to keep or issue to your client as appropriate.

### Important information about the address for service

If we need to write to an owner, chargee or other party who has an interest noted on the register, we will write to them at the address shown on the register. We will also use this address if we need to issue any formal notice to an owner or other party as a result of an application being made. Notices are often sent as a measure to safeguard against fraud. It is important that this address is correct and up to date. If it is not you may not receive our letter or notice and could suffer a loss as a result.

You can have up to three addresses for service noted on the register. At least one of these must be a postal address, whether or not in the United Kingdom; the other two may be a DX address, a UK or overseas postal address or an email address.

Please let us know at once of any changes to an address for service.

Land Registry  
Leicester Office  
Westbridge Place  
Leicester LE3 5DR

DX 11900 Leicester 5

Tel 0300 006 0003  
Fax 0300 006 0023  
leicester.office  
@landregistry.gsi.gov.uk

[www.landregistry.gov.uk](http://www.landregistry.gov.uk)

Public Guide 2 – *Keeping your address for service up to date* explains how to do this. You can view or download copies of this guide from our website at [www.landregistry.gov.uk](http://www.landregistry.gov.uk) in English and Welsh or obtain a copy of it free of charge from any Customer Support – telephone 0844 892 1111 (0844 892 1122 for a Welsh-speaking service) from Monday to Friday between 8am and 6pm.

---

---

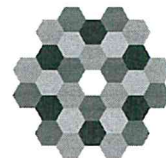

## Title information document

This document has been issued following a change to the register. It has been supplied for information only. It should not be sent to Land Registry in connection with any subsequent application.

Attached is an official copy of the register and of the title plan showing the entries subsisting following the recent completion of the application to change the register.

Please note: The attached official copy shows the state of the individual register of title as at the date and time stated on it.

If in future you wish to apply for an official copy of the register or the title plan, please apply using form OC1 (available from our website, any Land Registry local office and law stationers). A fee is payable for each copy issued.

If you have any queries, or you require this correspondence in an alternative format, please contact us at the address shown, quoting the title number shown on the top of the official copy.

Land Registry  
Leicester Office  
Westbridge Place  
Leicester LE3 5DR  
  
DX 11900 Leicester 5  
  
Tel 0300 006 0003  
Fax 0300 006 0023  
leicester.office  
@landregistry.gsi.gov.uk  
  
[www.landregistry.gov.uk](http://www.landregistry.gov.uk)

### **Important information about the address for service**

If we need to write to an owner, chargee or other party who has an interest noted on the register, we will write to them at the address shown on the register. We will also use this address if we need to issue any formal notice to an owner or other party as a result of an application being made. Notices are often sent as a measure to safeguard against fraud. It is important that this address is correct and up to date. If it is not you may not receive our letter or notice and could suffer a loss as a result.

You can have up to three addresses for service noted on the register. At least one of these must be a postal address, whether or not in the United Kingdom; the other two may be a DX address, a UK or overseas postal address or an email address.

Please let us know at once of any changes to an address for

service.

Public Guide 2 – *Keeping your address for service up to date* explains how to do this. You can view or download copies of this guide from our website at [www.landregistry.gov.uk](http://www.landregistry.gov.uk) in English and Welsh or obtain a copy of it free of charge from any Customer Support – telephone 0844 892 1111 (0844 892 1122 for a Welsh-speaking service) from Monday to Friday between 8am and 6pm.

---

---



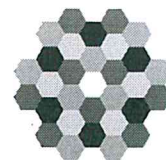

## Official copy of register of title

Title number NGL934516

Edition date 23.05.2013

- This official copy shows the entries in the register of title on 12 August 2013 at 09:17:35.
- This date must be quoted as the "search from date" in any official search application based on this copy.
- The date at the beginning of an entry is the date on which the entry was made in the register.
- Issued on 12 August 2013.
- Under s.67 of the Land Registration Act 2002, this copy is admissible in evidence to the same extent as the original.
- For information about the register of title see Land Registry website [www.landregistry.gov.uk](http://www.landregistry.gov.uk) or Land Registry Public Guide 1 - *A guide to the information we keep and how you can obtain it*.
- This title is dealt with by Land Registry Croydon Office.

### A: Property register

This register describes the land and estate comprised in the title.

#### CAMDEN

- 1 (23.05.2013) The Leasehold land shown edged with red on the plan of the above title filed at the Registry and being Flat 6, 26-30 Cubitt Street, London (WC1X 0LR).

NOTE: Only the lower ground floor is included in the title.

- 2 (23.05.2013) Short particulars of the lease(s) (or under-lease(s)) under which the land is held:  
Date : 7 May 2013  
Term : 125 years from and including 25 December 2006  
Parties : (1) Centenary Homes Limited  
(2) Peter Brian O'Connell  
(3) Jon Howard Gershinson and Victoria Clare Margaret Liddell
- 3 (23.05.2013) The title includes any legal easements referred to in clause LR11.1 of the registered lease but is subject to any rights that are granted or reserved by the lease and affect the registered land.
- 4 (23.05.2013) The landlord's title is registered.

## B: Proprietorship register

This register specifies the class of title and identifies the owner. It contains any entries that affect the right of disposal.

### Title absolute

- 1 (23.05.2013) PROPRIETOR: PETER BRIAN O'CONNELL of Flat 6, 26-30 Cubitt Street, London WC1X 0LR.
  - 2 (23.05.2013) The price, other than rents, stated to have been paid on the grant of the lease was £495,000.
- 

## C: Charges register

This register contains any charges and other matters that affect the land.

---

- 1 (23.05.2013) The land is subject to the following rights reserved by a Transfer of the land freehold estate in the in this title and other land dated 17 March 2004 made between (1) The Mayor and Burgesses of the London Borough of Camden (Transferor) and (2) Goldcrest Homes (Portmore) Limited (Transferee):-

### "Exceptions and Reservations

There is an exception and reservation to the Transferor of all rights or easements or light and air which would restrict or in any way interfere with the free use of any Adjoining Property for building or any other purpose

There is an exception and reservation to the Transferor and its successors in title to the Adjoining Property of rights of support from the Property and to all easements and quasi-easements over the property as the same are at present enjoyed"

NOTE: "Adjoining Property" means any adjacent or neighbouring land of the Transferor.

## End of register



# Land Registry

## Official copy of title plan

Title number **NGL934516**  
Ordnance Survey map reference **TQ3082NE**  
Scale **1:1250**  
Administrative area **Camden**

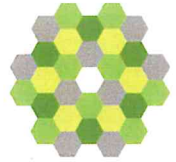

© Crown copyright and database rights 2013 Ordnance Survey 100026316.  
You are not permitted to copy, sub-license, distribute or sell any of this data to third parties in any form.

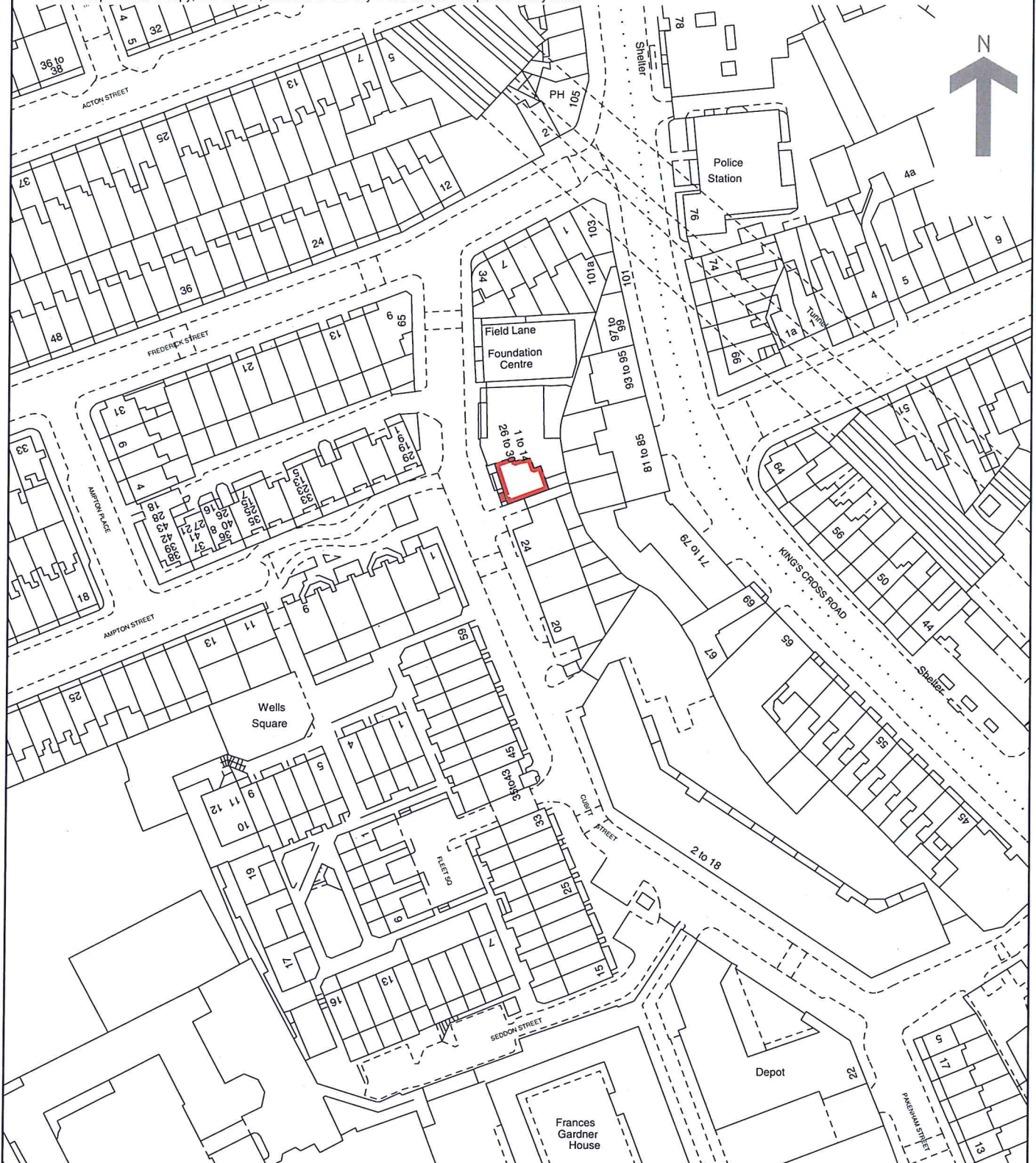

**This official copy issued on 12 August 2013 shows the state of this title plan on 12 August 2013 at 09:17:35. It is admissible in evidence to the same extent as the original (s.67 Land Registration Act 2002).**

This title plan shows the general position, not the exact line, of the boundaries. It may be subject to distortions in scale. Measurements scaled from this plan may not match measurements between the same points on the ground. See Land Registry Public Guide 19 - Title Plans and Boundaries.

**This title is dealt with by Land Registry, Croydon Office.**

