

GROUND FLOOR PLAN  
(1/4" = 1 foot)

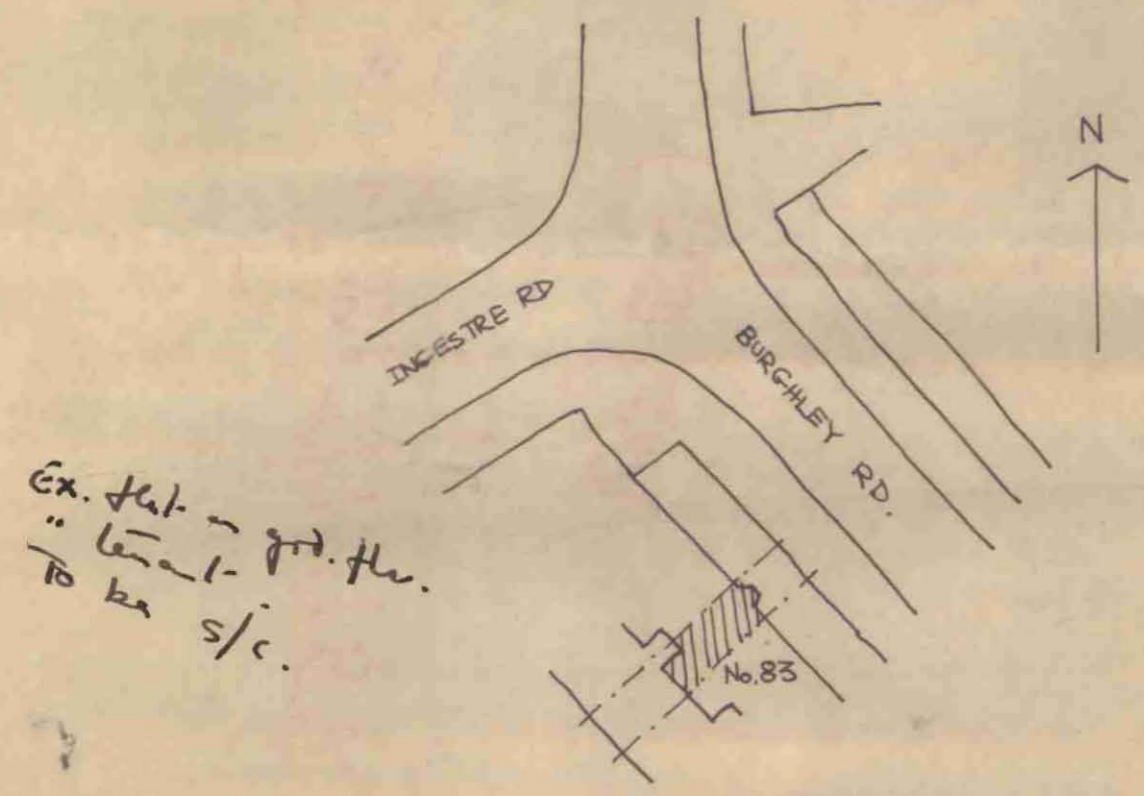

KEY PLAN  
(N.T.S.)

NOTES.

- New partitions to be 3/8" plasterboard on 3" x 2" sawn timber with 'Carlite' skim coat.
- New doors in entrance hall to be flush fire checked type with self closing springs & fitted Yale locks.
- New kitchen window to be clear glass, one fixed pane with three louvres above.
- New bathroom window to be hammered glass, one fixed pane with two louvres above.
- Bath and sink wastes to be 1 1/2" p.v.c.
- Hot and cold feeds to sinks & bath to be 1/2" copper.
- Bathroom light to have cord pull switch.
- Power points required for water heater, cooker, kettle and refrigerator.

LONDON BOROUGH OF CAMDEN  
PLANS APPROVED  
~~DISAPPROVED~~  
- 3 MAY 1972  
ON BEHALF OF THE COUNCIL

CTP/ E11 / 22 / 7 / 12952

GROUND FLOOR ALTERATIONS at  
83 BURGHELEY ROAD NWS  
for C. WANGLER ESQ.

Feb 1972

Drawn by: J.R. TYNE, BSc, CEng, M.I.C.E., M.I. Struct. E.