



Hatch denotes current floor plan

Section Key  
1.200

**Demolition Key**

- Hatch denotes existing building
- Dashed red line denotes demolition
- Hatch denotes structure deemed historical / original to be demolished & formation of new openings

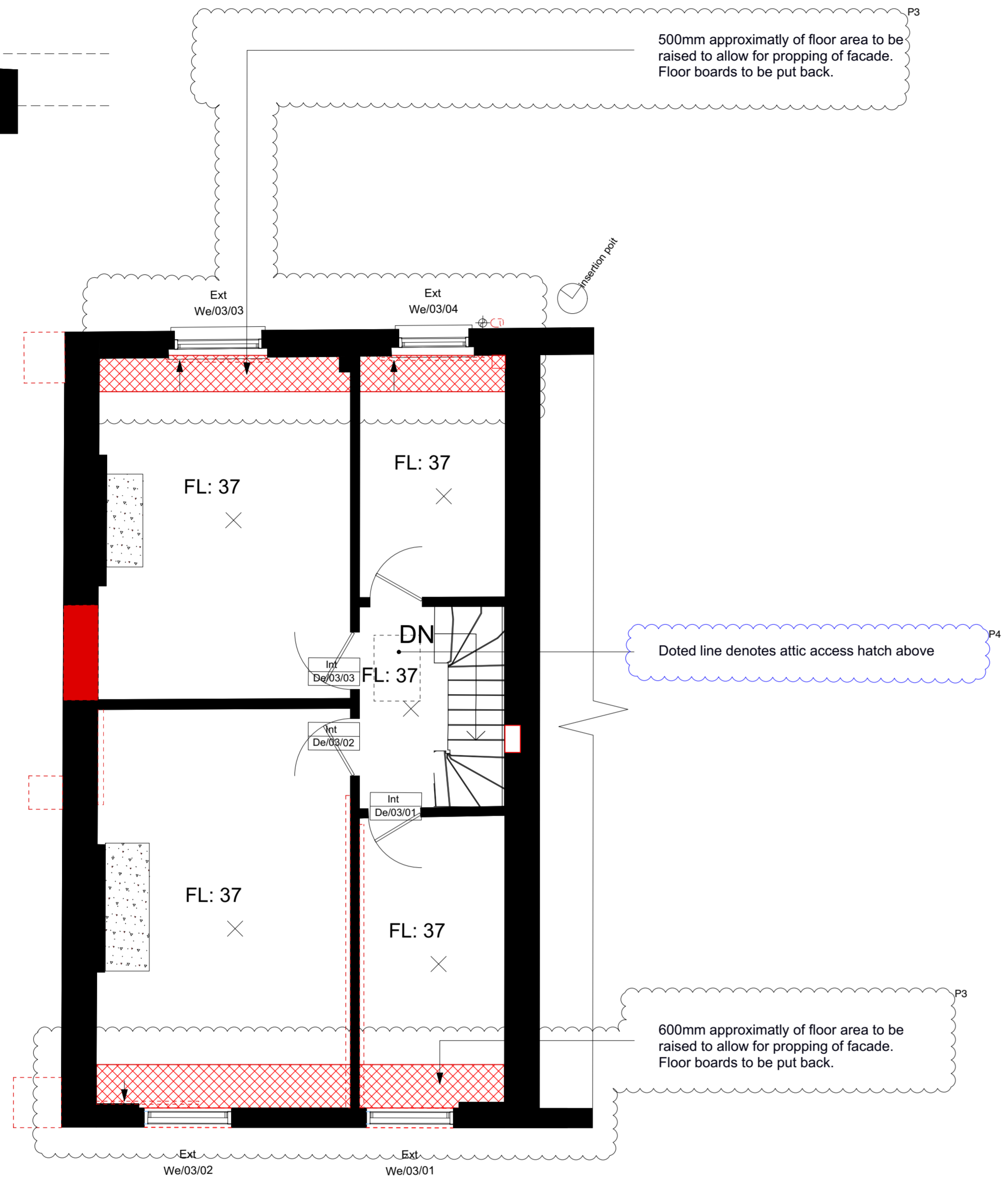

Demolition Third Floor Reflected Ceiling Plan  
1.50

**Stripout:**

Where strip out occurs, all areas to be made good to match existing retained using like-for-like traditional materials. Remove all redundant modern services and modern pipework. All walls to be repaired using traditional lath and plaster and painted.

All existing non-historic floor coverings are to be removed to make way for new floor coverings. Careful raising of the floorboards, documenting the location and type of fixing of each when removed. Ends not to be broken or cut. To be refixed in place using reclaimed or original iron nails, not screws of stainless steel nails. Note if boards are board end nailed when lifted.

Removal of MDF later panels to 4-panelled historic doors.

Non historic skirtings not require to be retained.

Ceilings to be retained and made good.

Strengthening notes generally and cornice demolition details to respond to Condition 4 of the Planning Decision 217/5851/L

For proposed works please refer to GA plans and Schedule of Works

Subsability	Revision	Date	Comments
D3	P1	23/05/18	CEILINGS DEMOLITION EXTENT.

**A1**

© copyright BISSET ADAMS

Notes  
No dimensions are to be scaled from this drawing. The contractor / manufacturer is responsible for checking all dimensions and querying any discrepancies.  
This drawing is the property of Bisset Adams Ltd.  
Copyright is reserved by Bisset Adams Ltd. and the drawing is issued on condition that it is not copied, reproduced, retained or disclosed to any unauthorised person, either wholly or in part, without written consent.

Do not scale  
All dimensions to be checked on site

Project Wohl Wolfson Toddler lab

Key 32 Torrington Square and Annex  
Bloomsbury  
London  
WC1E7HX  
Birkbeck University of London

Logo

Information Title  
**Demolition Thrid Floor RC Plans**

Date	18.03.05	Drawn	RP	Checked	IJ	Scale	1:50
Project No.	BB029	Originator	BA	Zone	Z2	Level	03 - RF
Type	DR	Role	A	Number	1123	Suitability	D3
Revision	P1						

The Cube Building, 17 -21 Wenlock Road, London N1 7GT, United Kingdom  
T +44 (0)20 7250 0440 | E info@bissetadams.com | www.bissetadams.com

**BISSET ADAMS**