

Section Through Front Facade

(Scale 1 : 20)

NOTE:
 1. Existing ceiling to be retained. All works to be undertaken from above.
 2. Existing ceilings to protected during construction. Contractor to take appropriate measures to ensure that ceiling is not damaged.

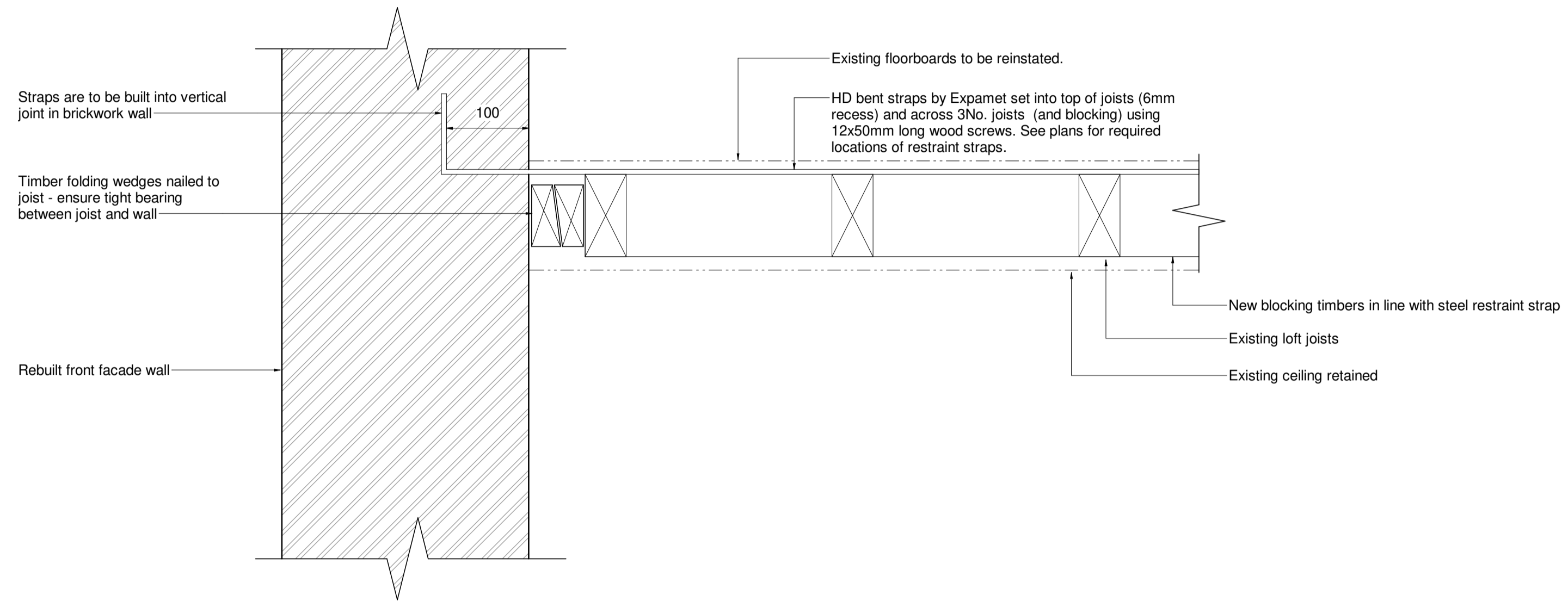

Restraint strap to front facade wall parallel with loft joists

(Scale 1 : 5)

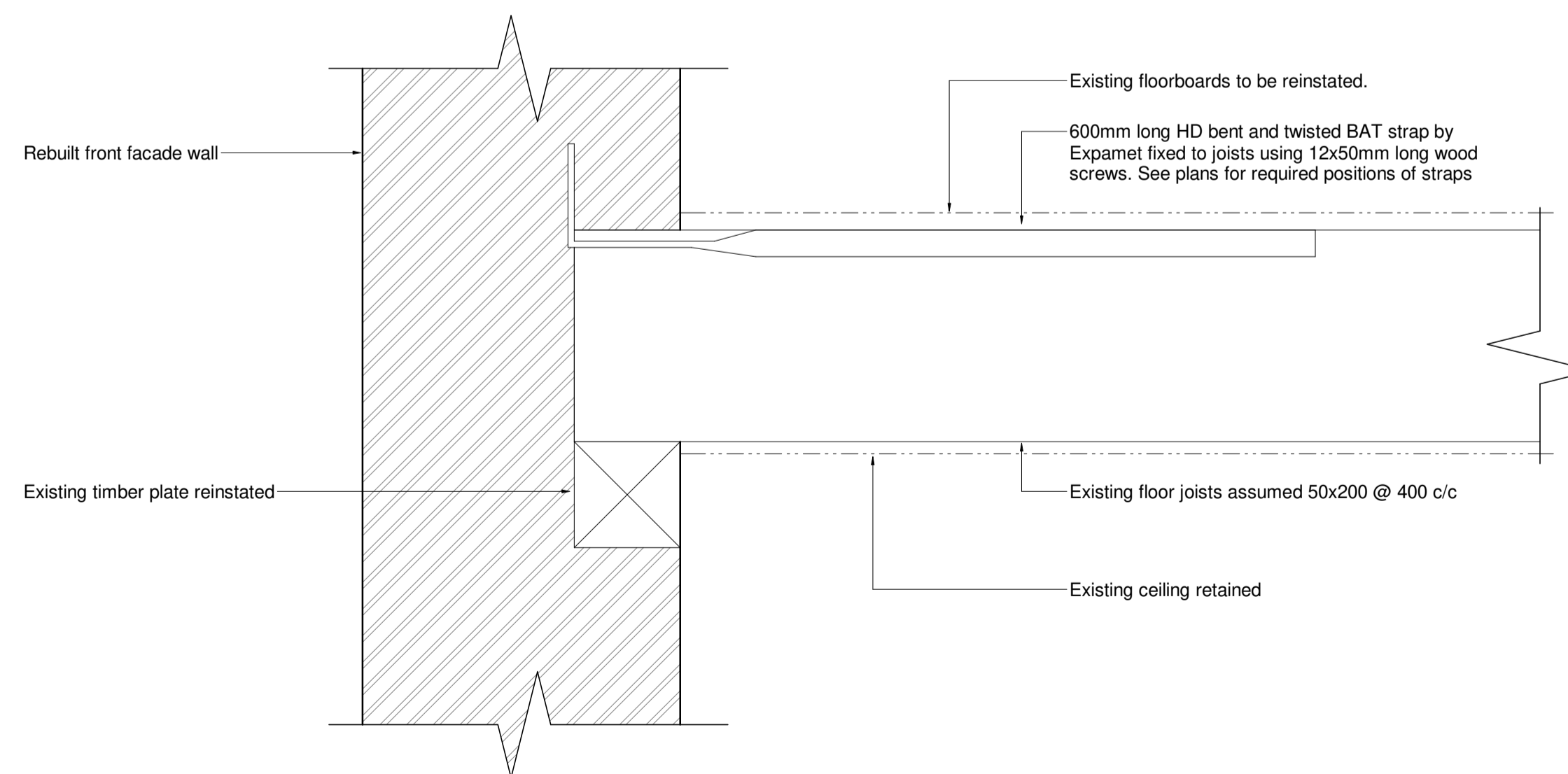

Restraint strap to front facade wall perpendicular with floor joists

(Scale 1 : 5)

Notes

1. This drawing is to be read in conjunction with all relevant Engineers drawings and specifications, as well as in conjunction with WYE Structural Survey Report J2889-S-RP-0001
2. Do not scale from a paper or digital version of this drawing. Use written or stated dimensions only.
3. The existing structure shown on this drawing is based on survey drawings provided by Birkbeck, University of London and on a Survey carried out by WYE 18/11/16 and 07/12/16
4. No works are to take place without prior Listed Building Consent approval.

SAFETY, HEALTH AND ENVIRONMENT	
In addition to the hazards/risks normally associated with the types of work detailed on this drawing, note the following :	
Construction	
Maintenance & Cleaning	
Decommissioning & Demolition	
It is assumed that all works will be carried out by a competent contractor working, where appropriate, to an approved method statement	

Rev	Date	Description	Drm	App
05	05.03.18	Construction Issue	JD	CP
04	16.10.17	Tender Issue	JD	CP
03	11.09.17	Draft Tender Issue	JD	CP
02	25.08.17	Stage 4 Issue	OK	CP
01	21.07.17	Stage 3 Issue	MM	CP
00	13.07.17	Preliminary Stage 3	JD	TW

WEBB YATES ENGINEERS
 48-50 Scrutton Street
 London EC2A 4HH
 020 3696 1550
 www.webbyates.co.uk
 london@webbyates.co.uk

Project
**Toddler Lab,
 32 Torrington Square**

Drawing Title
**Facade Rebuild
 Front & Rear Details**

Drawing Status
Construction

Drawn by	Checked by	Sheet size	Scale	Rev Status
JD	CP	A1	As indicated	S5

Drawing Number	Revision
J2889-S-DR-0011	05