

- Demolition Key**
- Hatch denotes existing building
 - Dashed red line denotes demolition
 - Hatch denotes structure deemed historical / original to be demolished & formation of new openings
 - Intrusive Investigations approved 2017/0611/PRE

Stripout:
Where strip out occurs, all areas to be made good to match existing retained using like-for-like traditional materials. Remove all redundant modern services and modern pipework. All walls to be repaired using traditional lath and plaster and painted.

All existing non-historic floor coverings are to be removed to make way for new floor coverings. Careful raising of the floorboards, documenting the location and type of fixing of each when removed. Ends not to be broken or cut. To be refixed in place using reclaimed or original iron nails, not screws of stainless steel nails. Note if boards are board end nailed when lifted.

Removal of MDF later panels to 4-panelled historic doors.
Non historic skirtings not require to be retained.

Ceilings to be retained and made good.
Strengthening notes generally and cornice demolition details to respond to Condition 4 of the Planning Decision 217/5851/L

For proposed works please refer to GA plans and Schedule of Works

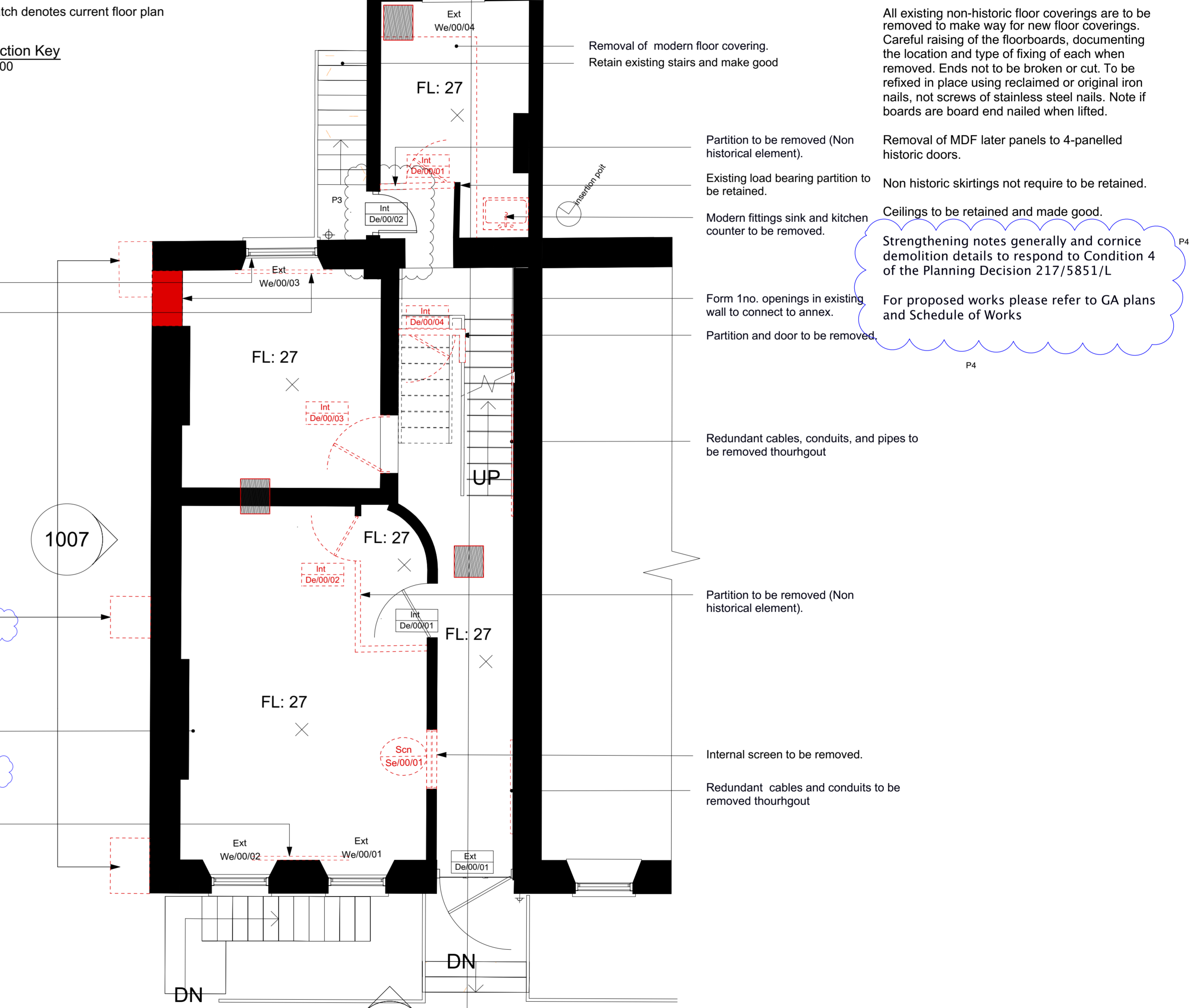
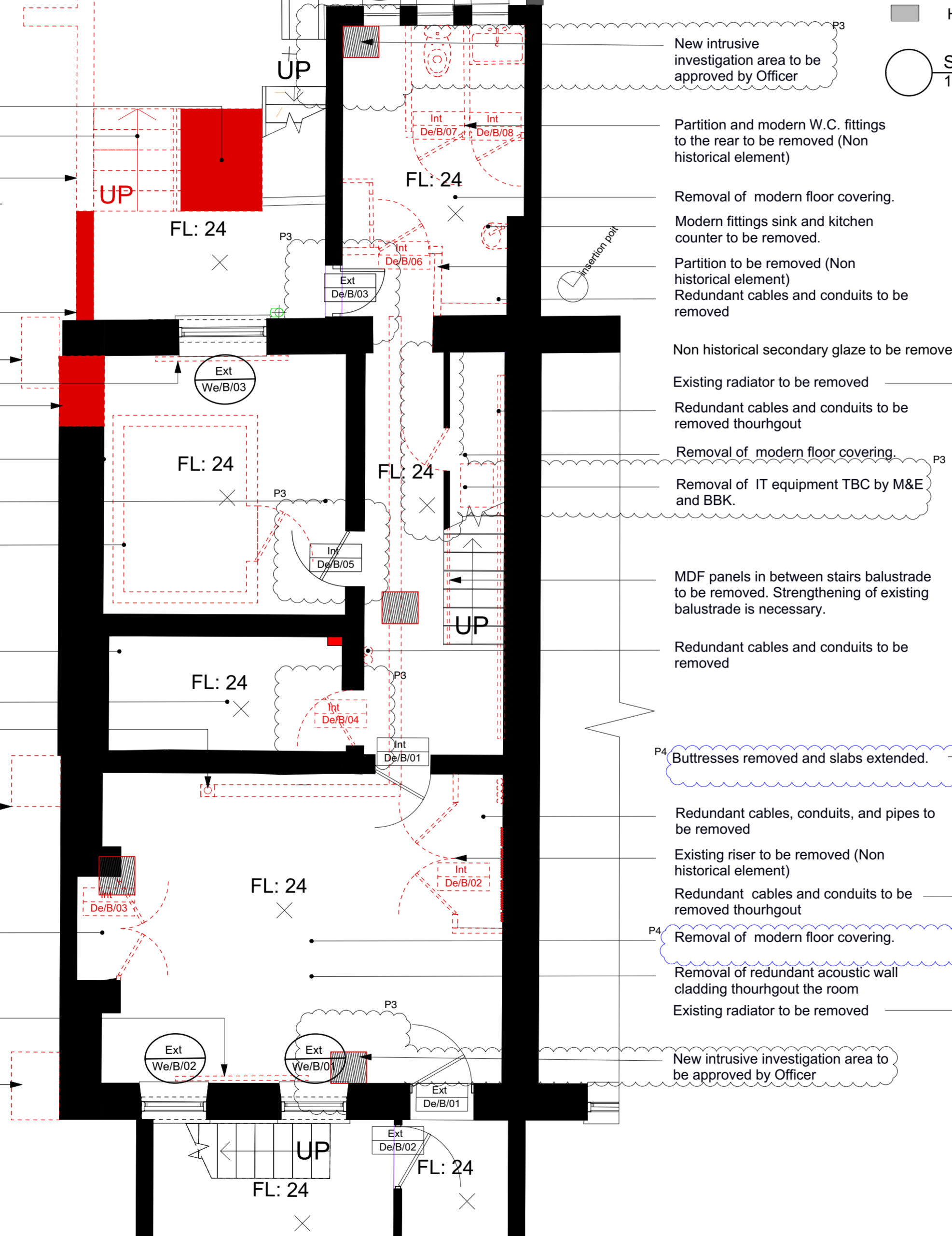
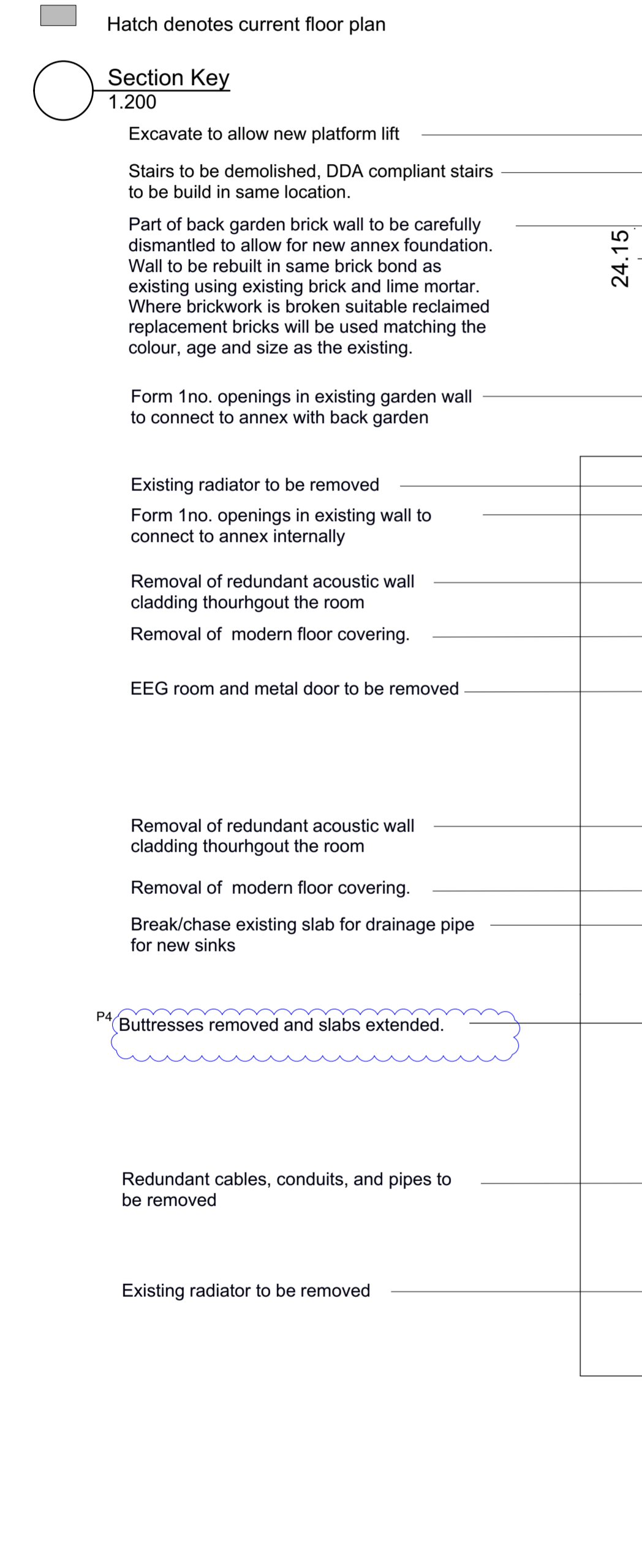

Demolition Basement Floor Plan 1.50

Demolition Ground Floor Plan 1.50

Subsidiarity	Revision	Date	Comments
	D3 P1	05/03/18	Issue for Information
	D4 P2	25/04/18	Issue for Information
	D4 P3	10/05/18	INFORMATION ABOUT CEILINGS AND CORNICES ADDED. EXTRA INTRUSIVE SURVEY AREAS TO BASEMENT TBC
	D4 P4	17/05/18	WORDING ON BUTTRESSES REVISED. KEY NOTE ADDED.

A1 © copyright BISSET ADAMS

Notes
No dimensions are to be scaled from this drawing. The contractor / manufacturer is responsible for checking all dimensions and querying any discrepancies.
This drawing is the property of Bisset Adams Ltd.
Copyright is reserved by Bisset Adams Ltd. and the drawing is issued on condition that it is not copied, reproduced, retained or disclosed to any unauthorised person, either wholly or in part, without written consent.

Do not scale
All dimensions to be checked on site

Project Wohl Wolfson Toddler lab
Key 32 Torrington Square and Annex Bloomsbury London WC1E7HX Birkbeck University of London

Information Title
Demolition Basement & Ground Floor Plans

Date 18.03.05 Drawn RP Checked IJ Scale 1:50

Project No.	Originator	Zone	Level	Type	Role	Number	Suitability	Revision
BB029	BA	Z2	B1-00	DR	A	1101	D4	P4

The Cube Building, 17 -21 Wenlock Road, London N1 7GT, United Kingdom
T +44 (0)20 7250 0440 | E info@bissetadams.com | www.bissetadams.com