

Planning Application for AC PLANT & Installation of flush mounted conservation SKYLIGHT

1. AC PLANT_Garage

Planning application for the installation of an Air Handling Enclosure (AHE) inside existing Garage Building.
Permission required for external alterations to the garage elevation such as creating opening to allow for external plant vents, extract ducts and access louvred doors.

2. Installation of flush mounted conservation SKYLIGHT to roof of garage

Permission required to install flush mounted conservation skylight to allow for natural light and ventilation to room.

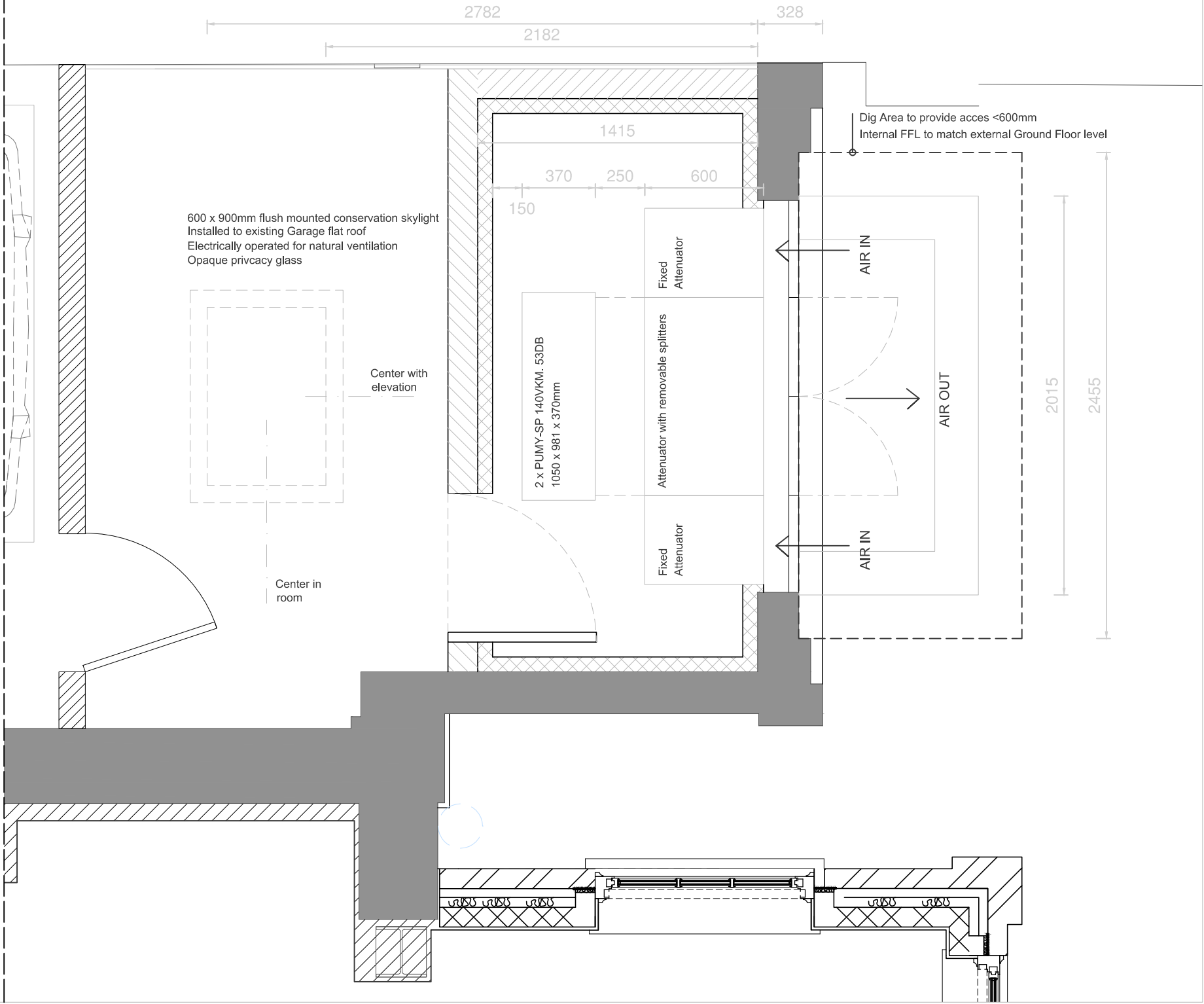

GENERAL NOTES:

This drawing is the copyright property of RedSquare Design & Build Ltd. It may not be copied or disclosed to any third party for any purpose except as authorised in writing by RED SQUARE DESIGN & BUILD Ltd.

Do not scale this drawing. Where no dimension are given, drawings must not be scaled and should be referred to RED SQUARE DESIGN & BUILD Ltd.

Where this drawing related to existing buildings or completed, construction the Contractor shall check that there is no conflict between actual, building dimensions and drawing dimensions.

Should dimensions or details on these drawings conflict, precedence shall be given to the larger scale drawings. In the event of conflict between this drawing and Sub-Contractors working drawings for relevant building components, the Sub-Contractor drawing shall take precedence.

NOTES:

A. Refer to drwg. 780344 drg101A Garage AC Enclosure for technical details and specification.

Scale 1:100



Scale 1: 25

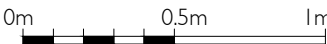

RED SQUARE

First Floor: Kelly House, 1 Warwick Road, Tunbridge Wells, TN11 1YL, UK
t: 01892 860 511 w: www.redsquaredb.com

PLANNING

Date	Revision	Status
18.06.05	P01	Existing Survey

Client:

Project: Hampstead

Subject: AC Garage
Floor Plan

Scale: 1:100 & 1:25 at A3

Drawn by: BRR Checked by: RO
CAD file ref: 71_AC plant.dwg

Project Code	Drawing No.	Revision
71DB	ACG01	P01