

Figured dimensions only are to be taken from this drawing. All dimensions are to be checked on site before any work is put in hand. If in doubt, ask.

All SHH drawings to be read in conjunction with relevant SHH Finishes, Sanitaryware, Lighting & Ironmongery schedules.

Any discrepancies to be highlighted to SHH prior to procurement and in good time.

Copyright © Spence Harris Hogan Limited 2014  
Registered in England & Wales, Registered No. 261 0615  
SHH is the trading name of Spence Harris Hogan Limited



**Legends & Notes:**  
- All glazing to be clear double-glazed glass unless otherwise stated.

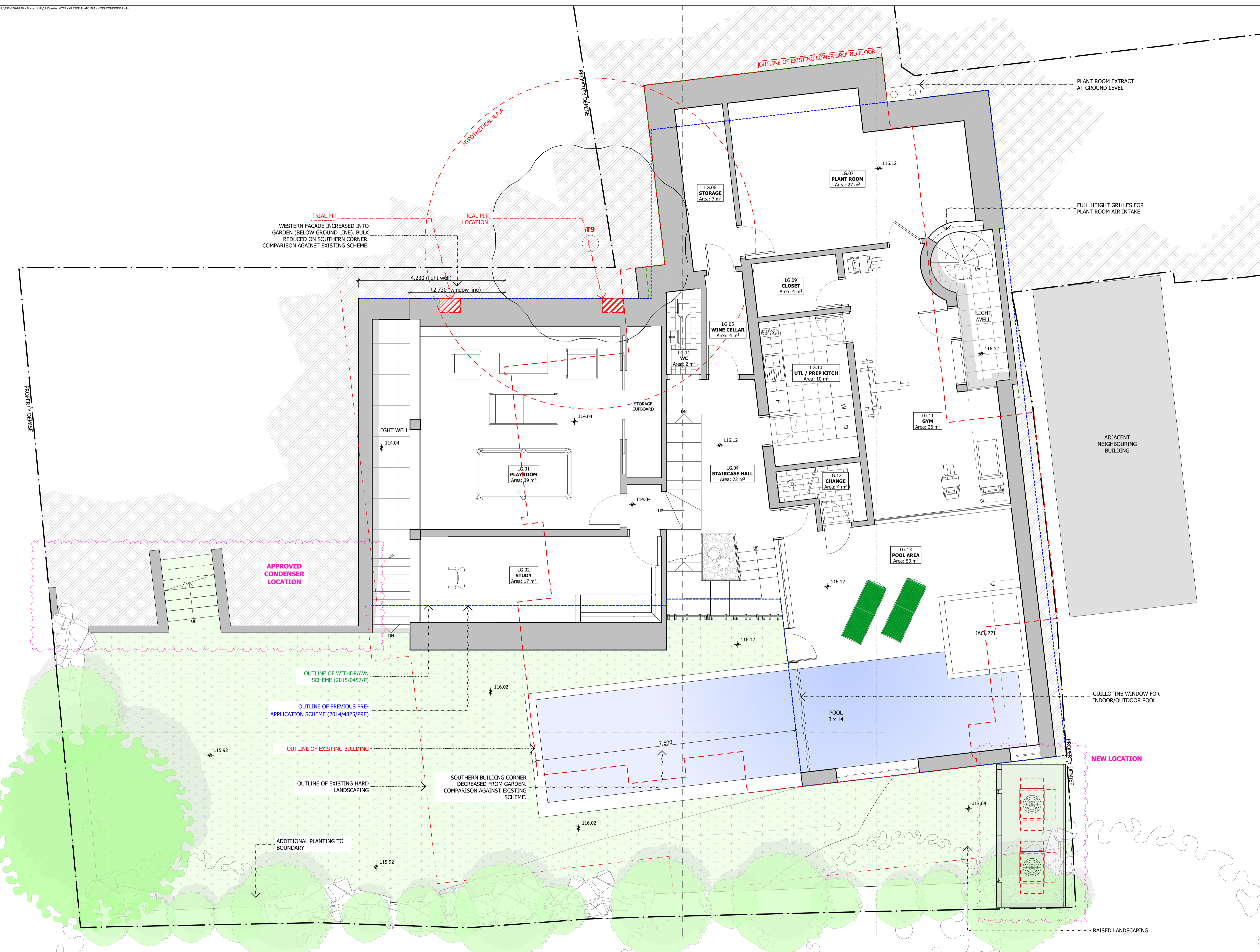

Rev	Date	Descriptor	Athr.
P05	07/06/2018	Relocated condenser enclosure	PG
D	22/06/2015	Amended landscaping	JH
C	15/06/2015	Resubmission of Planning Application	JH
B	17/02/2015	Planning Application amendments	JH
A	28/01/2015	Planning Application	JH

**shh**  
SHH ARCHITECTS | INTERIORS DESIGNERS  
RIBA MEMBER  
Chartered Practices

1 Vincourt Place, Ravenscourt Park  
HammerSmith, London W6 9NU  
Phone +44 (0) 20 8600 4171 Email info@shh.co.uk  
shh.co.uk

**The Kaye's Residence**  
17 Branch Hill, Hampstead  
NW3 7NA  
Client:  
Adam Kaye & Lucy Ronson  
Drawing Title:  
020 General Arrangements  
**Proposed - Lower Ground Floor**

(Project number)DWG number\_Revision: (779)020\_P05