

COMPONENT REFERENCES:

For external door types and dimensions refer to drawing: 31000
 For window and curtain walling types and dimensions refer to drawings: 31050 to 31052
 For precast concrete element types and dimensions refer to drawings: 31100 to 31124

B

A

482

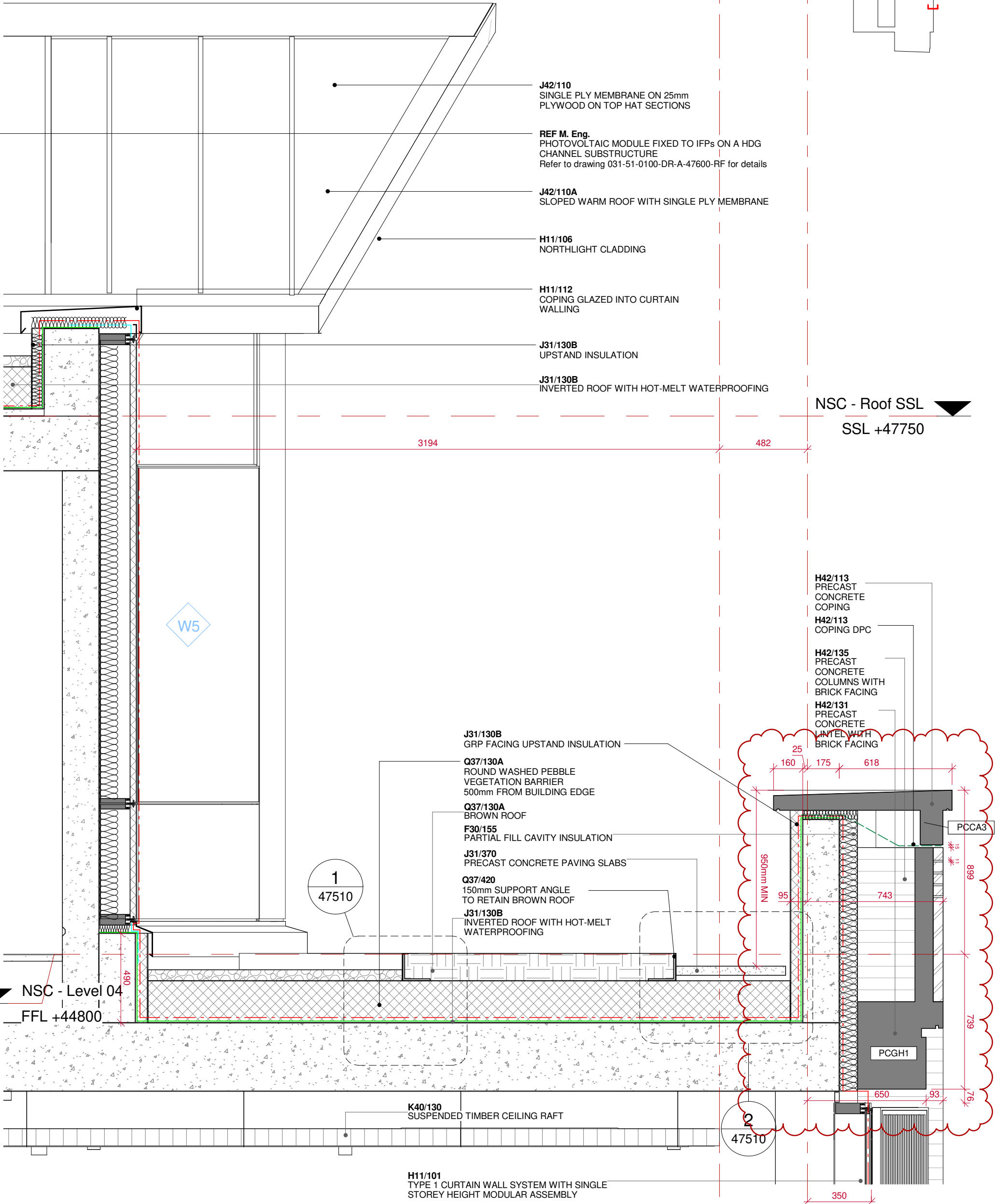
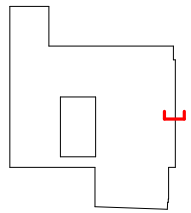

NSC - Roof SSL
 SSL +47750

NSC - Level 04
 FFL +44800

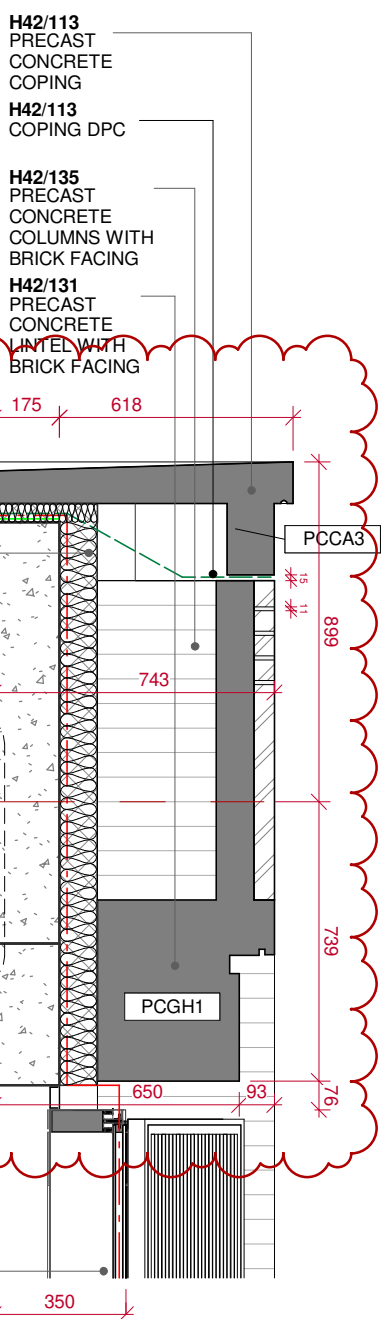

- J31/130B GRP FACING UPSTAND INSULATION
- Q37/130A ROUND WASHED PEBBLE VEGETATION BARRIER 500mm FROM BUILDING EDGE
- Q37/130A BROWN ROOF
- F30/155 PARTIAL FILL CAVITY INSULATION
- J31/370 PRECAST CONCRETE PAVING SLABS
- Q37/420 150mm SUPPORT ANGLE TO RETAIN BROWN ROOF
- J31/130B INVERTED ROOF WITH HOT-MELT WATERPROOFING

1
47510

2
47510

H11/101
 TYPE 1 CURTAIN WALL SYSTEM WITH SINGLE STOREY HEIGHT MODULAR ASSEMBLY

K40/130
 SUSPENDED TIMBER CEILING RAFT

Rev.	Date	Description
C01	31/08/16	Interim construction issue to incorporate VE design development
C02	11/10/16	Interim construction issue for roof package
C03	09/03/17	Transom height and flashing updated. Parapet cladding omitted
C04	09/03/18	General Updates
C05	26/04/18	Insulation note updated



Nicholas Hare Architects
 3 Bamsbury Square London NI 1JL
 telephone +44 (0)20 7619 1670
 fax +44 (0)20 7619 1671
 e-mail 689ucl@nicholashare.co.uk (689)

project UCL New Student Centre
 for University College London
 title Typical section detail - Level 04 - External wall and roof junction

status	Construction To be read in conjunction with all relevant information - do not scale	scale	1:20	size	A3	drawing number	031-51-0100-DR-A-21407-04	rev.	C05
--------	--	-------	------	------	----	----------------	---------------------------	------	-----