

NOTES

Window dimensions taken on site by architect whereas all other elements of drawing (external walls, stairs, etc.) are based on existing sketch drawings provided by client.

■ Proposed intervention (seen in section)

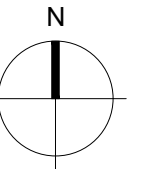
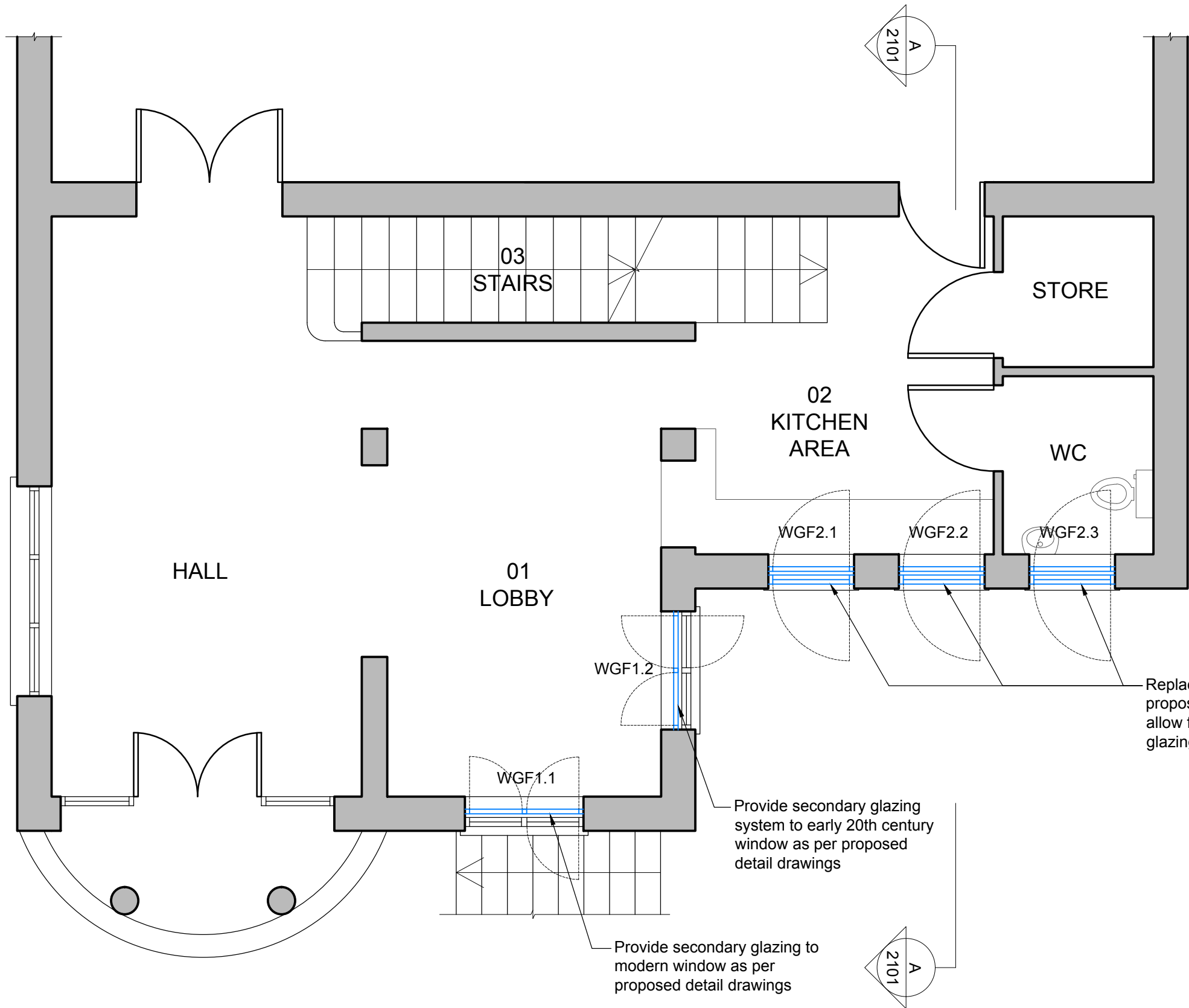

- Notes
- Any dwg format drawing is to be read in conjunction with and at the scale of the accompanying pdf.
 - Where colours other than black or grey are used, the drawing must be plotted in colour.
 - For status 'C' (Construction) drawings all dimensions are to be checked on site by the contractor, scaling is for Local Authority purposes only.
 - Unless otherwise indicated, all dimensions are in millimeters.
 - All information on this drawing is to be read in conjunction with the relevant Donald Insall Associates specification and trade contractors' drawings and information by specialists.
 - In the event of any discrepancy, please contact us immediately.
 - This drawing may contain survey information by others and is to be used solely for the purposes for which it was issued.
 - These are uncontrolled documents issued for information purposes only. If you have any queries regarding the drawings, please contact DIA immediately.
 - Please note DIA cannot be held responsible for any errors arising from changes made to an uncontrolled dwg file.

Drawing Status

F	Feasibility
S	Sketch Design
P	Planning
B	Building Control
D	Design Development
M	Measurement
T	Tender
C	Construction
R	Record

Rev	Date	Dwn	Auth	Revision

Rev	Date	Dwn	Auth	Revision
0	25-05-18	MXV	FM	Initial Issue

<p>Donald Insall Associates Chartered Architects and Historic Building Consultants</p> <p>12 Devonshire Street London W1G 7AB (+44) 020 7245 9888 london@insall-architects.co.uk</p>		Project	HPQMH.01	No	2000
		Scale (A3)	1:50	Status	P
<p>Quaker Meeting House, Hampstead</p> <p>Ground Floor Plan As Proposed</p>		<p>© 2017 DONALD INSALL ASSOCIATES LTD</p>			