

**1 Spencer Rise . NW5 1AR**

**Tree Report. April 2018**

In the absence of adopted local supplementary planning guidance specific to trees  
British Standard 5837 (2012)

“Trees in relation to design, demolition and construction – recommendations”  
**(BS 5837)**

is used as the bench mark for submissions to the Local Planning Authority, the LB of  
Camden.

The owners of number 1 have commissioned Edward Williams Architects to draw up  
plan for a basement to extend under the existing foot print of the house.

The owners have received a positive preapp response from the Borough  
(2017/4115/PRE)

The basement proposal has a lightwell in the front garden.

This report describes how the pavement tree to the south east of the house will be  
protected whilst building operations are taking place.

The tree is managed on behalf of the public by the Borough. It is planted in a circa 1  
metre square pavement pit.

The pavement is of slabs, the adjacent road is tarmac and the kerbs are granite.

The contour of Spencer rise is ascending to the east.

The front garden of number 1 is retained by a historic masonry wall.

The tree has a stem diameter of 240mm at 1.5 metres from ground level.

The height of the crown would be dictated by the Highways Act (in order to give  
clearance over the road and pavement). The tree is a category B as described in  
BS5837.

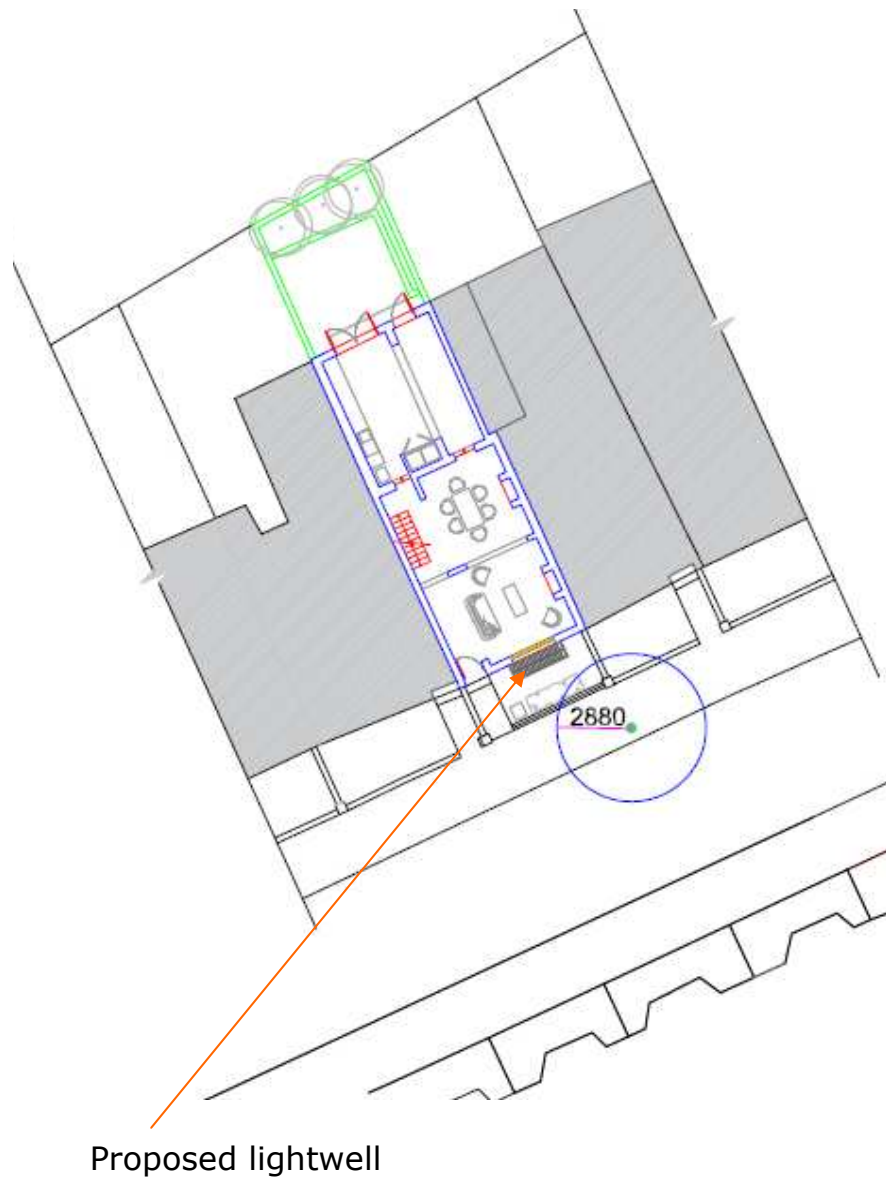

Proposed lightwell

The drawing above shows the “normative root protection area” (**RPA**) (as described in BS 5837) of the tree as a blue circle.

Excavations for the basement and lightwell fall outside the RPA. It is also possible that the garden retaining wall is a partial root barrier. It is very unlikely that the tree will have any significant roots within the curtilage of number 1.

The historic boundary wall will be retained.

The tree will not be impacted by the excavations at number 1.

The lower stem of the tree will be enclosed in a 2 metre high plywood box assembled at the edge of the planting pit. This will prevent contractors accidentally damaging the stem or the area of permeable ground at its base. Contractors will apply for pavement licences and assemble the plywood box prior to any building works and it will remain in place until all work is complete.

Tim Price. M.arbor.A