

**GENERAL NOTES:**

- G1 For Site and GMD setting out refer to AVXXXX/3000
- G2 All dimensions to be checked on site
- G3 Any discrepancies between drawings to be reported to the Architect immediately.
- G4 All Levels are above Ordnance Datum (AOD)  
New Levels are shown thus: 20.349  
Existing Levels are shown thus: EX-20.345  
Retained Existing Levels: EX-20.349
- G5 Use figured dimensions only; Do not scale from drawings. IF IN DOUBT, ASK.
- G6 Refer to Engineers drawings for all structural and services information.
- G7 For tolerances see the Design Drawings and Specifications
- G8 For elements of work subject to Contractor's Design, this drawing is indicative of the Visual & performance requirements only. The Contractor is responsible for the detailed design and coordination of the installation with all other services and trades. The Contractor shall design drawings, contract terms and contract documents.
- G9 Room numbers are shown thus: T13
- G10 Door(D) & Window (W) References  
Door No. DL-G-006 60 Fire Rating R402  
are shown thus: DL-G-006 R402  
Homogeneity Type
- G11 Clear height to be shown thus 2720
- G12 T Sheet Reference shown thus IWS-01
- G13 Finishes are shown thus: WALL CEILING FLOOR WALL
- G14 Setting Out Points shown thus: SOP ⊕
- G15 Refer to AVXXXX/3100 for T Sheet references, and to AVXXXX/3110 to 3167 for Architectural Specifications.

**NOTES:**

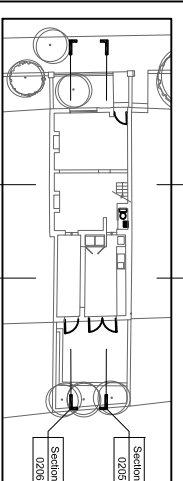

Date	Revision	Status
06.04.2018	A	Issued to MBA, Memo 0037

**EDWARD WILLIAMS ARCHITECTS**

45 Notting Hill Gate, London, W11 3LD  
E: [enl@edwardwilliamsarchitects.com](mailto:enl@edwardwilliamsarchitects.com)

**Project:** 1 Spencer Rise

**Subject:** Proposed Section B

<b>Scale:</b> 1 : 100 @ A3		
Sort Code	Drawing No.	Revision
A/1SR	1041	A

