

GENERAL NOTES:

- G1 For Site and Grid setting out refer to AVXXXX/3000
- G2 All dimensions to be checked on site
- G3 Any discrepancies between drawings to be reported to the Architect immediately.
- G4 All Levels are above Ordnance Datum (AOD)
New Levels are shown thus: [20.349]
Existing Levels are shown thus: [EX 20.345]
Retained Existing Levels: [EX 20.349]
- G5 Use figured dimensions only; Do not scale from drawings. IF IN DOUBT, ASK.
- G6 Refer to Engineers drawings for all structural and services information.
- G7 For tolerances see the Design Drawings and Specifications
- G8 For elements of work subject to Contractor's Design, this drawing is indicative of the Visual & performance requirements only. The Contractor is responsible for the detailed design and coordination of the installation with the relevant services and other trades. All design drawings, contract terms and contract documents.
- G9 Room numbers are shown thus: [115]
- G10 Door(D) & Window (W) References
Door No. [DLG-006 60] Fire Rating [R402]
Homogeneity Type
- G11 Clear height to be shown thus [2720]
- G12 T Sheet Reference shown thus [IWS-01]
- G13 Finishes are shown thus:
WALL, CEILING, FLOOR, WALL
- G14 Setting Out Points shown thus: [SDP]
- G15 Refer to AVxxx03100 for T Sheet references, and to AVxxx03110 to 03167 for Architectural Specifications.

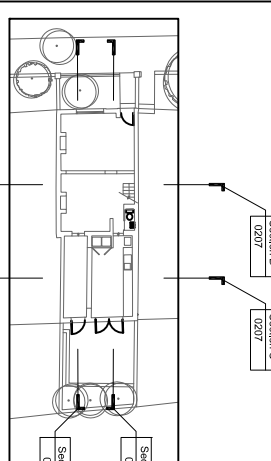
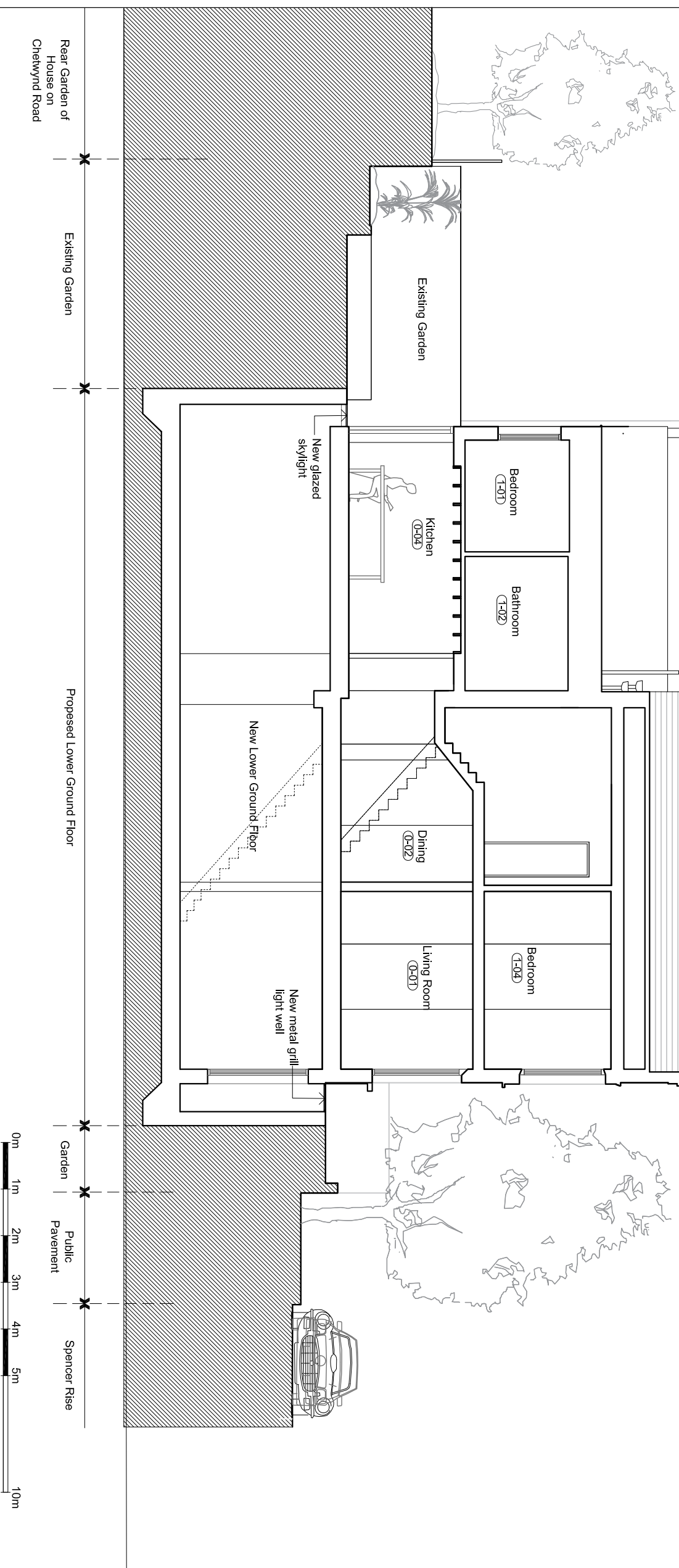
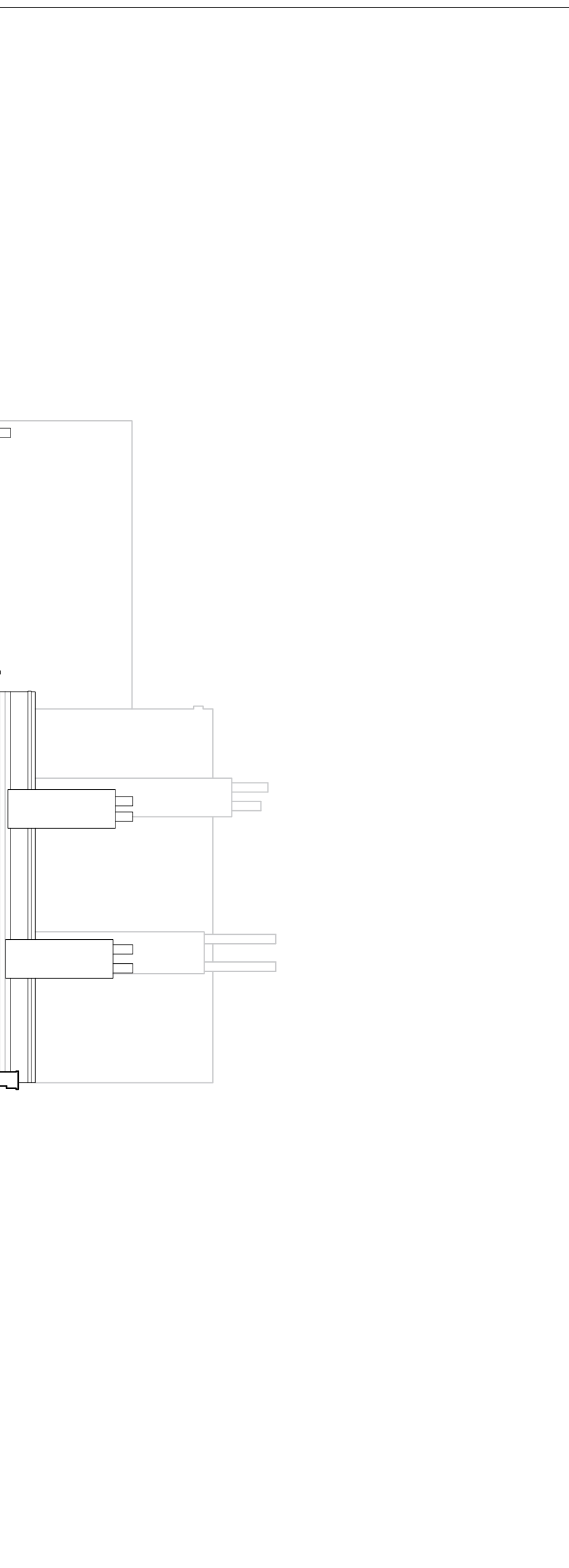

Date	Revision	Status
06.04.2018	A	Issued to MBA, Memo 0037

EDWARD WILLIAMS ARCHITECTS

45 Notting Hill Gate, London, W11 3LD
E: ewa@edwardwilliamsarchitects.com

Project: 1 Spencer Rise
Subject: Proposed Section A

Scale: 1 : 100 @ A3		
Sort Code	Drawing No.	Revision
A/1SR	1040	A