

NOTES:
 1. THIS DRAWING NOT TO BE SCALED, FIGURED DIMENSIONS ONLY TO BE TAKEN.
 2. SHOULD ANY DISCREPANCIES BE FOUND WITH THIS DRAWING, PLEASE INFORM THIS OFFICE.
 3. COPYRIGHT OF THIS DRAWING IS OWNED BY JM ARCHITECTS.

STRUCTURAL INFORMATION INDICATIVE ONLY. TO BE CONFIRMED BY STRUCTURAL ENGINEER.
 REFER TO STRUCTURAL ENGINEER'S DRAWINGS FOR LOCATIONS OF BRACING & WINDPOSTS.

189-191 CAMDEN HIGH STREET, CAMDEN TOWN, LONDON, NW1 7BP

The Works

No works to be carried out on this floor

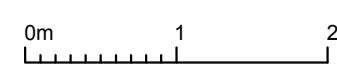
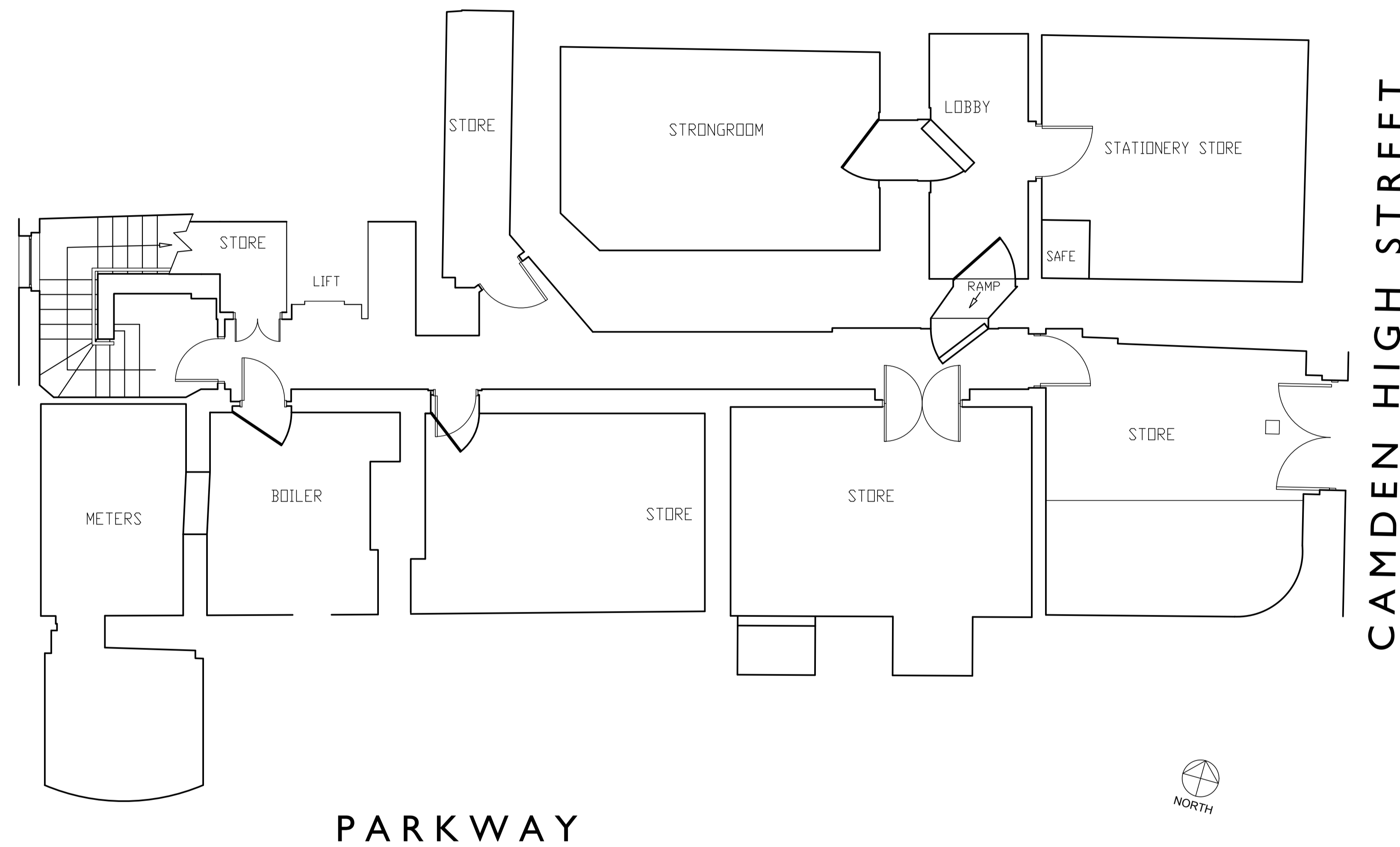

REV.	DESCRIPTION	DATE	DRAWN BY	CHKD BY

jmarchitects

PROJECT
RBS Camden Town 189/191 Camden High Street, NW1 7BP

TITLE
PROPOSED BASEMENT PLAN

CLIENT
ROYAL BANK OF SCOTLAND

JOB No. 6402	DRAWING No. L(47)0009	REVISION
SCALE 1:50@A1	DRAWN BY JT	CHECKED BY PI
STATUS PLANNING	DATE 22.05.2018	

12 Great Portland Street
 London
 W1W 8QN
 T: 0207 580 5330
 F: 0207 436 5348
 london@jmarchitects.net
 www.jmarchitects.net