

BELSIZE PARK FIRESTATION

REF 'A1' LUMINAIRE  
CEILING RECESSED LED DOWNLIGHT,  
7.6 W, 500lm-3000lm, 2700K-4000K, CRI80+,  
80mm (W) x 81mm (D).  
OPTIONAL: 3HR MAINTAINED EMERGENCY  
BACK UP, DIMMING CONTROL, DALL.

LOCATION: APARTMENTS & CIRCULATION



REF 'A2' LUMINAIRE  
CEILING RECESSED IP65 LED DOWNLIGHT,  
7.6 W, 500lm-3000lm, 2700K-4000K, CRI80+,  
80mm (W) x 81mm (D).

LOCATION: BATHROOMS & WC'S



REF 'P1' LUMINAIRE  
FIXED LED PENDANT,  
9/10W, 500lm-700lm, 2700K, CRI90.

OPTIONAL: DIMMING CONTROL, CORD  
LENGTH, GLASS COLOUR, RETROFIT LED.

LOCATION: APARTMENT DINING AREA



REF '1.1' & '1.2' LUMINAIRE  
RECESSED LINEAR LED STRIP.  
WATTS VARY ON LENGTH.

OPTIONAL: IP RATING, CASING TYPES.

LOCATION: APARTMENT FURNITURE



REF 'X1' LUMINAIRE  
EXTERNAL WALL MOUNTED LED,  
3W, IP65 RATED.

LOCATION: ADJACENT TO EXTERNAL  
ENTRANCES.



REF 'L2' LUMINAIRE  
BATHROOM WALL MOUNTED  
16W, IP65 RATED.

LOCATION: MIRROR LIGHT.

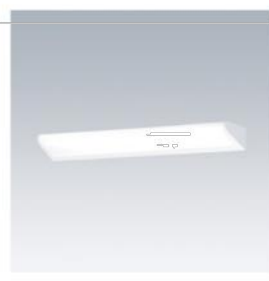

REF 'X3' LUMINAIRE  
EXTERNAL WALL MOUNTED LED,  
14W, IP65 RATED.

LOCATION: ADJACENT TO EXTERNAL  
ENTRANCES.



KEYPLAN

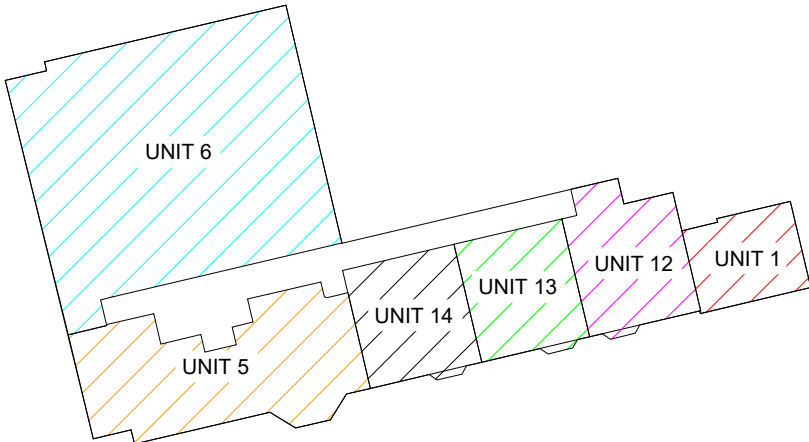

LIGHTING SERVICES INSTALLATION NOTES

- 1.00** ALL LIGHTING CIRCUITS AND CABLING IN APARTMENTS TO BE 1.5mm<sup>2</sup> T&E IN STUD PARTITIONS AND WALL TO BE CONTAINED IN PVC CONDUIT.
- 2.00** CABLING FOR LIGHTING INSTALLATION IN ALL OTHER AREAS TO BE 2.5mm LSF SINGLES IN GALVANISED STEEL CONDUIT OR TRUNKING UNLESS OTHERWISE INDICATED.
- 3.00** EACH LUMINAIRE TO HAVE A DEDICATED "CLICK" TYPE CONNECTOR TO BE LOCATED NO MORE THAN 500mm FROM THE LUMINAIRE. THE CONNECTION BETWEEN THE "CLICK" & THE LUMINAIRE SHALL BE IN 1.5mm<sup>2</sup> PVC/LSOH FLEX.
- 4.00** WHERE EXIT SIGNS ARE INDICATED WITH A GENERAL LIGHTING LUMINAIRE THE SIGN SHALL BE PROPRIETARY TO AND COMPLETELY INTEGRATED WITH THAT LUMINAIRE.
- 5.00** ALL LIGHTING IN CORRIDOR AREAS TO BE SWITCHED AND CONTROLLED BY THE LIGHTING / CONTROL MODULES. REFER TO IN2 Drg. No. E1180 LIGHTING SCHEMATIC.
- 6.00** THE ELECTRICAL CONTRACTOR SHALL BE RESPONSIBLE FOR ENSURING THAT ALL LUMINAIRES SPECIFIED COME COMPLETE WITH PLASTER MOUNTING KITS, RECESSING BOXES, FIXING CLIPS, LAMPS AND DRIVERS.

SCHEDULE OF LIGHT SWITCHING

- LIGHTING CIRCUIT
- LIGHTING SUB-CIRCUIT (SEPARATE SWITCH)
- CAT 6 ELV LIGHTING CIRCUIT FOR GROUPED LED SOURCES
- 0 - 10V CONTROL CABLE FLUORESCENT DIMMING CONTROL CIRCUIT
- FIRE RATED CIRCUIT FOR EMERGENCY LIGHTING
- DENOTES INDICATIVE ROUTE OF CAST IN-SITU CONDUIT
- LED EMERGENCY LUMINAIRES C/W 3 HOUR EMERGENCY BATTERY BACKUP
- 1 5A SINGLE 5A SWITCHED SOCKET OUTLET FOR USE WITH TASK LIGHTING
- 1 1-GANG, 1 WAY WALL MOUNTED LIGHT SWITCH
- N WALL MOUNTED LIGHT SWITCH C/W NEON INDICATOR
- 2 2-GANG, 1 WAY WALL MOUNTED LIGHT SWITCH
- 2 1-GANG, 2 WAY WALL MOUNTED LIGHT SWITCH
- 2 2-GANG, 2 WAY WALL MOUNTED LIGHT SWITCH
- INTERMEDIATE 1 WAY WALL MOUNTED LIGHT SWITCH
- M M MOMENTARY / WARDROBE LIGHT SWITCHES (SEE IMAGE)
- W 1-GANG, 1 WAY EXTERNAL WALL MOUNTED LIGHT SWITCH
- W 1-GANG, 2 WAY EXTERNAL WALL MOUNTED LIGHT SWITCH
- W WALL MOUNTED SINGLE SCENE LIGHTING CONTROL SWITCH
- W WALL MOUNTED MULTI SCENE LIGHTING CONTROL SWITCH
- CEILING MOUNTED 360° LIGHTING PASSIVE INFRA RED MULTI-SENSOR
- LIGHTING CONTROL PANEL

- ☐ S1 ISSUED FOR COORDINATION
- ☐ S2 ISSUED FOR INFORMATION
- ☒ S3 ISSUED FOR INTERNAL REVIEW AND COMMENT
- ☐ S4 ISSUED FOR CONSTRUCTION APPROVAL

NOTE: ARCHITECTURAL DRAWING USED FOR COMPILATION OF IN2 DRAWING. ARCHITECTURAL DRAWING REVISION: P1 DATE RECEIVED : 12.01.2018

STATUS	DATE	DESCRIPTION	DRN	ENG	APP	REV
S3	11.05.2018	PRELIMINARY ISSUE	JDT	JW	BF	P1

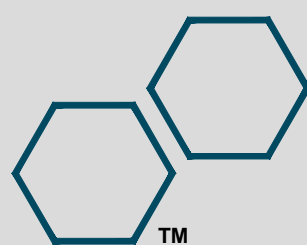

**IN2**  
ENGINEERING DESIGN PARTNERSHIP  
DUBLIN . ATHLONE . BELFAST . LONDON



PROJECT  
**BELSIZE PARK FIRESTATION**

CLIENT  
**PLATINUM LAND**

DRAWING TITLE  
**ELECTRICAL SERVICES INSTALLATION  
GROUND FLOOR LEVEL - UNITS 13 & 14  
LIGHTING SERVICES LAYOUT**

STATUS  
**S3**

SCALE  
1:100 @ A1  
1:200 @ A3

SIZE  
**A1**

PROJECT REF:  
**L18051**

DRAWING No.  
**L18051-IN2-00-00-DR-E-1002**

REVISION  
**P1**

THIS DRAWING IS THE PROPERTY OF IN2 ENGINEERING DESIGN PARTNERSHIP & SHALL NOT BE USED, REPRODUCED OR DISCLOSED TO ANYONE WITHOUT PRIOR WRITTEN PERMISSION OF IN2 ENGINEERING DESIGN PARTNERSHIP & SHALL BE RETURNED UPON REQUEST.