



- 1

RED MULTI FACING BRICKWORK WALL
- 2

CHAMFERED BRICKWORK REVEAL
- 3

RECESSED BRICKWORK DETAILING
- 4

SOLDIER COURSE BRICKWORK CAPPING DETAIL
- 5

HEADER COURSE BRICKWORK CAPPING DETAIL
- 6

EXISTING BOUNDARY TREATMENT TO REMAIN
- 7

DARK GREY PPC RAILING
- 8

DARK GREY PPC GATE
- 9

PPC SCHOOL LOGO SIGNAGE
- 10

MUGA LIGHTING
- 11

MUGA FENCING
- 12

PLANTING ALONG CLARENDON GROVE BOUNDARY
- 13

MID GREY RENDER RAINSCREEN
- 14

FLASHING

DO NOT SCALE THIS DRAWING ALL DIMENSIONS MUST BE CHECKED ON SITE
INFORM THE ARCHITECT OF ANY DISCREPANCIES PRIOR TO CONSTRUCTION

KEY PLAN

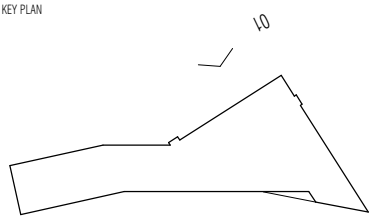

CDM REGULATIONS

THESE NOTES IDENTIFY THOSE HAZARDS WHICH THE DESIGNER DEEMS TO BE SIGNIFICANT, UNUSUAL, NOT LIKELY TO BE OBVIOUS TO A COMPETENT CONTRACTOR
AND/OR DIFFICULT TO MANAGE. IF ANY SUCH HAZARDS ARE IDENTIFIED AND NOT LISTED BELOW THEN THEY SHOULD BE BROUGHT TO THE ATTENTION OF THE
ARCHITECT

HAZARD	DATE ADDED	DATE MITIGATED	RISK ASSESSMENT DATE
NO SIGNIFICANT HAZARDS UNDER THE CDM REGULATIONS HAVE BEEN IDENTIFIED RELATING TO WORK ON THIS DRAWING			

NOTES

REV	DATE	DESCRIPTION	DRN	CHK
P01	15.06.16	FOR PLANNING	JDM	MP
P02	16.05.18	FOR PLANNING	MP	--

DRAWING TITLE
PROPOSED 3D VIEW
STUDENT ENTRANCE AND
CLARENDON GROVE

SCALE NTS AS SHEET
STATUS
PLANNING
DRAWING NO
2698-JW-228
REV
P02

jestico + whites
1 Cobourg Street London NW1 2HP
t +44 (0) 20 7380 0382 f +44 (0) 87 0622 0732 w jesticowhites.com
architecture - interior design london - prague

CLIENT
KIER CONSTRUCTION
PROJECT
MARIA FIDELIS CATHOLIC SCHOOL