

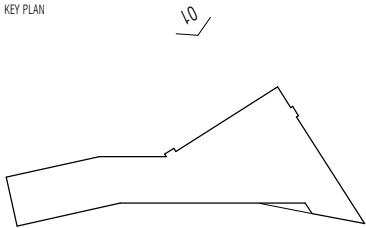

DO NOT SCALE THIS DRAWING ALL DIMENSIONS MUST BE CHECKED ON SITE
INFORM THE ARCHITECT OF ANY DISCREPANCIES PRIOR TO CONSTRUCTION

KEY PLAN



NOTES

- | | |
|---|--|
| 1 RED MULTI FACING BRICKWORK WALL | 7 DARK GREY PPC RAILING |
| 2 CHAMFERED BRICKWORK REVEAL | 8 DARK GREY PPC GATE |
| 3 RECESSED BRICKWORK DETAILING | 9 PPC SCHOOL LOGO SIGNAGE |
| 4 SOLDIER COURSE BRICKWORK CAPPING DETAIL | 10 MUGA LIGHTING |
| 5 HEADER COURSE BRICKWORK CAPPING DETAIL | 11 MUGA FENCING |
| 6 EXISING BOUNDARY TREATMENT TO REMAIN | 12 PLANTING ALONG CLARENDON GROVE BOUNDARY |

REV	DATE	DESCRIPTION
P01	15.06.16	FOR PLANNING

DRN	CHK
JDM	MP

DRAWING TITLE
PROPOSED 3D VIEW
STUDENT ENTRANCE AND
CLARENDON GROVE

SCALE NTS

A3 SHEET

STATUS
PLANNING

DRAWING NO
2698-JW-228

REV
P01

jestico + whites

1 Cobourg Street London NW1 2HP
t +44 (0) 20 7380 0382 f +44 (0) 87 0622 0732 w jesticowhites.com

architecture - interior design london - prague

CLIENT

KIER CONSTRUCTION

PROJECT

MARIA FIDELIS CATHOLIC SCHOOL