

**SITE LOCATION**  
(Scale 1:50000)  
Ordnance Survey map extract based upon Landranger map series with the permission of the controller of Her Majesty's Stationery Office Licence No. 0100023487 Crown copyright.

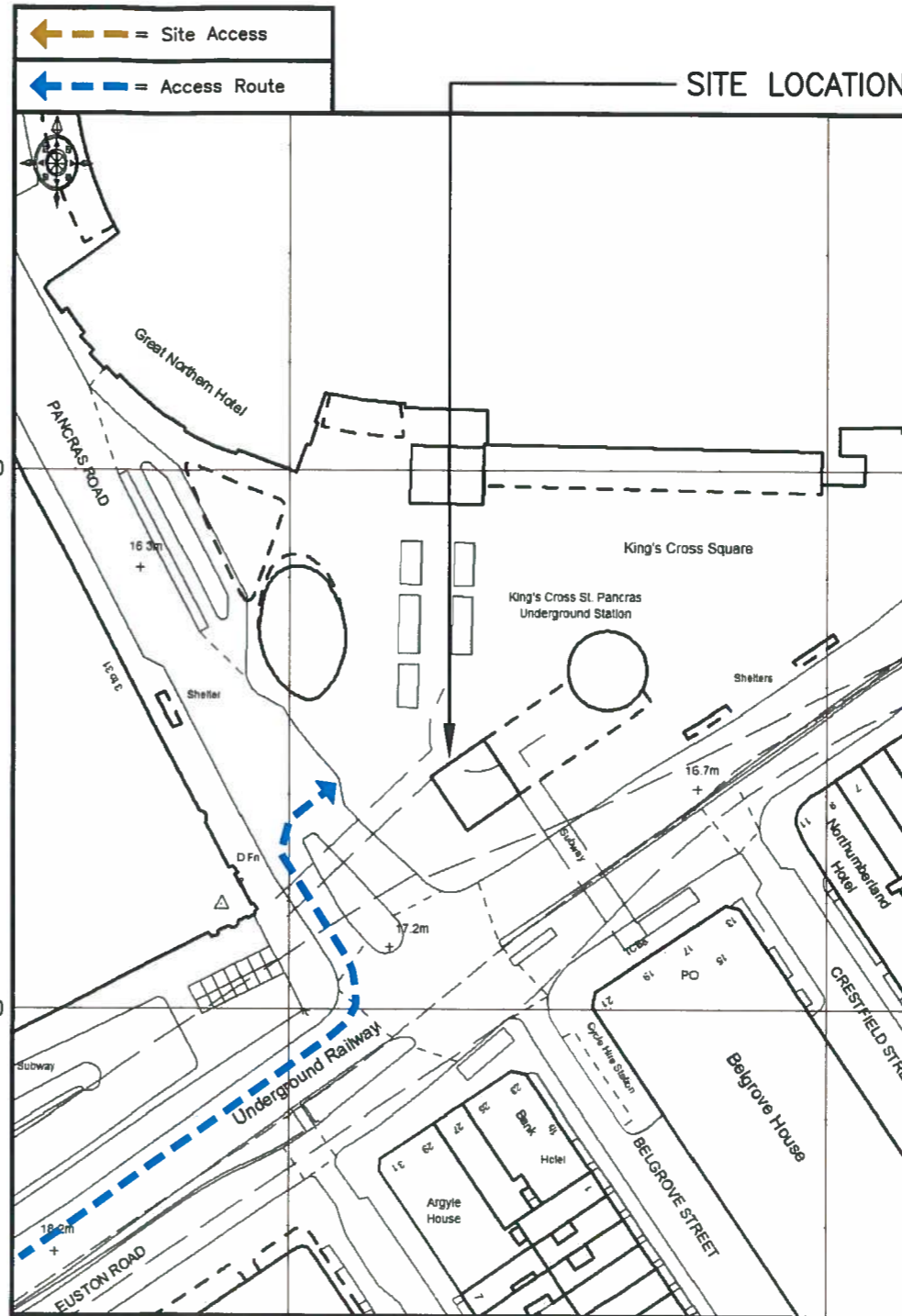

**SITE PHOTOGRAPH**



**DETAILED SITE LOCATION**  
(Scale 1:1250)

Based upon Ordnance Survey map extract with the permission of the Controller of Her Majesty's Stationery Office. Crown copyright. Licence No. 100020449

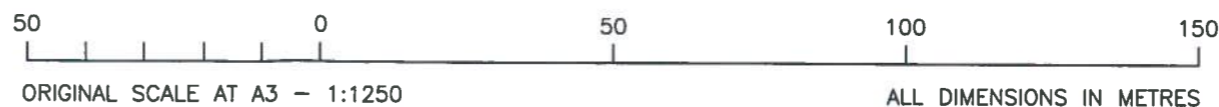

ALL DIMENSIONS ARE IN mm UNLESS NOTED OTHERWISE

N.G.R	E: 530233	N: 182948
CONCESSION REQUIRED	NO	

DIRECTIONS TO SITE:  
HEADING SOUTH ON M1 CONTINUE STRAIGHT ON TO STAPLES CORNER. BEAR LEFT THEN ENTER THE ROUNDABOUT AND TAKE THE FIRST EXIT ON TO EDGEWARE ROAD. AFTER 0.2 MILES TAKE THE SLIPROAD RIGHT THEN BEAR LEFT ON TO A5 EDGEWARE ROAD. AFTER 4.2 MILES BEAR LEFT THEN CONTINUE STRAIGHT ON TO A501 MARYLEBONE ROAD. THE SITE WILL BE ON THE LEFT HAND SIDE AFTER APPROX. 2.0 MILES.

NOTES:

A	Issued for Approval	BB	CT	06.02.18
REV	MODIFICATION	BY	CH	DATE

NET COVERAGE SOLUTIONS  
CRAVEN COURT  
STANHOPE ROAD  
CAMBERLEY  
SURREY GU15 3BS

TEL: +44(0)1276 854440  
FAX: +44(0)1276 854450

**CTIL - LONDON**

Cell Name		Opt.
TFL KINGS CROSS		-
Cell ID No		
CTIL	TEF	VF
242424	099844	N/A

Site Address / Contact Details  
KINGS CROSS STATION  
EUSTON ROAD  
LONDON  
N1C 4AG

Drawing Title: SITE LOCATION MAPS				
Purpose of issue: PLANNING				Dwg Rev: A
Drawing Number: 100				
Surveyed By: CT		Original Sheet Size: A3		Pack Issue: 
Drawn: BB	Date: 06.02.18	Checked: CT	Date: 06.02.18	C

ALL DIMENSIONS ARE IN mm UNLESS NOTED OTHERWISE  
 N.G.R: E: 530233 N: 182948  
 CONCESSION REQUIRED NO

DIRECTIONS TO SITE:  
 HEADING SOUTH ON M1 CONTINUE STRAIGHT ON TO STAPLES CORNER, BEAR LEFT THEN ENTER THE ROUNDABOUT AND TAKE THE FIRST EXIT ON TO EDGEWARE ROAD. AFTER 0.2 MILES TAKE THE SLIPROAD RIGHT THEN BEAR LEFT ON TO AS EDGEWARE ROAD. AFTER 4.2 MILES BEAR LEFT THEN CONTINUE STRAIGHT ON TO A501 MARYLEBONE ROAD. THE SITE WILL BE ON THE LEFT HAND SIDE AFTER APPROX. 2.0 MILES.

NOTES:

REV	MODIFICATION	BY	CH	DATE
A	Issued for Approval	BB	CT	06.02.18



NET COVERAGE SOLUTIONS  
 CRAVEN COURT  
 STAMFORD ROAD  
 CAMBERLEY  
 SURREY GU15 3BS  
 TEL: +44(0)1276 854440  
 FAX: +44(0)1276 854450



Cell Name  
 TFL KINGS CROSS  
 Cell ID No  
 CTIL TEF V/F

Site Address / Contact Details  
 KINGS CROSS STATION  
 EUSTON ROAD  
 LONDON  
 N1C 4AG

Drawing Title:  
 LEASE DRAWING  
 Purpose of Issue:  
 PLANNING  
 Drawing Number:  
 101

Drawn: BB  
 Date: 06.02.18  
 Checked: CT  
 Date: 06.02.18  
 Pack Issue: A3  
 Original Sheet Size: A3

C

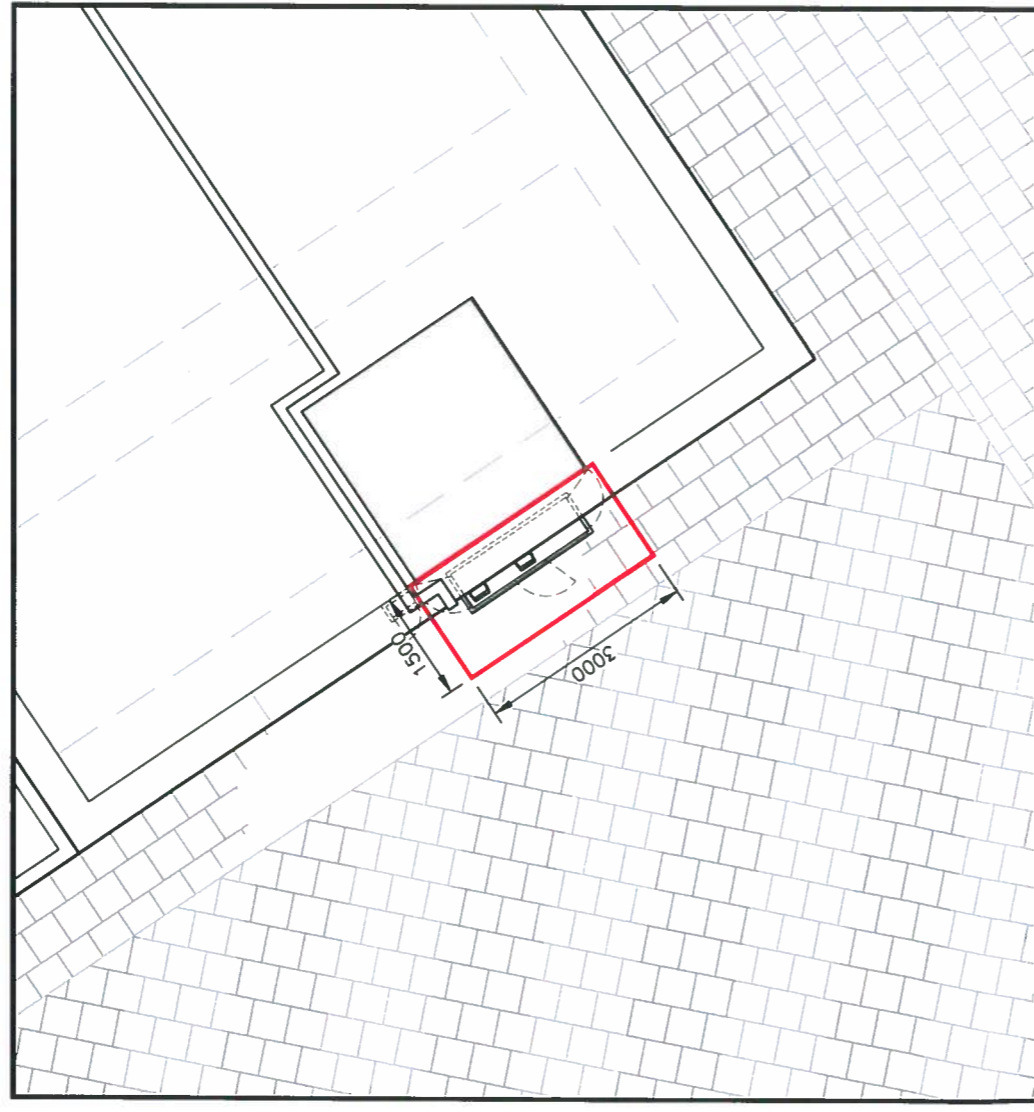

DETAILED SITE LOCATION (Scale 1:1250)

Based upon Ordnance Survey map extract with the permission of the Controller of Her Majesty's Stationery Office.  
 Crown copyright.  
 Licence No. 100020449

