

Plan at 1:10@A1

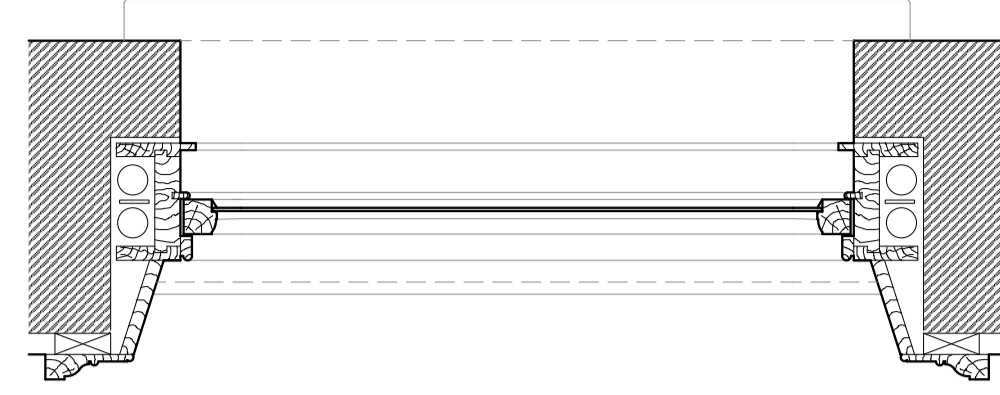

Plan at 1:10@A1

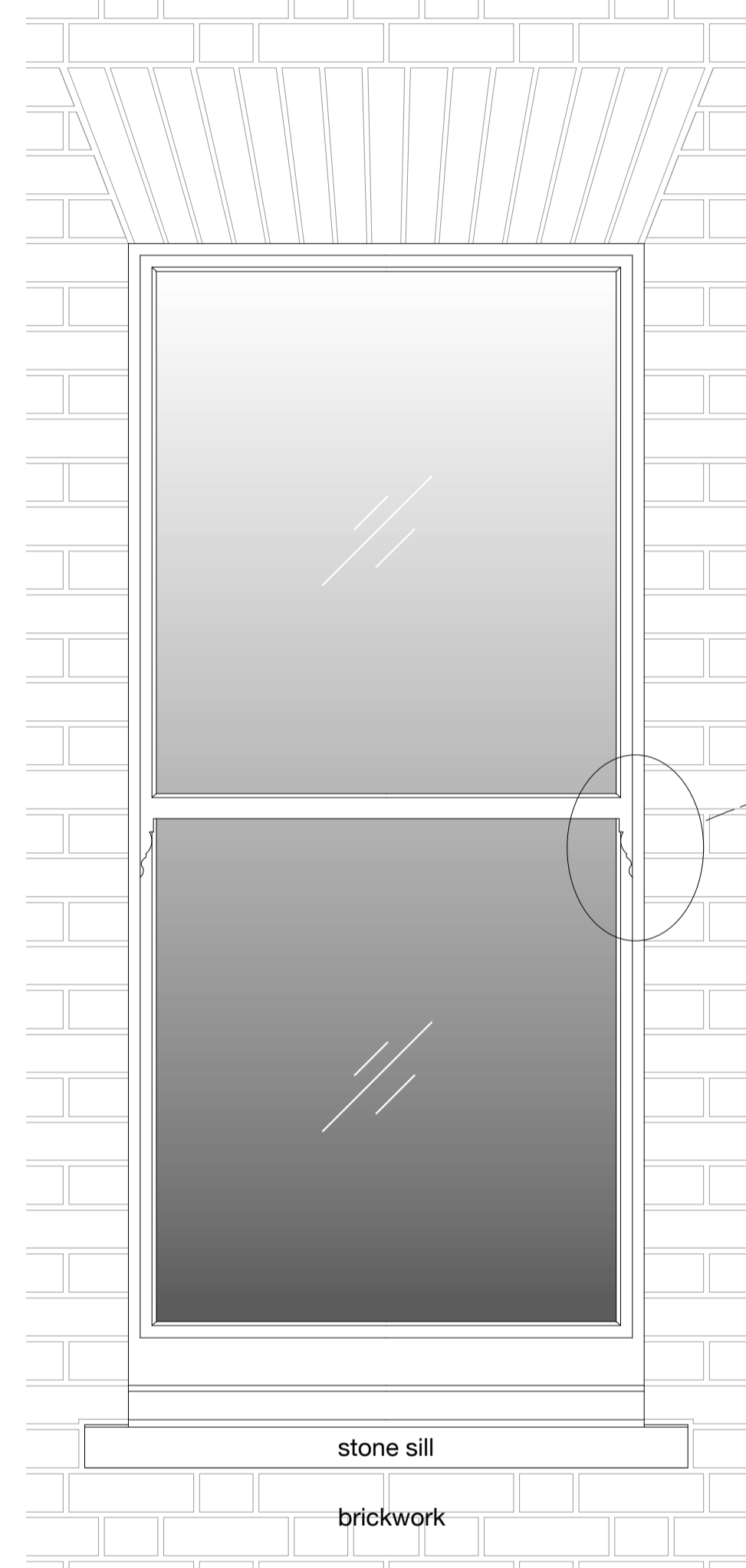

panelling to rear elevation windows W6, W7, W8 + W9 only. Front elevation windows W2, W3 + W4 have a plain panel here

External Elevation 1:10@A1

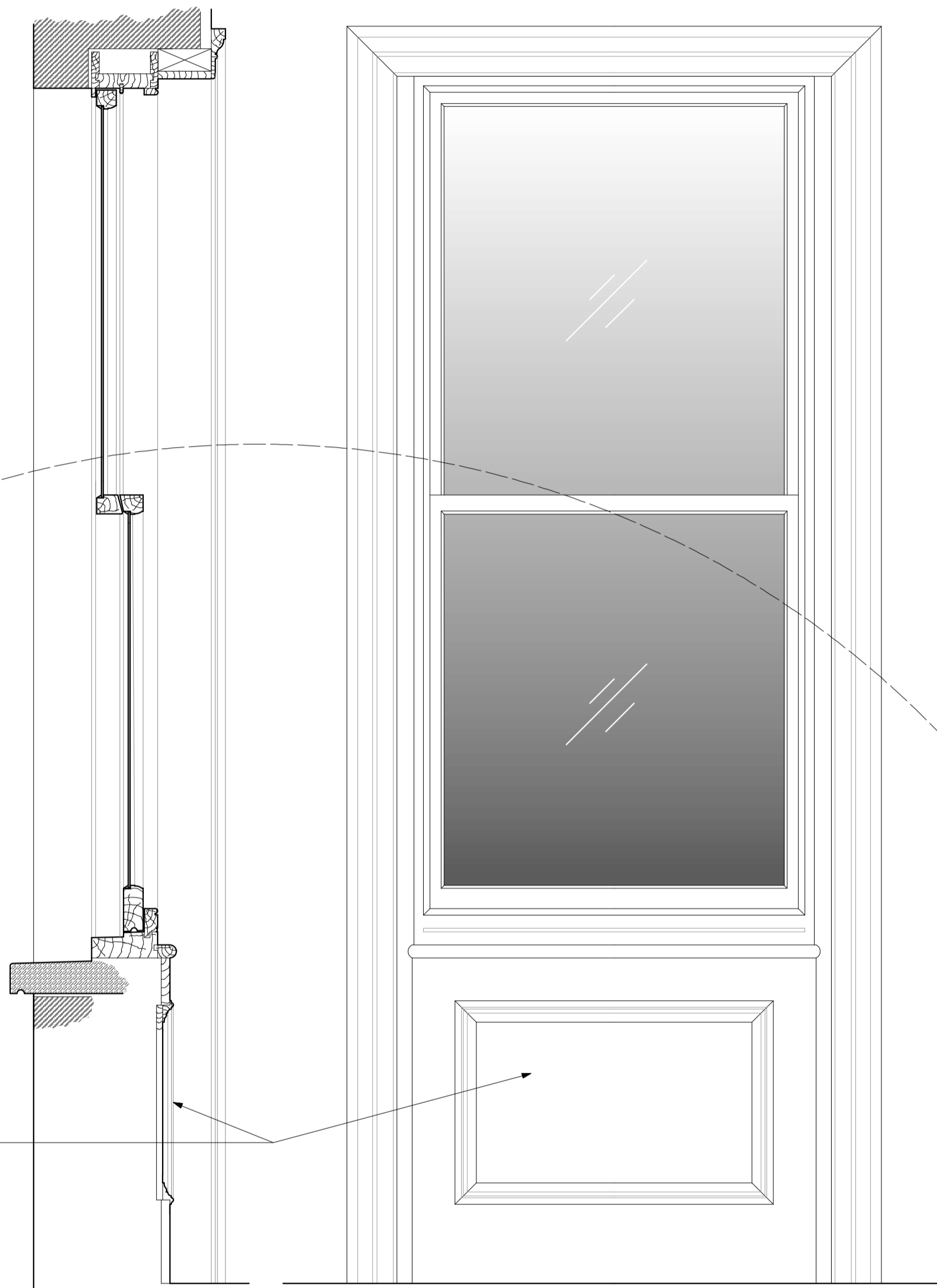
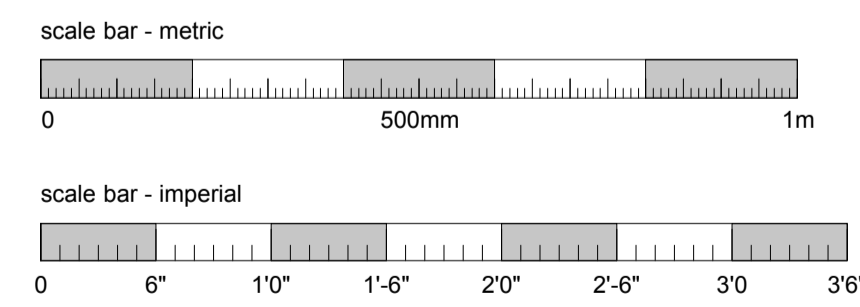

Section 1:10@A1

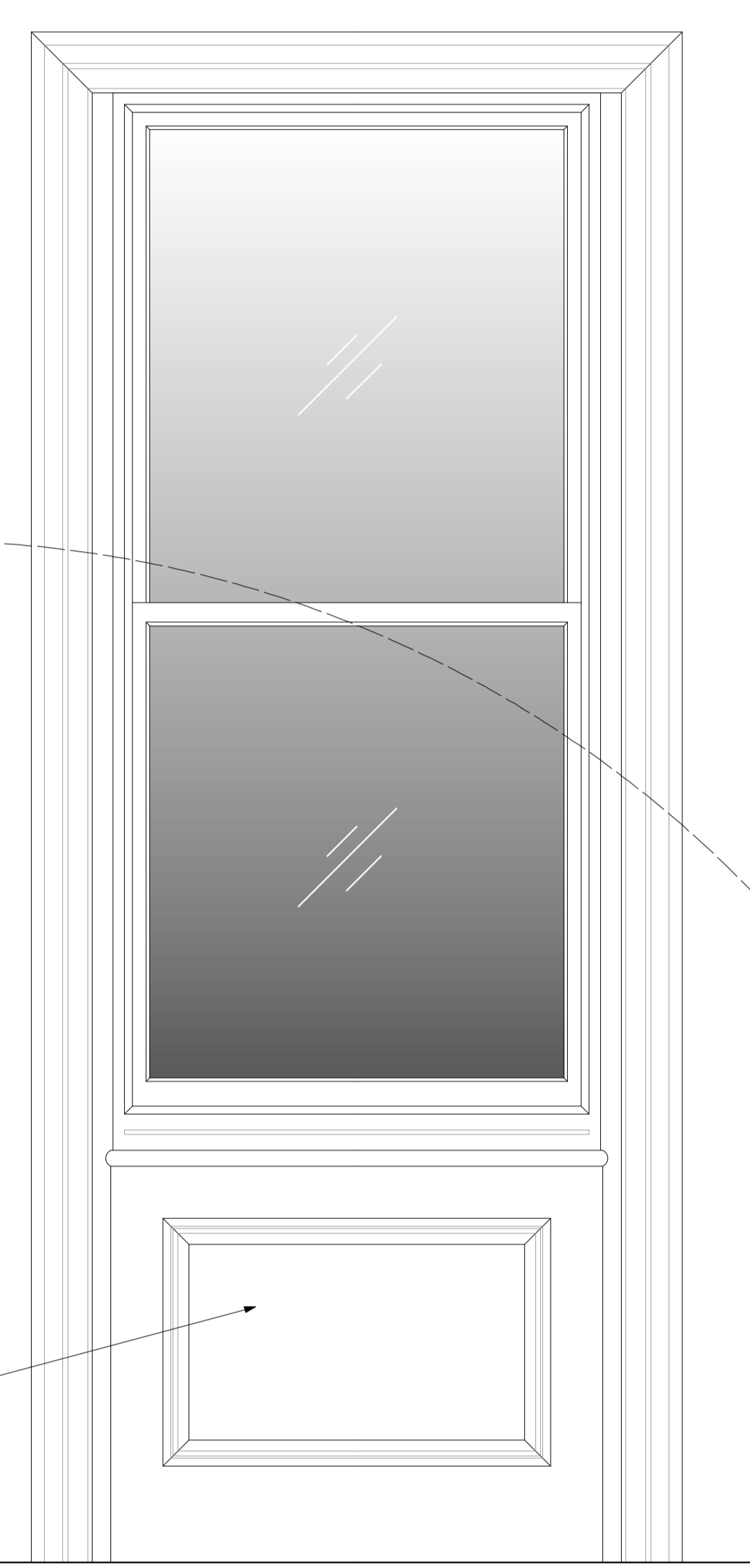

Internal Elevation 1:10@A1

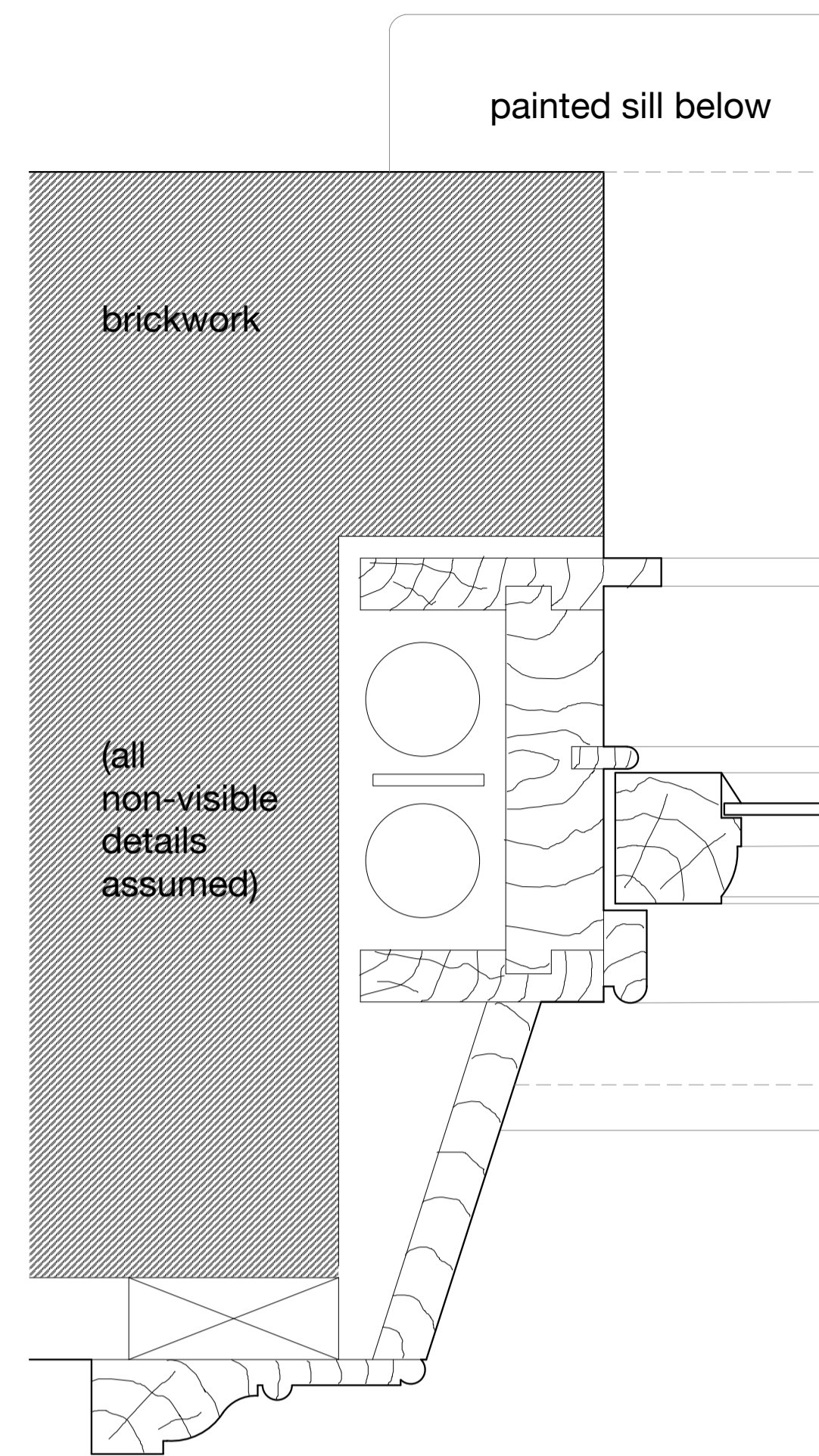
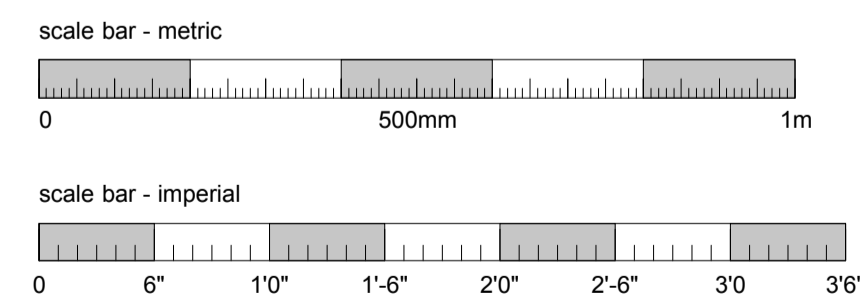

Plan Detail at Jamb 1:2@A1

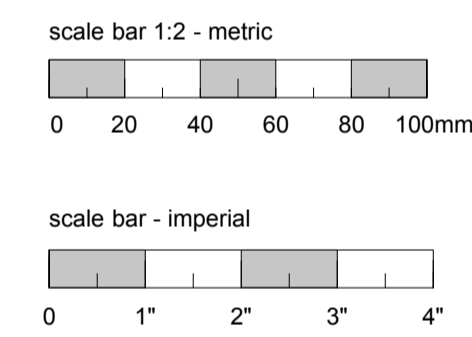

Sash Horn 1:2@A1

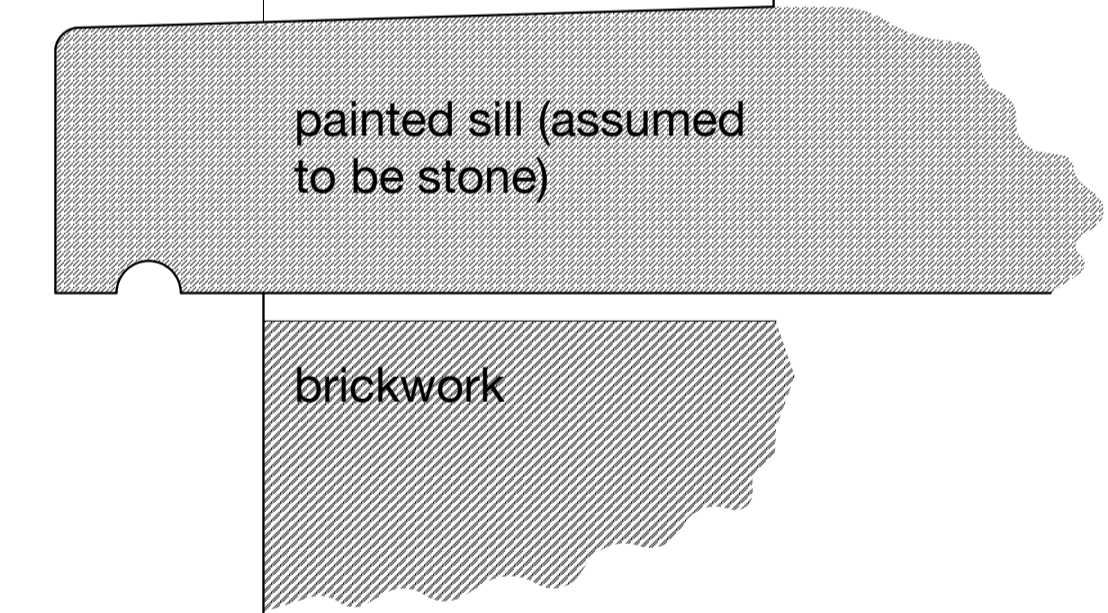
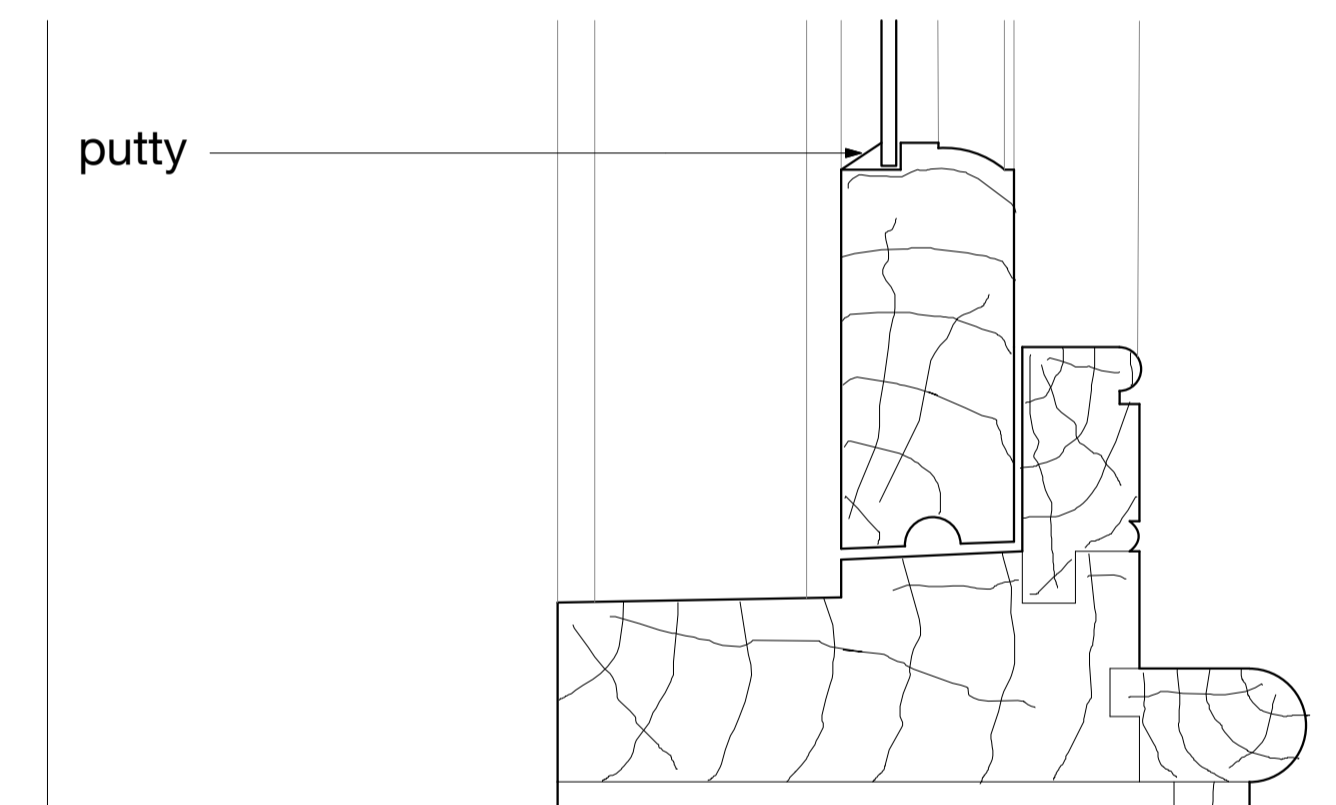
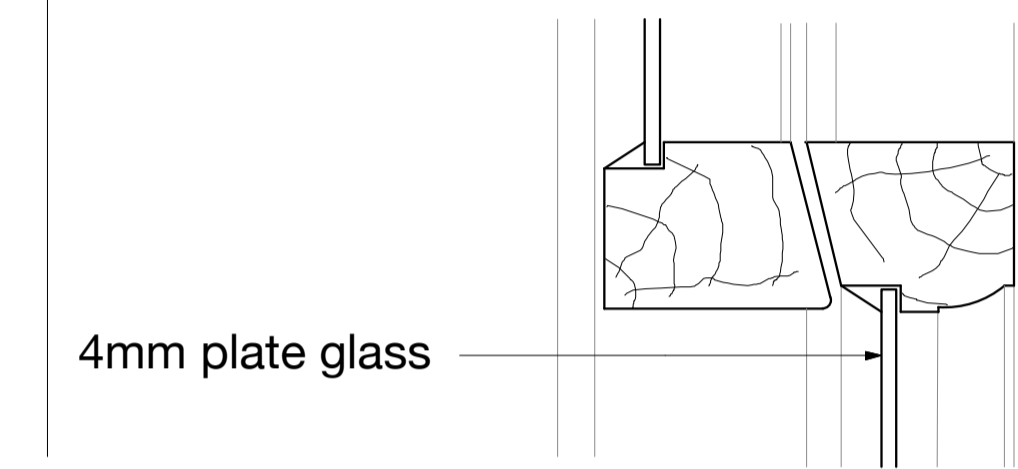
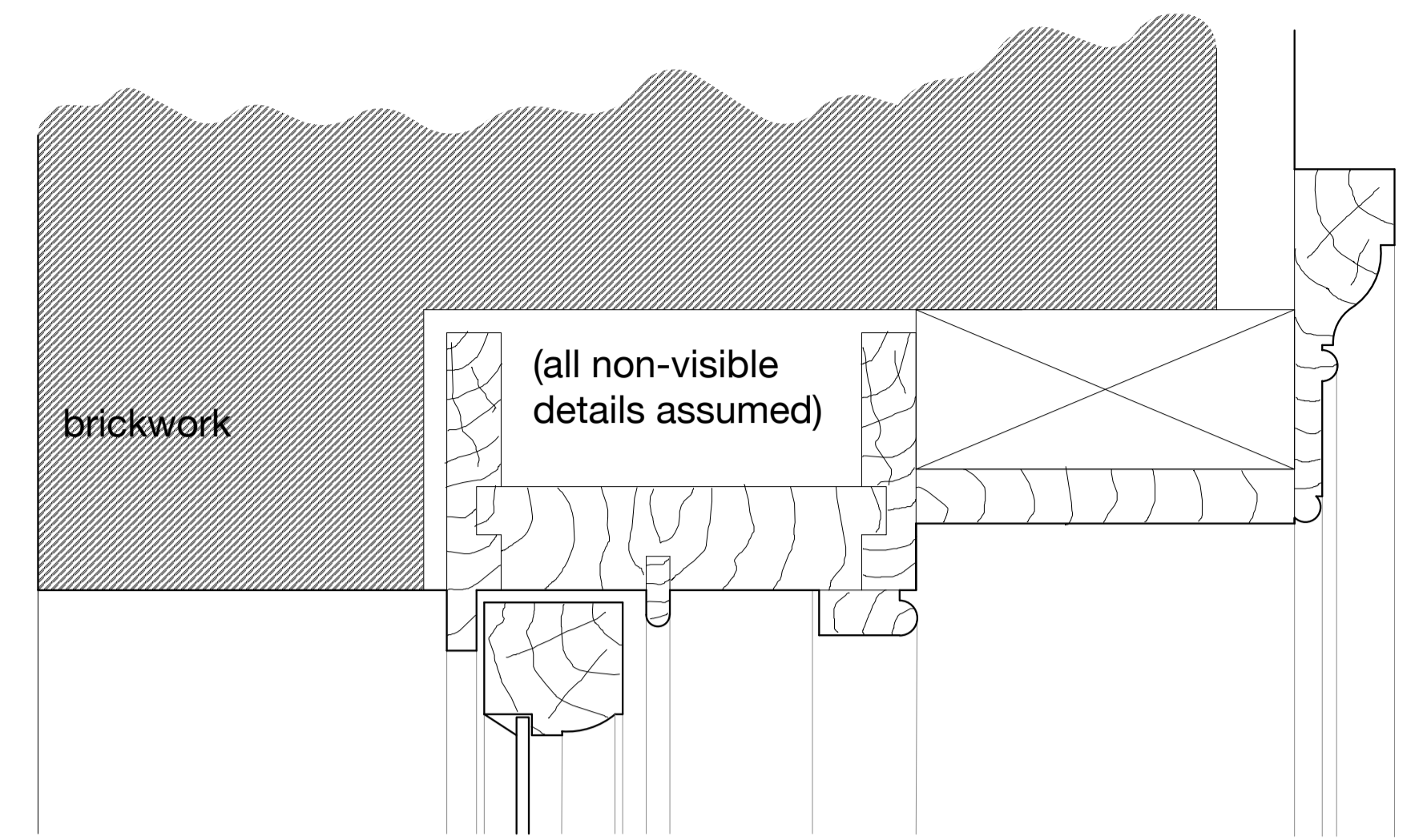
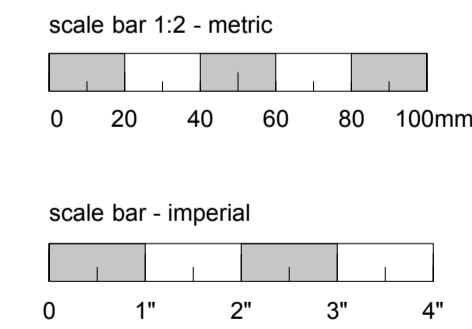

Vertical Section 1:2@A1

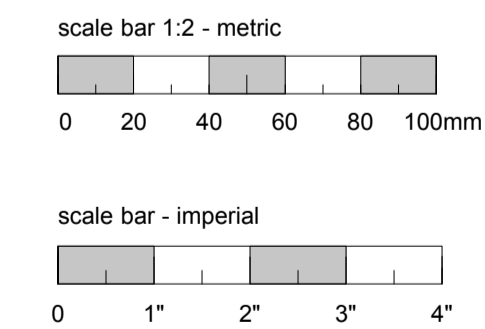

timber panelling (rear elevation windows W6, W7, W8 + W9 only)

BROD WIGHT Architects
43 England's Lane -- London -- NW3 4YD

Flat 1, 12 Lyndhurst Gardens, London NW3 5NR

www.brodwight.co.uk office@brodwight.co.uk
Tel 020 7722 0810 This drawing is copyright

Drawing Title:
Existing Sash Windows Enlarged Details

Drawing Ref:
1060-AP2-05

Date: 3rd August 2017 Scale: 1:2 + 1:10 @ A1