

Original veneered kitchen
cupboarding at high level to be
preserved.

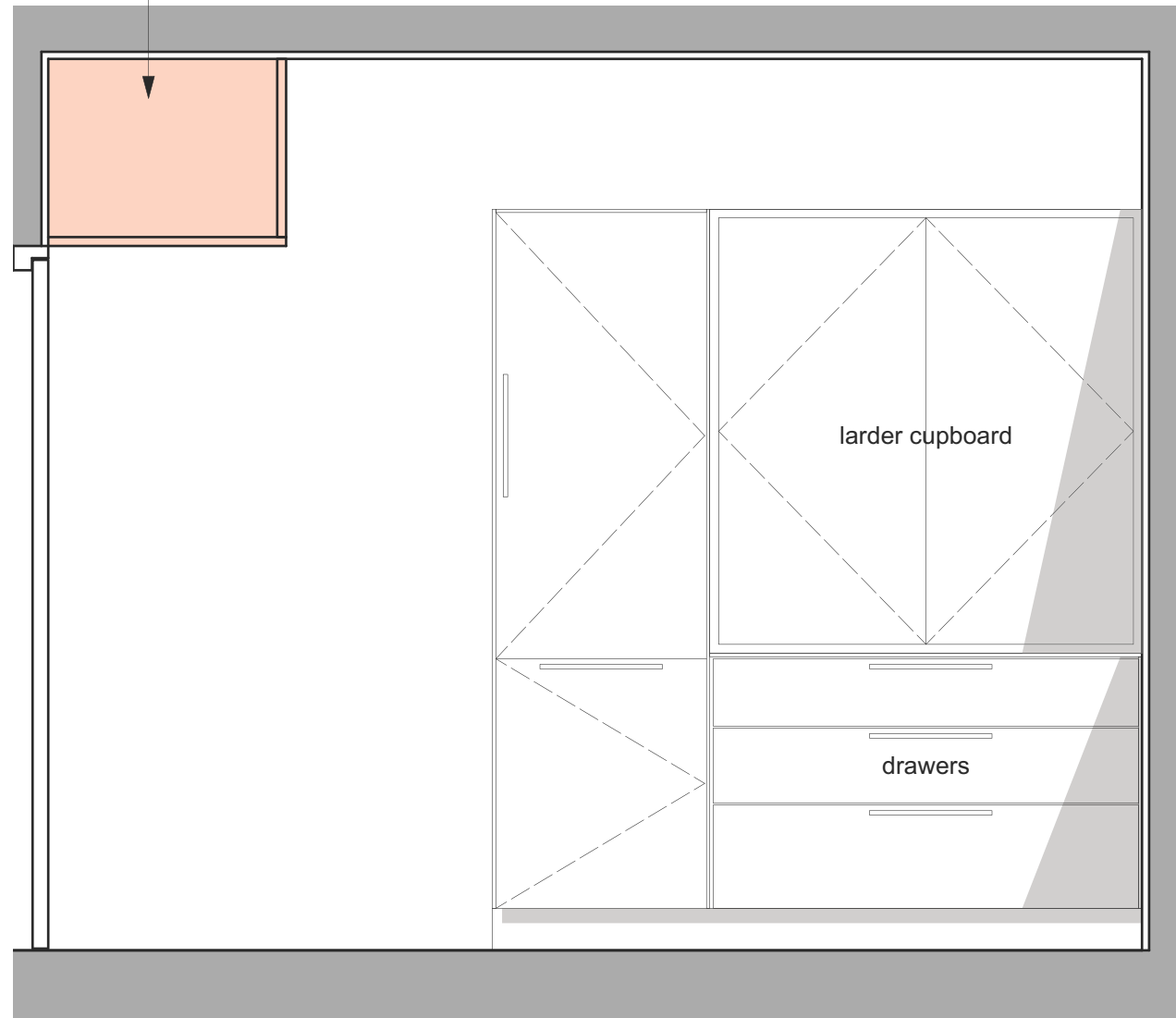

ELEVATION 3

Original veneered kitchen
cupboarding at high level to be
preserved.

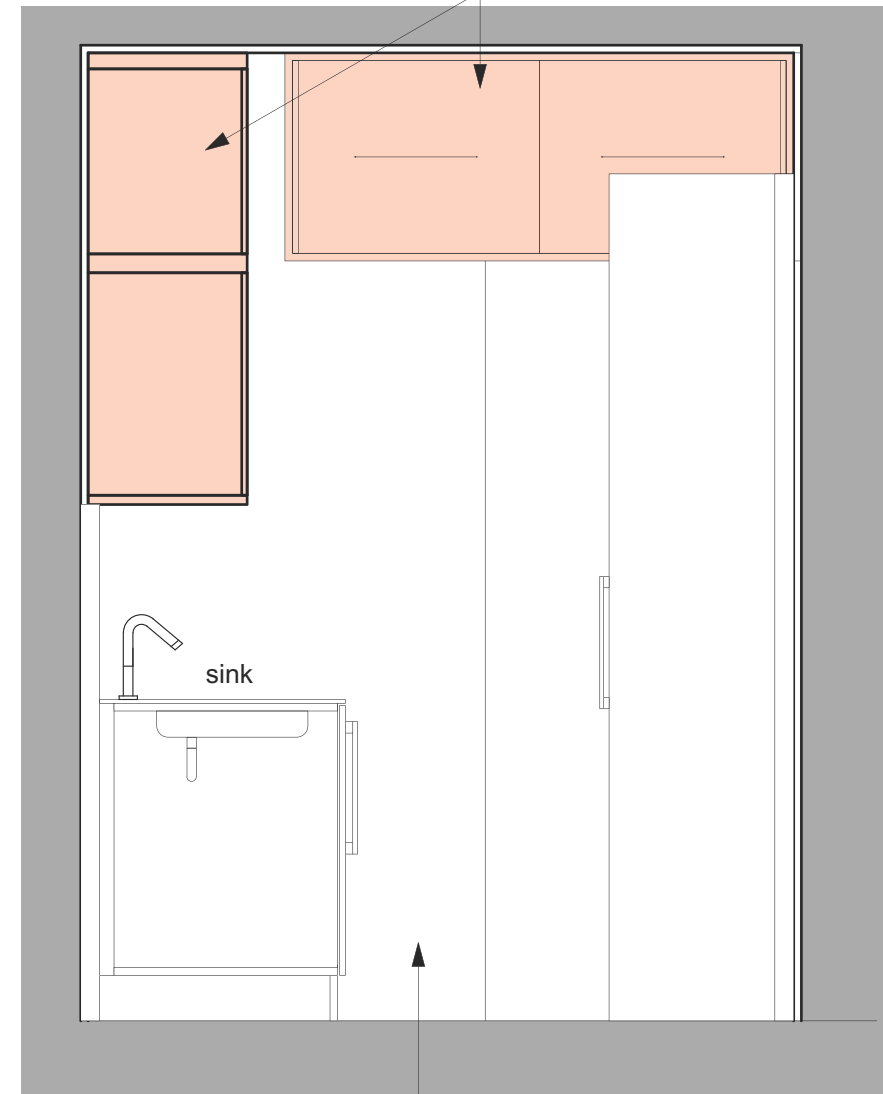





ELEVATION 4

CAD file ref:
THIS DRAWING IS © JETWEN BRIDGES ARCHITECTS LLP.
DO NOT SCALE OFF THIS DRAWING. ANY DIMENSIONS SHOWN MUST BE
CHECKED ON SITE BEFORE CONSTRUCTION OR MANUFACTURE

NOTES:

KEY:

-  Demolitions
-  Joinery items to be preserved
-  Cold water pipes
-  Hot water pipes
-  Waste pipes

Unknown pipe routes for hot and
cold water and waste within
bathroom.

REV	DATE	DESCRIPTION
A	15/05/2018	Cabinets adjusted to fit existing wall to dining room. PLANNING Substitution
-	26/02/2018	PLANNING SUBMISSION

PROJECT
10D REGENTS PARK ROAD
LONDON NW1 7TX

TITLE
**PROPOSED
KITCHEN ELEVATIONS - 2 of 2**

DRAWING STATUS
SURVEY

DRAWN: CHECKED: SCALED: 1:20 @ A3

DATE: 16/06/2017

JOB	DRAWING NUMBER	REVISION
J1168	P 103	A

53 Rawstorne Street T: 020 7837 1008
London EC1V 7NQ F: 020 7837 4008
Registered in England and Wales. Partnership No. OC 383122

SCALE 1:20 @ A3



PROPOSED KITCHEN SPEC TO INCLUDE:

- Balthup stainless steel worktops.
- White glass splashback.
- Doors / drawer fronts Bulthaup B3 laminate B8 - colour 'Gravel'.
- Interiors of new larder cupboard to have mahogany veneer to match listed cupboards.
- Slim Bulthaup LED light strip to be fixed under existing cupboards over sink.