

1:100 DRAWINGS COVERING THE FOLLOWING ZONES

ZONE A : DRAWING L-LG1-4100
 ZONE B : DRAWINGS L-LG1-4101 & L-LG1-4102
 ZONE C : DRAWING L-LG1-4103
 ZONE D : DRAWINGS L-LG1-4104 & SK-A-5053
 ZONE E : DRAWINGS SK-A-5054 & SK-A-5055
 ZONE F : DRAWING SK-A-5056

Project



COMMERCIAL IN CONFIDENCE
 Prepared For
UKCMRI Construction Ltd.

Project No: 08.33082.00

Key Plan

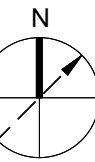
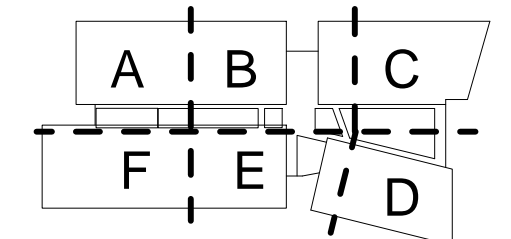

Do not scale dimensions from drawings
 Site verify all dimensions prior to construction
 Report all discrepancies to Architect immediately
 This drawing is to be read in conjunction with all relevant documents and drawings

Rev.	Description	Date	By
00	ISSUE TO LBC	31.07.12	GH
01	UPDATED AS INDICATED	07.11.12	GH
02	WESTERN PEDESTRIAN BYPASS GATE REMOVED EASTERN GATE REMOVED DROPOFF RENAMED MAINSTAIR PAVING NOTES DISABLED BAY LAYOUTS & PAVING SLOT DRAIN AND BOLLARDS ON MIDLAND ROAD ELEVATION SHIFTED, PLANTERS SHIFTED, LOADING BAY ENTRANCE & PAVING LAYOUT, 2No BOLLARDS OMITTED.	02.05.13	GH
03	UPLIGHTERS IN PLANTERS IN LBC LAND02.07.13 OMITTED, DISABLED BAY LAYOUTS REVISED, LOADING BAY LAYOUT REVISED SLOT DRAIN EXTENDED TO SOUTHERN BOUNDARY WALL	02.07.13	GH

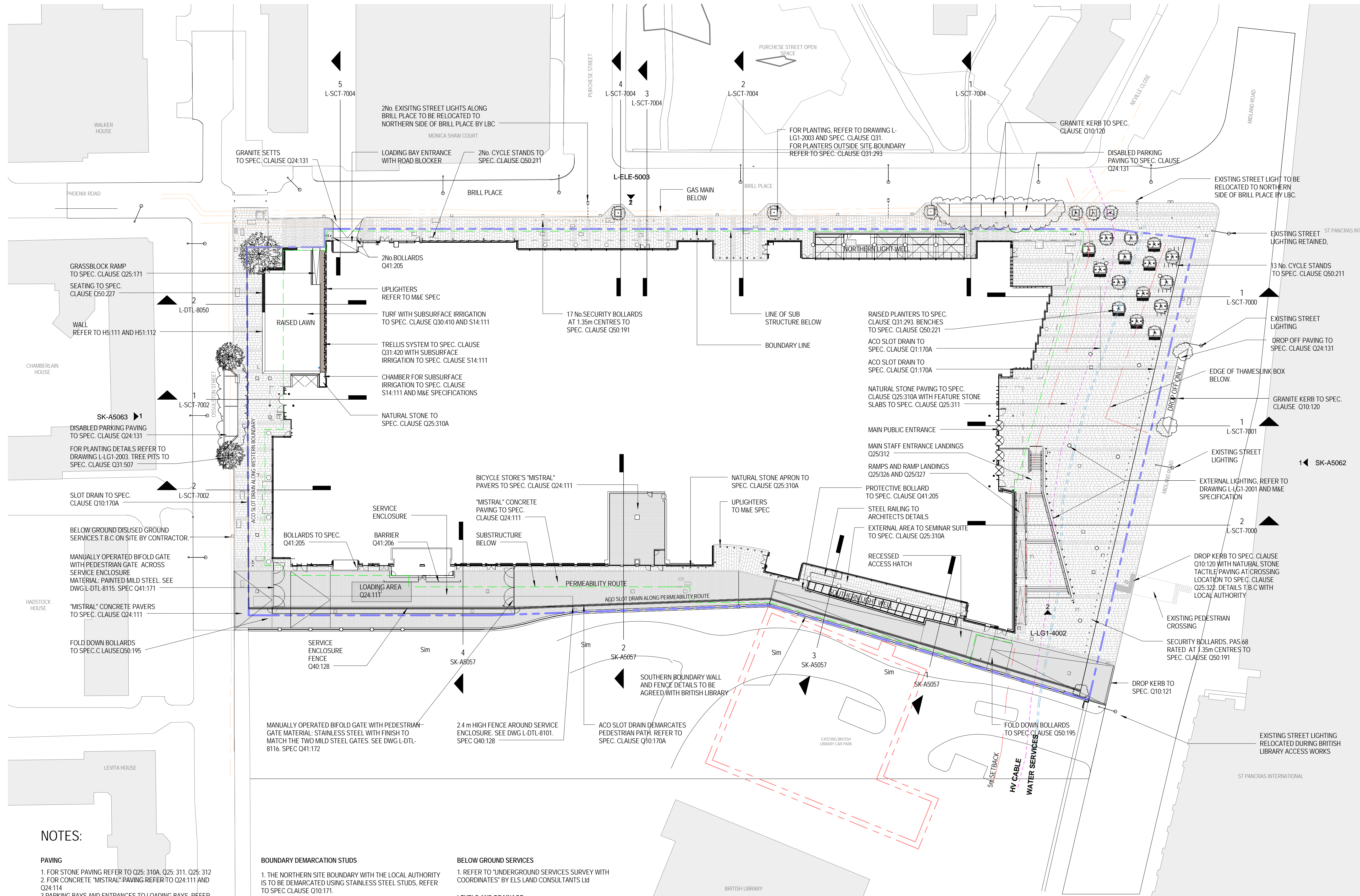

NOTES:

- PAVING**
- FOR STONE PAVING REFER TO Q25: 310A, Q25: 311, Q25: 312
 - FOR CONCRETE "MISTRAL" PAVING REFER TO Q24:111 AND Q24:114
 - PARKING BAYS AND ENTRANCES TO LOADING BAYS, REFER TO Q24: 131
- BOLLARDS**
- SECURITY BOLLARDS: Q50:191
 - FOLD DOWN BOLLARDS: Q50:195
- KERB**
- REFER TO Q10:120 AND Q10:121

- BOUNDARY DEMARCATION STUDS**
- THE NORTHERN SITE BOUNDARY WITH THE LOCAL AUTHORITY IS TO BE DEMARCATED USING STAINLESS STEEL STUDS, REFER TO SPEC CLAUSE Q10:171.
 - THE WESTERN AND EASTERN BOUNDARIES WITH THE LOCAL AUTHORITY TO BE DEMARCATED BY USING THE SLOT DRAIN AS THE LINE OF DEMARCATION.

- BELOW GROUND SERVICES**
- REFER TO "UNDERGROUND SERVICES SURVEY WITH COORDINATES" BY ELS LAND CONSULTANTS Ltd
- LEVELS AND DRAINAGE**
- REFER TO L-LG1-2002
 - ALL EXISTING AND NEW MANHOLES TO HAVE RECESSED COVERS U.N.O WITH STONE/PAVER TOP FINISH TO MATCH SURROUNDING PAVING.
- EXTERNAL LIGHTING**
- REFER TO M&E CONSULTANTS DRAWINGS FOR TECHNICAL SPECIFICATION

Drawn by: GH Reviewed by: LM
 Drawn Date: 27.07.12 Scale @ A1: 1 : 400

Project No: 08.33082.00

Sheet Title:
**LANDSCAPE
 GROUND LEVEL GA
 PLAN**

Sheet Number: SK-A5050 Revision: 03

02/07/2013 17:16:32