

Do not scale from this drawing. Verify all dimensions on site. Drawing should be read in conjunction with information from all other design consultants and contractors. All drawings in digital format are for reference only, paper copies are available on request.

FOR PLANNING

© Maccreanor Lavington Ltd.

MATERIALS KEY

1. Facing brick "Synthesis S21 - Richmond Blend" by "Freshfield Lane", laid in horizontal stretcher bond with Black-Grey colour mortar joint, "Tarma" colour ref: Y2 Medium.
2. Facing brick "Synthesis S21 - Richmond Blend" by "Freshfield Lane", laid in vertical stretcher bond with Black-Grey colour mortar joint, "Tarmac" colour ref: Y2 Medium.
3. Brick sill featuring "Synthesis S21 - Richmond Blend" brick by "Freshfield Lane".
4. Brick slip clad lintel featuring "Synthesis S21 - Richmond Blend" brick by "Freshfield Lane".
5. Brick slip clad soffit panel featuring "Synthesis S21 - Richmond Blend" brick by "Freshfield Lane", or similar approved.
6. Portland Stone reconstituted stone window sills and parapet copings.
7. Outward opening anodized aluminium windows, finish ref: Anolok 549 Dark Bronze.
8. Anodized aluminium door frames, finish ref: Anolok 549 Dark Bronze.
9. Steel louvered doors, polyester powder coated, matt, RAL 8080.
10. Polyester powder coated steel balustrades, finish matt, RAL 8080.
11. Polyester powder coated stainless steel signage, finish matt, RAL 8080.
12. Polyester powder coated steel gates, finish matt, RAL 8080.
13. Anodized aluminium acoustic louvres, finish ref: Anolok 549 Dark Bronze.



WORKSPACE SOUTH ELEVATION

For proposed landscape information refer to JCLA landscape drawings submitted as part of this planning application

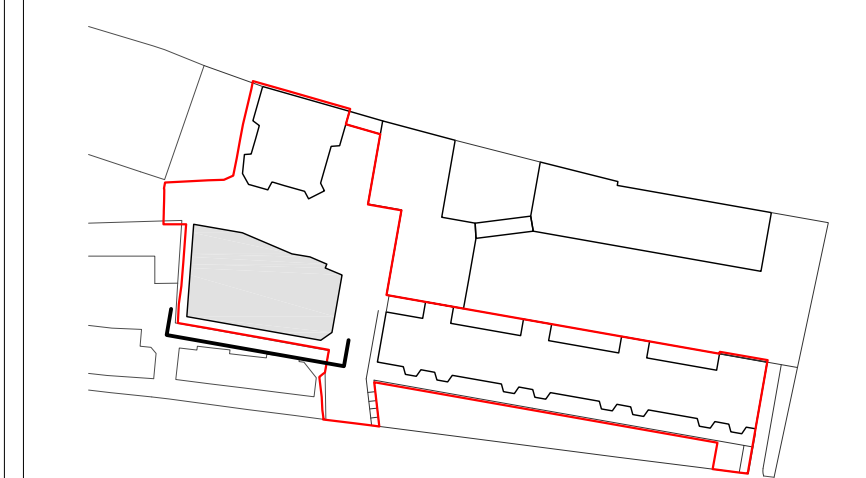

| Rev | Details | CGP | 20/04/18 |
|-----|---------------------|------|----------|
| A | Planning amendments | | |
| | | CGP | 20/04/18 |
| | | Drwn | Date |

Application 02 Expansion of Kingsgate Primary School & Redevelopment of Liddell Road Phase 02

Client: London Borough of Camden
 Title: Workspace
 South Elevation
 Scale: 1:100 @ A1 / 1:200 @ A3
 Date: 01-12-2014 Drawn: MJR

MLA / 403 / P2 / 342 / Rev A

MaccreanorLavington

3rd Floor
 19-21 Nile Street
 London N1 7LL

t +44(0)207 336 73 53
 f +44(0)207 336 76 55
 e uk@ml-architects.com

