

LONDON BOROUGH OF CAMDEN
TOWN AND COUNTRY PLANNING ACTS
14 MAR 1990
PLANS APPROVED
ON BEHALF OF THE COUNCIL

8900374R

LONDON BOROUGH OF CAMDEN
PLANNING AND TRANSPORT
DEPARTMENT
14 MAR 1990
RECEIVED

AVIATION HOUSE, WC2
Ground Floor Plan
1:200
Sheppard Robson
77 Parkway, NW1 Architects
1193/P102

210 High Holborn

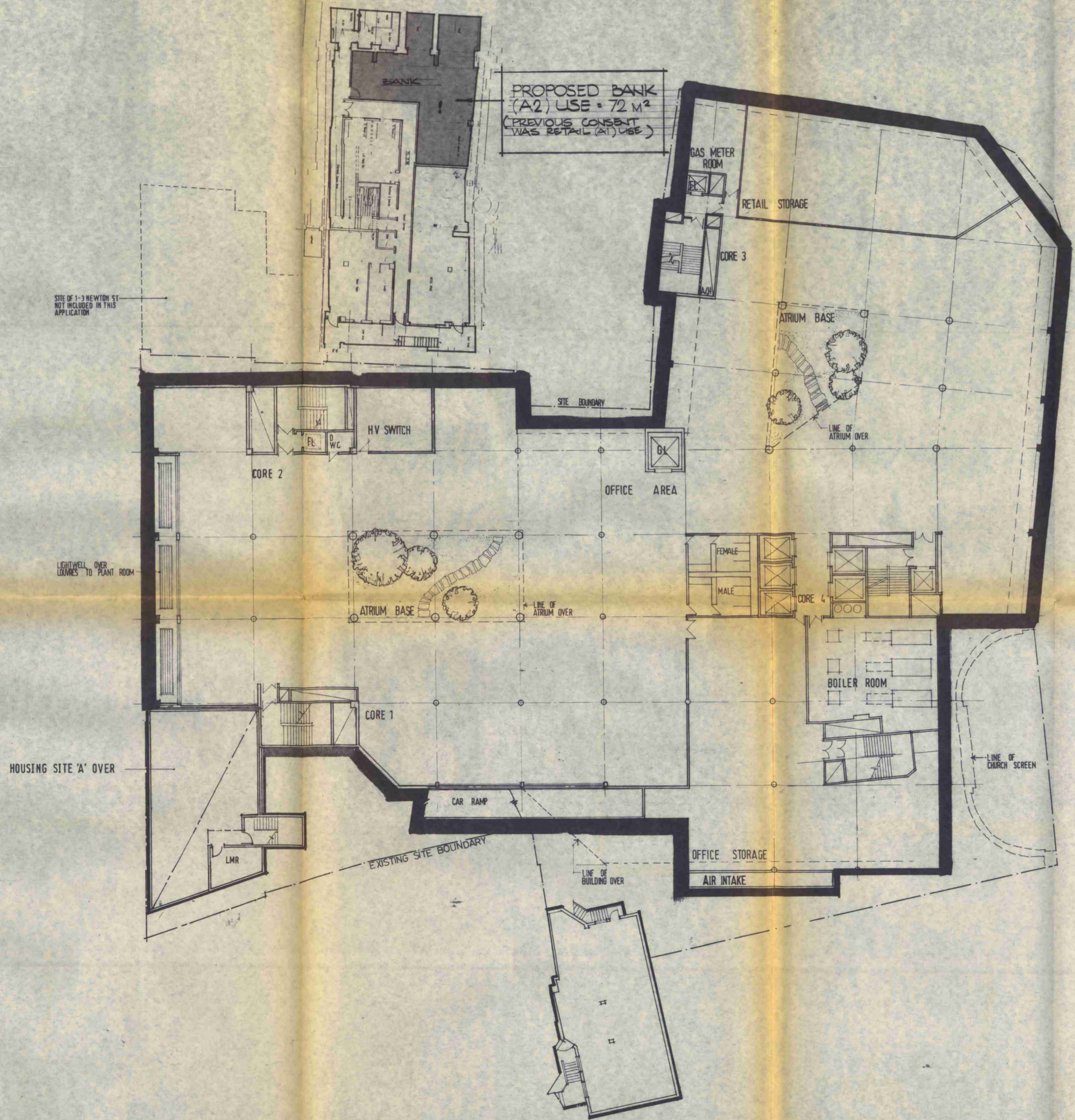

LONDON BOROUGH OF CAMDEN
TOWN AND COUNTRY PLANNING ACTS
14 MAR 1990
PLANS APPROVED
ON BEHALF OF THE COUNCIL

LONDON BOROUGH OF CAMDEN
PLANNING AND TRANSPORT
DEPARTMENT
14 MAR 1990
RECEIVED

8900374R1

AVIATION HOUSE, WC2
Lower Ground Floor Plan 1:200
Sheppard Robson
77 Parkway, NW1 Architects 1193/P 103

NEWTON STREET

HIGH HOLBORN

1A SOUTHAMPTON ROW

GUARDIAN BUILDING SOCIETY

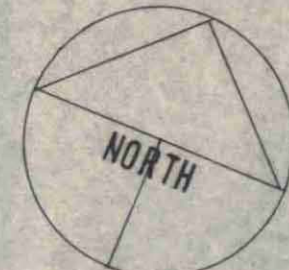
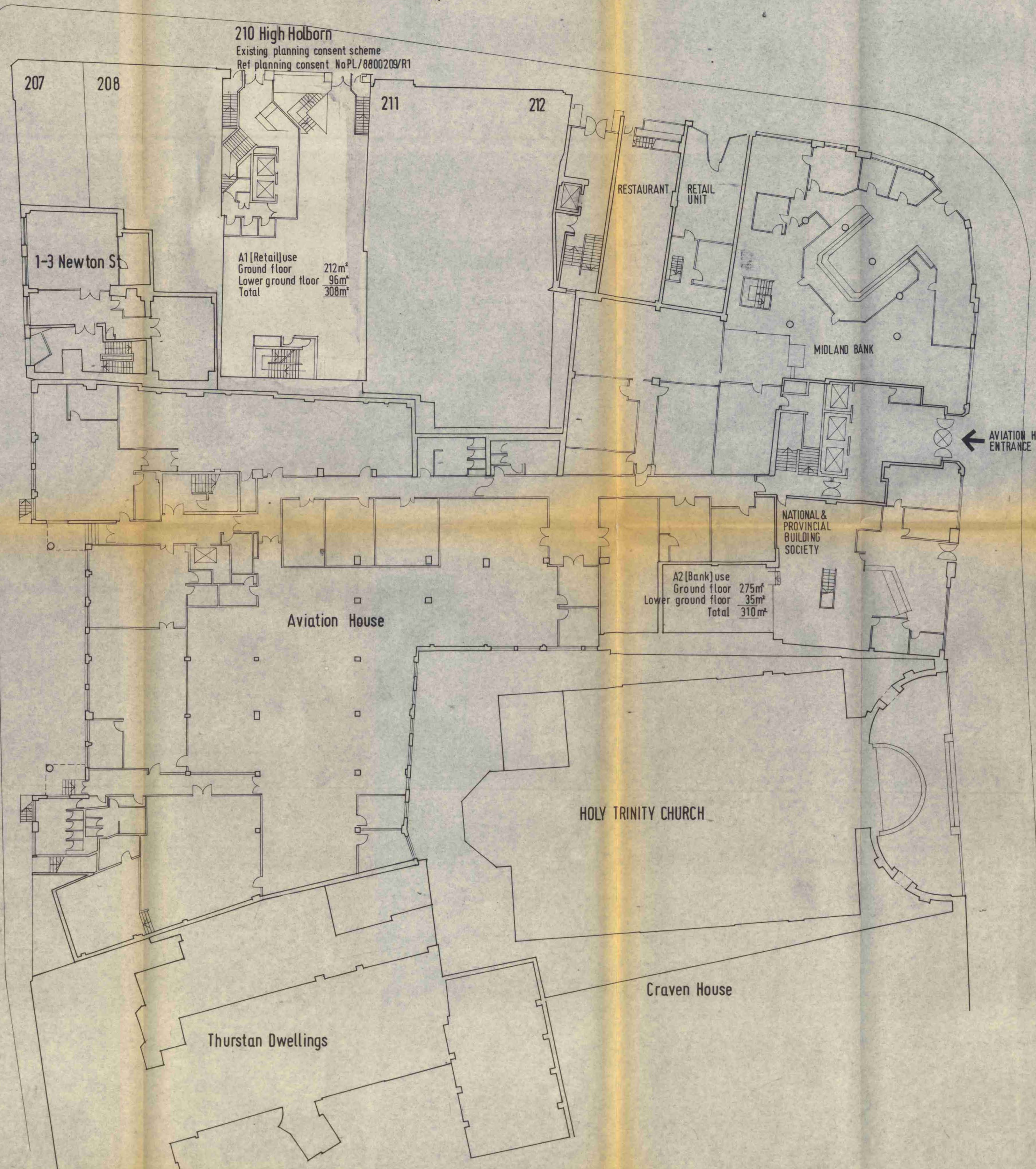

HOLBORN LRT STATION

HOLBORN LRT STATION

LONDON BOROUGH OF CAMDEN
 PLANNING AND TRANSPORT
 DEPARTMENT
 2 AUG 1989
 RECEIVED

LONDON BOROUGH OF CAMDEN
 TOWN AND COUNTRY PLANNING ACTS
 14 MAR 1990
 PLANS APPROVED
 ON BEHALF OF THE COUNCIL

8900374

AVIATION HOUSE , WC2
 210 HIGH HOLBORN: EXISTING PLANNING CONSENT USES
 Sheppard Robson Architects
 77 Parkway, NW1 1193/P029

1:200
 1193/P029