

- Detail Notes
- 01 Timber studwork
 - 02 Plywood (NBS Section K1)
 - 03 Steelwork (Refer to SE Information)
 - 04 Rigid insulation (NBS Section P10)
 - 05 Brickwork (NBS Section F10)
 - 06 Brick slips (NBS Section F10)
 - 07 Damp proof membrane (NBS Section F10)
 - 08 Raised Floor (Refer to Floor Types Drawings)
 - 09 Internal wall lining (Refer to Wall Types Drawings)
 - 10 Suspended plasterboard ceiling (NBS Section K10)
 - 11 Standing seam zinc roofing (NBS Section H74)
 - 12 Steel Framing System (NBS Section G10)
 - 13 Timber joist (Refer to SE Information)
 - 14 Plasterboard (NBS Section K10)
 - 15 Liquid applied membrane (NBS Section J31 / J40)
 - 16 Drainage gully (NBS Section J31 / J40)
 - 17 Pressed zinc flashing (to Contractor's design) (NBS Section H72)
 - 18 Pressed zinc trim (to Contractor's design) (NBS Section H72)
 - 19 Internal glazed fire-resistant screen (NBS L10)
 - 20 Fixing strap to Manufacturer's requirements
 - 21 Secondary steel for window framing
 - 22 Window (NBS Section L10) (Refer to Window Schedule)
 - 23 Fascia board (NBS K1)
 - 24 Pea gravel (NBS J31)
 - 25 Substrate (NBS Section G28)
 - 26 Gutter (NBS Section R10)
 - 27 Drainage Layer (NBS Section G37)
 - 28 Breather membrane (NBS Section J10 / J31 / J40 / J30)
 - 29 Zinc coping (NBS H72)
 - 30 Support Frame (NBS Section K10)
 - 31 Steel Deck (NBS Section G10)
 - 32 In-situ Concrete
 - 33 Blockwork (NBS Section F10)
 - 34 Screed (NBS Section M10)
 - 35 Mineral Wool Insulation (NBS Section P10)
 - 36 Vapour Control Layer
 - 37 Metal Roof Deck (Refer to SE Information)
 - 38 Roofing Underlay
 - 39 Fibre Cement Sheet
 - 40 Root Resistant Capping Sheet (Refer Bauder Specification)
 - 41 Protection Fleece (Refer Bauder Specification)
 - 42 DSE40 Drainage Board / 40mm (Refer Bauder Specification)
 - 43 Filter Fleece (Refer Bauder Specification)
 - 44 Extensive Substrate (Refer Bauder Specification)
 - 45 Wkllower Blanket (Refer Bauder Specification)
 - 46 Metal Retention Angle AL150 (Refer Bauder Specification)

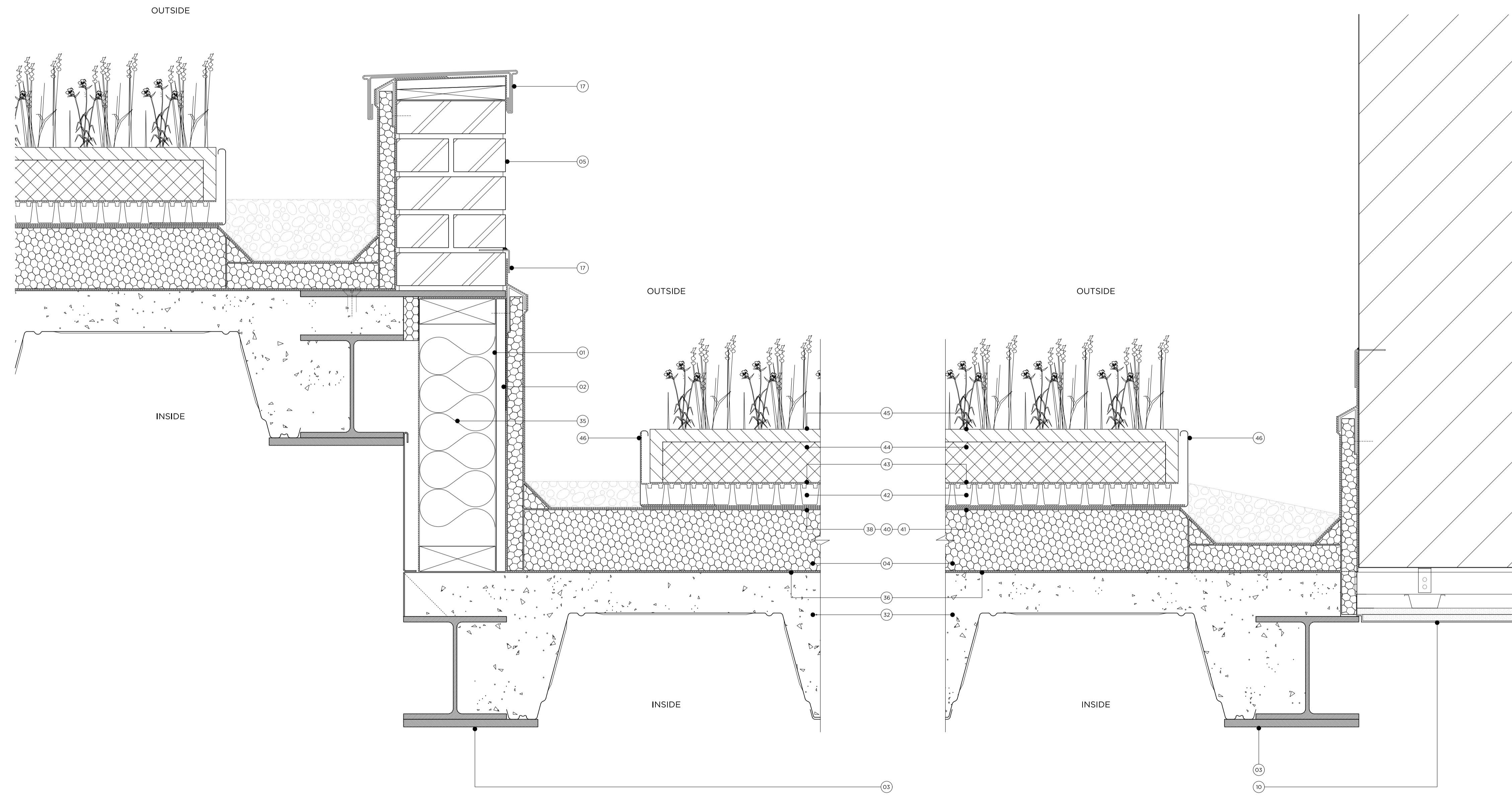

400_102_01 Terraced Sedum Roof Detail 1:5

400_102_02 Sedum Roof / Party Wall Junction 1:5

Rev T1 20.11.17 Issued for Tender

TENDER

Project No. **16038**

Client **Balcap Re Ltd**

Date **November 2017**

Scale **1:5@A1 / 1:10@A3**

Project **Land to Rear of 159-163 Kings Cross Road**

Drawing Title: **Section A-A Details 02**

Drawing No. 400_102	Rev. T1
Drawn SW	Approved AB
	Signed TB



66 - 68 Margaret Street WIV 8SR T. 020 7580 9336 www.mwa.co.uk

Copyright Marek Wojciechowski Architects. No implied license exists. This drawing should not be used to calculate areas for the purposes of valuation. All dimensions to be checked on site by the contractor and such dimensions to be their responsibility. Do not scale drawings. All work must comply with relevant British Standards and Building Regulations requirements. Drawing errors and omissions to be reported to the architect.

