

S4

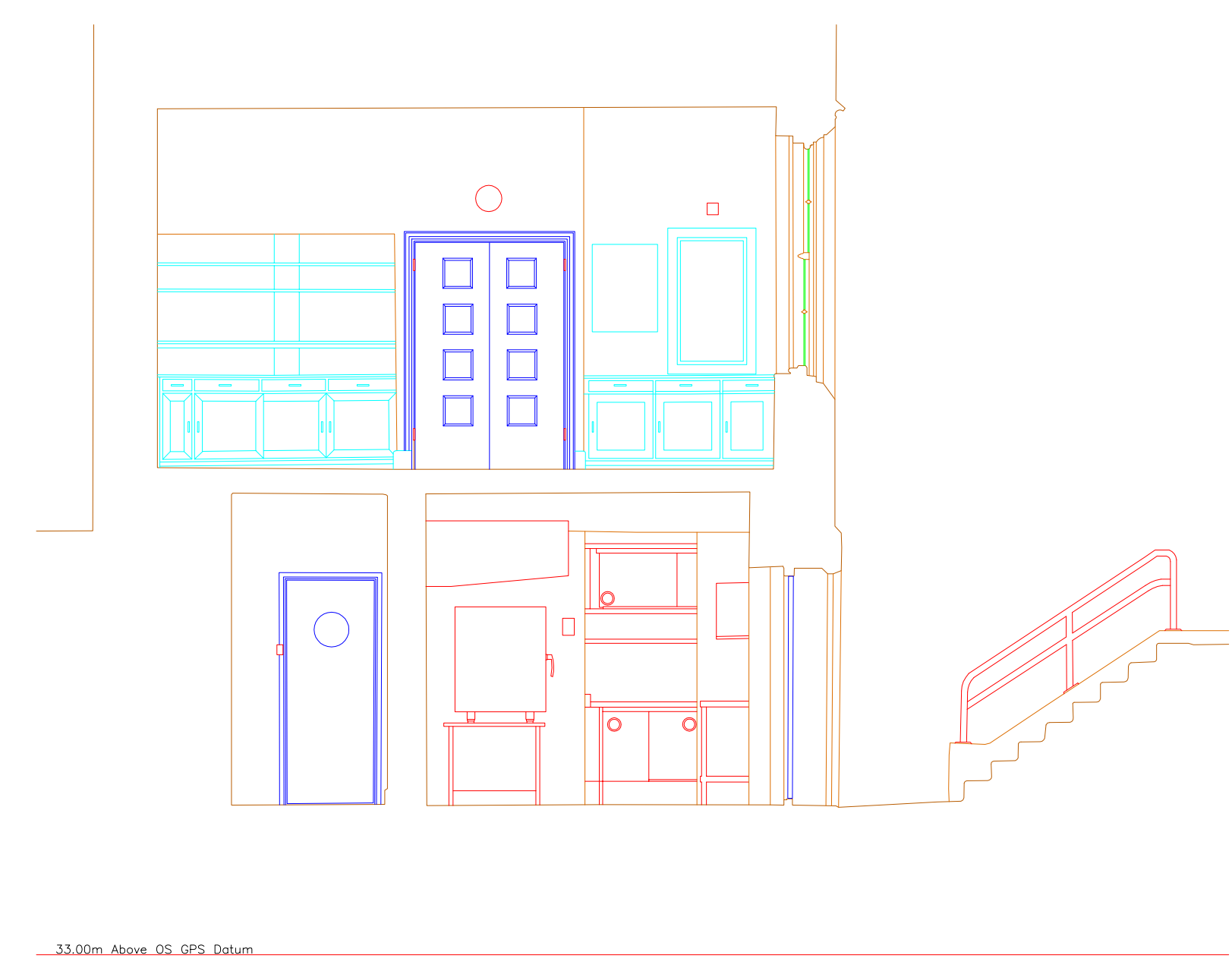

S5



S6

33.00m Above OS GPS Datum

33.00m Above OS GPS Datum

33.00m Above OS GPS Datum

<p><b>Legend:</b></p> <p>Stair/ slope arrows point up</p> <p>Direction of floor boards</p> <p>Direction of roof slope (up)</p> <p>Floor to Ceiling Height</p>	<p><b>Site Grid and Vertical Datum:</b></p> <p>All levels are in metres, related to OS GPS datum</p> <p><b>Notes:</b></p> <p>This survey has been carried out to an accuracy consistent with a scale of 1:50</p> <p>Drawing units are millimetres.</p>	<p><b>Key:</b></p> <table border="0"> <tr><td>AL</td><td>Arch height</td></tr> <tr><td>BL</td><td>Beam level</td></tr> <tr><td>CL</td><td>Ceiling level</td></tr> <tr><td>EGS</td><td>Electrical Switch Gear</td></tr> <tr><td>H</td><td>Window head level</td></tr> <tr><td>RWP</td><td>Rain Water Pipe</td></tr> <tr><td>SH</td><td>Arch spring height</td></tr> <tr><td>S</td><td>Window sill level</td></tr> <tr><td>sh</td><td>Sill to window head height</td></tr> </table>	AL	Arch height	BL	Beam level	CL	Ceiling level	EGS	Electrical Switch Gear	H	Window head level	RWP	Rain Water Pipe	SH	Arch spring height	S	Window sill level	sh	Sill to window head height
AL	Arch height																			
BL	Beam level																			
CL	Ceiling level																			
EGS	Electrical Switch Gear																			
H	Window head level																			
RWP	Rain Water Pipe																			
SH	Arch spring height																			
S	Window sill level																			
sh	Sill to window head height																			

St Katherine's Danish Church, Regents Park, London  
Section 4, 5 & 6



**SURVEYED & DRAWN BY:**  
James Brennan Associates  
Chartered Surveyors  
www.jbrennanassociates.co.uk  
UNIT 6 WARREN HOUSE,  
DEEPDALE BUSINESS PARK  
ASHFORD RD, BAKEWELL DE45 1GT  
TEL: 01629 814654  
EMAIL: mail@jbrennanassociates.co.uk

**Architect:**  
C.F. MOLLER  
Metropolitan Wharf,  
70 Wapping Wall,  
London,  
E1W 3SS  
Tel +44 (0)207 4271530

**Client:**

Drawing no.16-82-SECT-02  
Issue date MARCH 2017  
Issue status B  
Scale 1:50@ A1