

01 Front View

02 Side View

TECHNICAL DESCRIPTION

The digital screen are supported on a secondary steelwork frame that is fixed onto the existing vent shaft structure. This structural solution would avoid introducing vertical columns in front of the vent shaft, therefore there would be no impact on the architectural appearance of the proposal and no impact on the existing functionality of the space around the vent shafts.

The screen will be a high quality 8mm pitch, RGB color and brightness will be maximum 300cd/m.

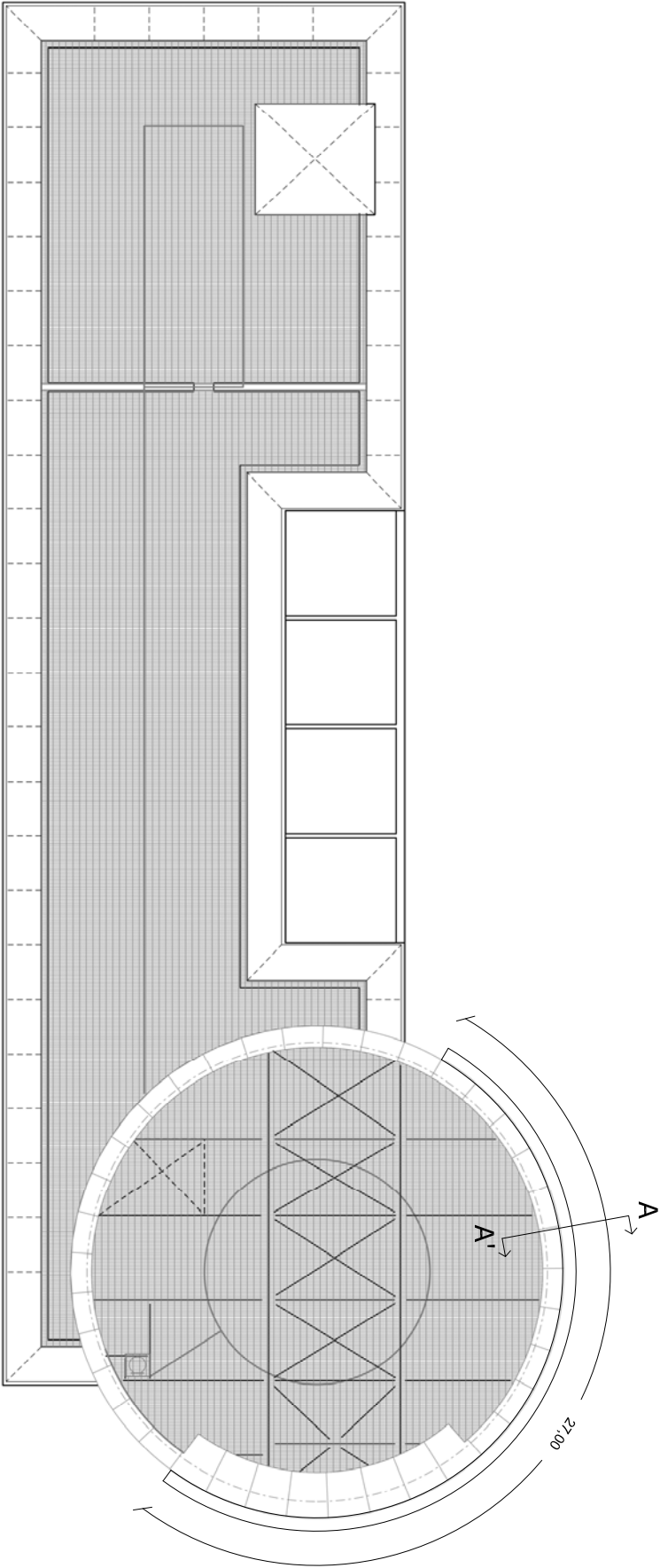

03 Plan

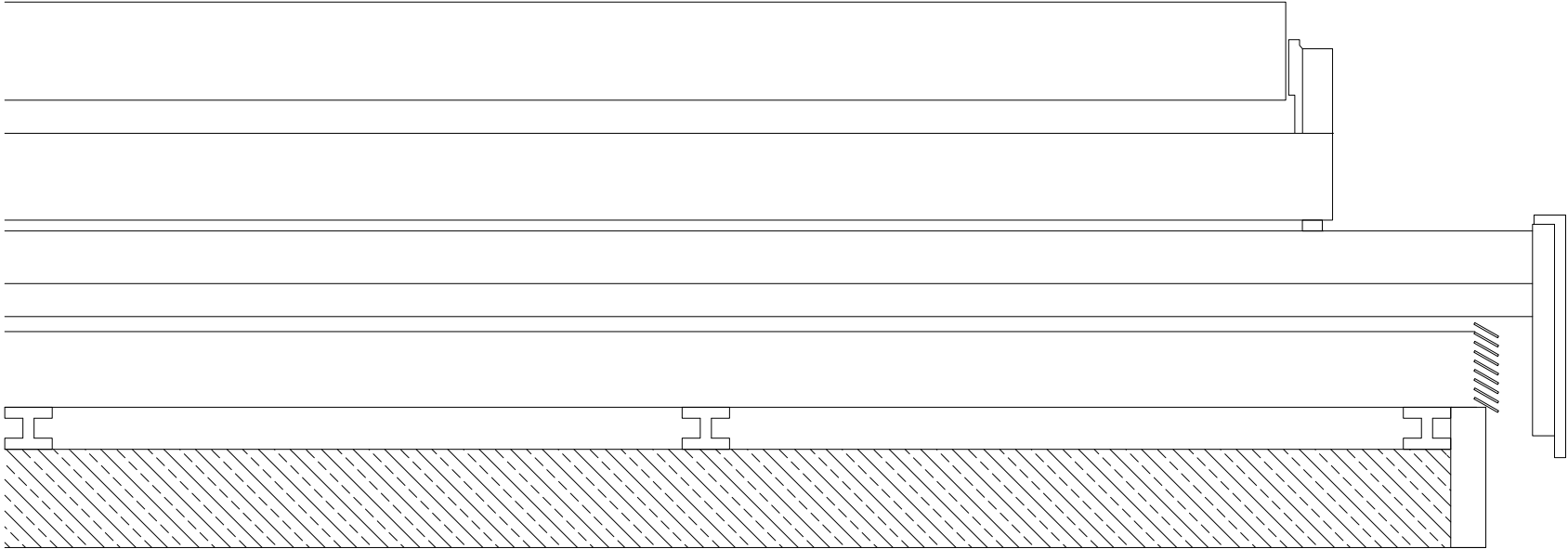

04 Section A-A' Scale 1.20

180323	Planning Application	00
170915	Issue	Rev

URBAN VISION

Title
Details

Project
King's Cross Square

Scale
1:200 - 1.20 @ A3

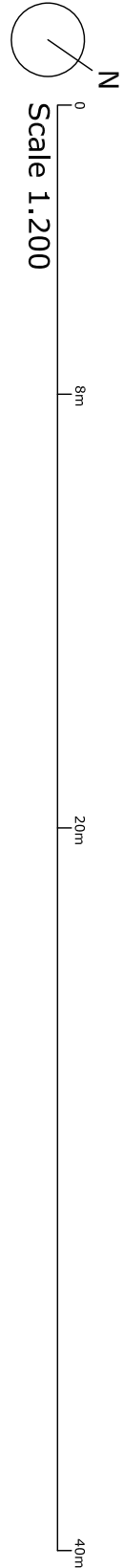

Scale 1.200