

PROPOSED SECTION AA LWR GRD AND GRD FLOOR

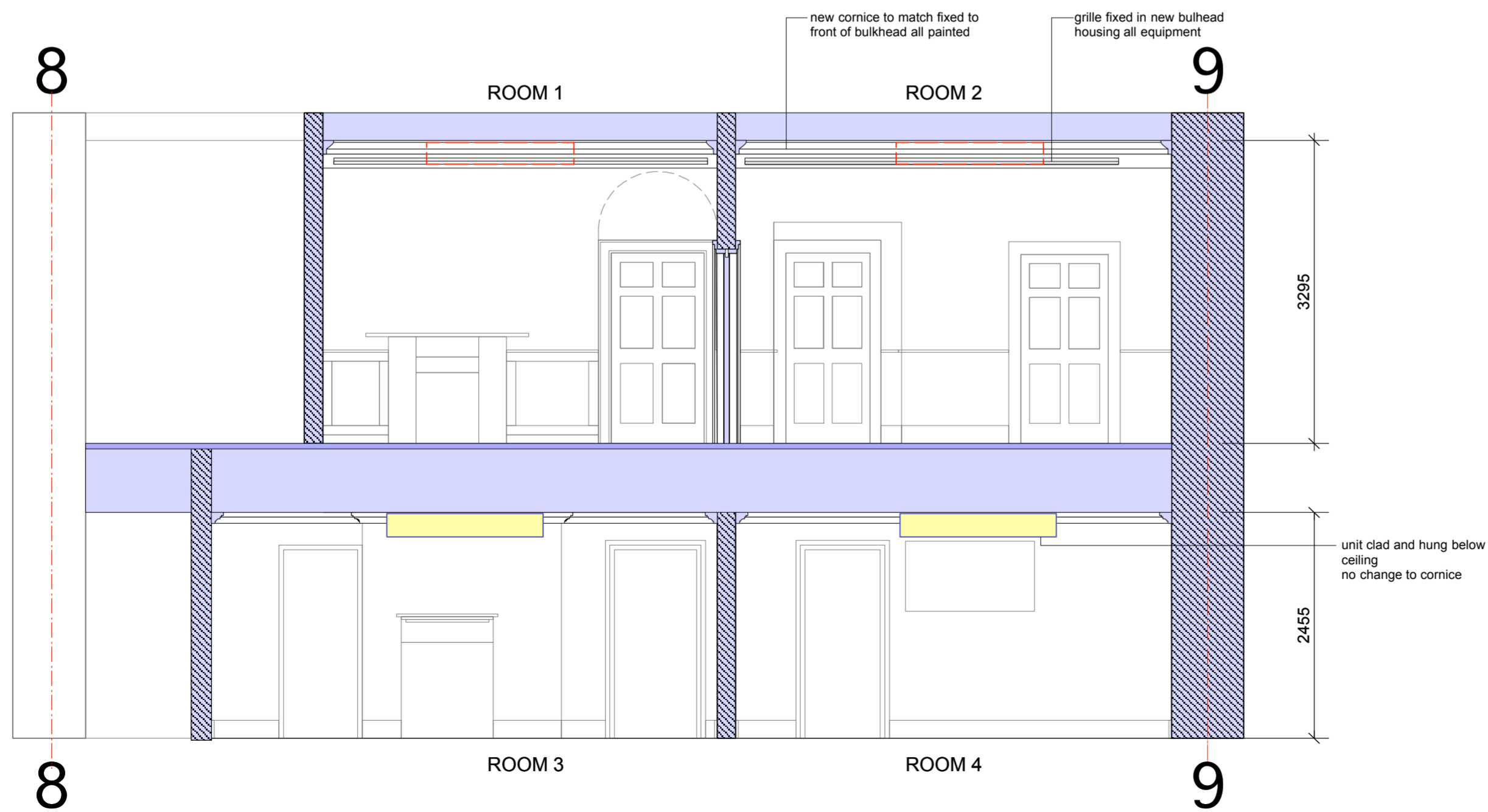

PROPOSED SECTION BB LWR GRD AND GRD FLOOR



GENERAL NOTES

- 1.0 No dimensions to be scaled all checked on site before commencing.
- 2.0 All work to comply with current Building Regulations and to be approved by the building control. Contractor to supply completion certificate to the client showing compliance.
Electrical contractor to issue certificate for all work including any work to the smoke detectors, the fire alarm and emergency lights.
- 3.0 No structural work to be carried out without written instruction of the client's structural engineer.
- 4.0 Contractor is to note the building is Grade 11* listed and no work to the original fabric of the building is to be carried out without approval from English Heritage, the local authority planning dept and Lincoln's Inn.

REVISIONS

- C 24.04.18 Bulkhead revised, notes added
- B 23.04.18 A/C added to Room 3 and 4 (lower ground floor)
- A 15.02.18 New work to kitchen deleted, pipe route simplified

PROJECT
WILBERFORCE CHAMBERS
8 NEW SQUARE WC2A 3QP

TITLE
NEW SECTIONS

DATE	SCALE	No	
20.11.17	1.50 @ A2	NS-6-203	C

TWO BY TWO DESIGN CONSULTANTS
 348 GOSWELL ROAD LONDON EC1V 7LQ T. 020 7278 1122