

CEILING TYPE 1

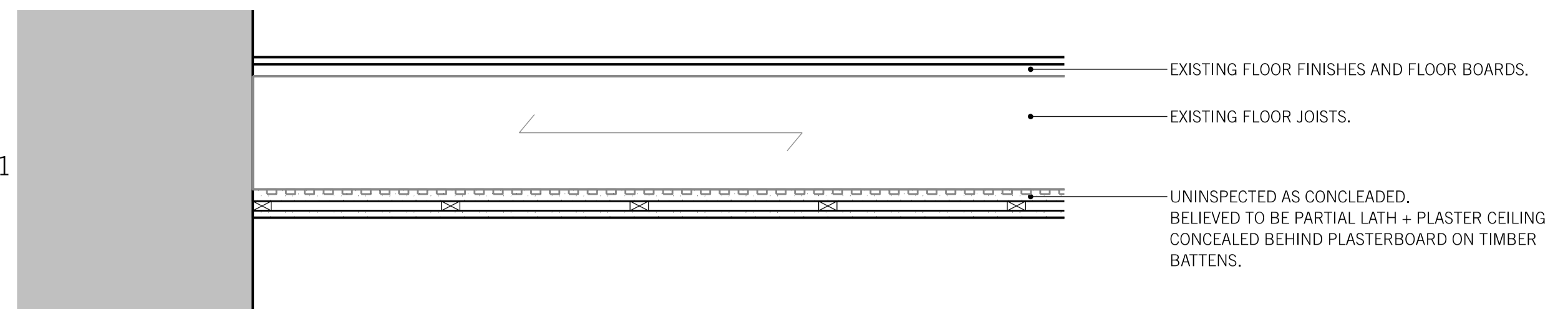

O1: EXISTING CEILING TYPE 1  
SCALE 1:10

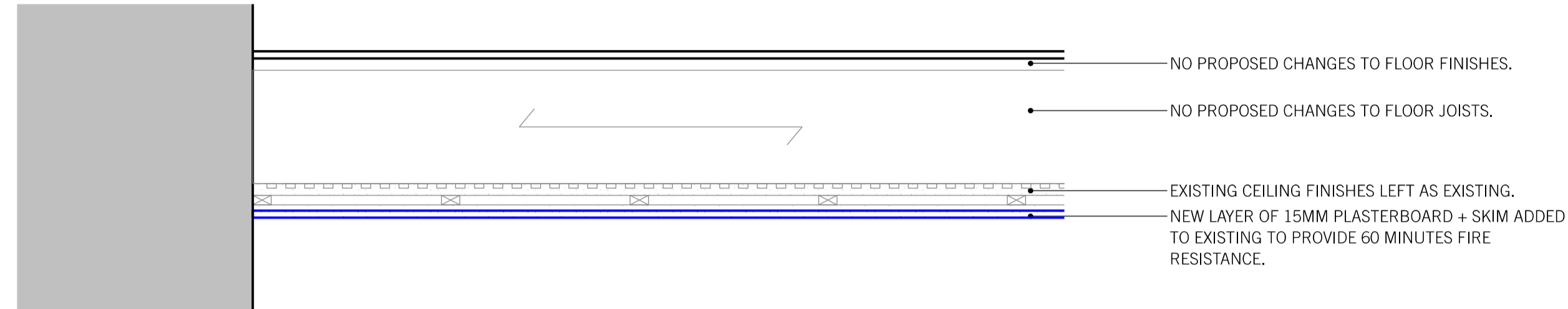

O2: PROPOSED CEILING TYPE 1  
SCALE 1:10

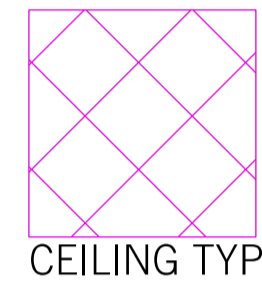

CEILING TYPE 2

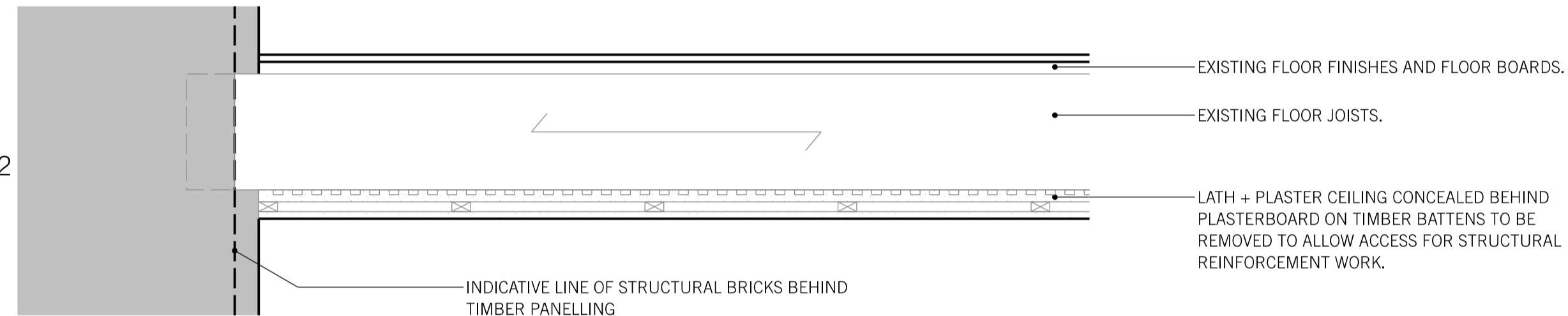

O3: EXISTING CEILING TYPE 2  
SCALE 1:10

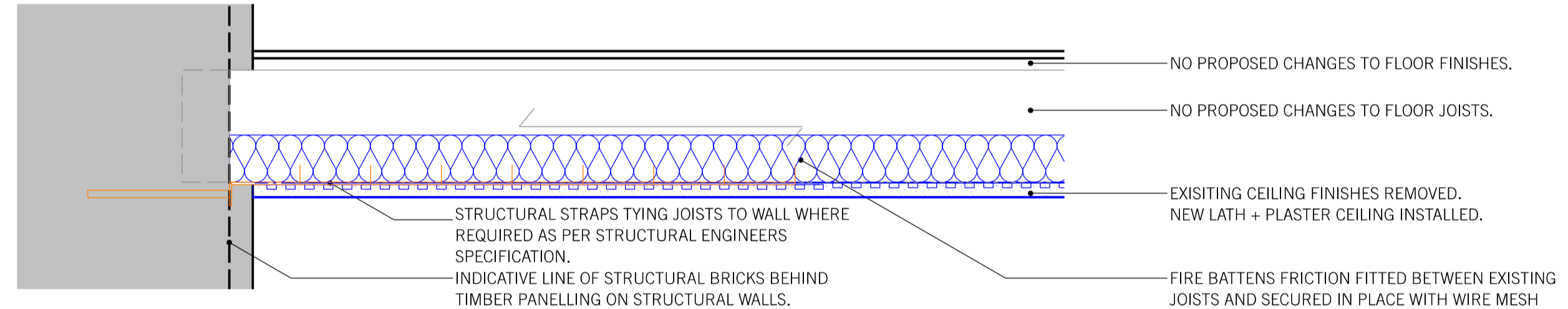

O4: PROPOSED CEILING TYPE 2  
SCALE 1:10

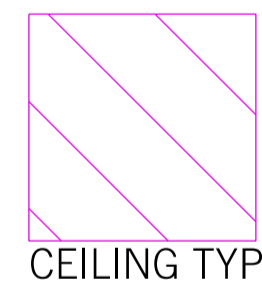

CEILING TYPE 3

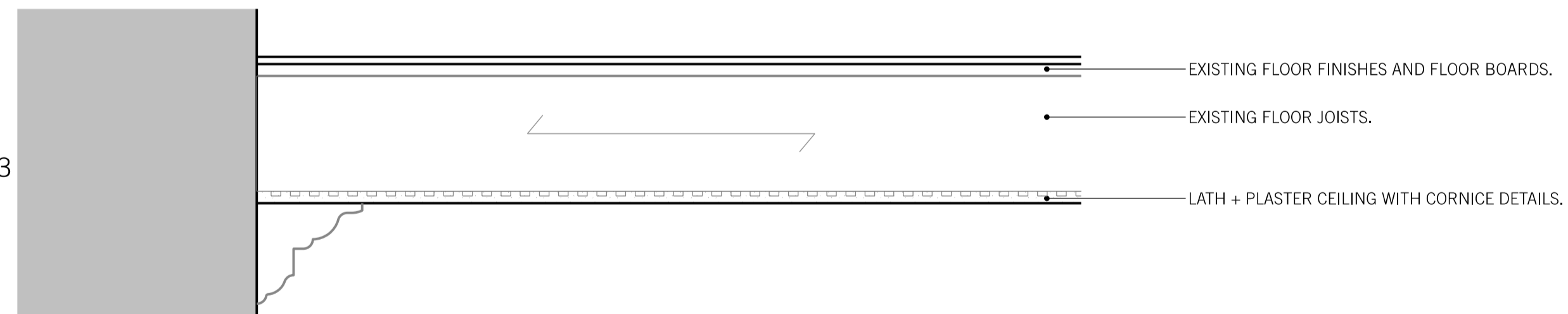

O5: EXISTING CEILING TYPE 3  
SCALE 1:10

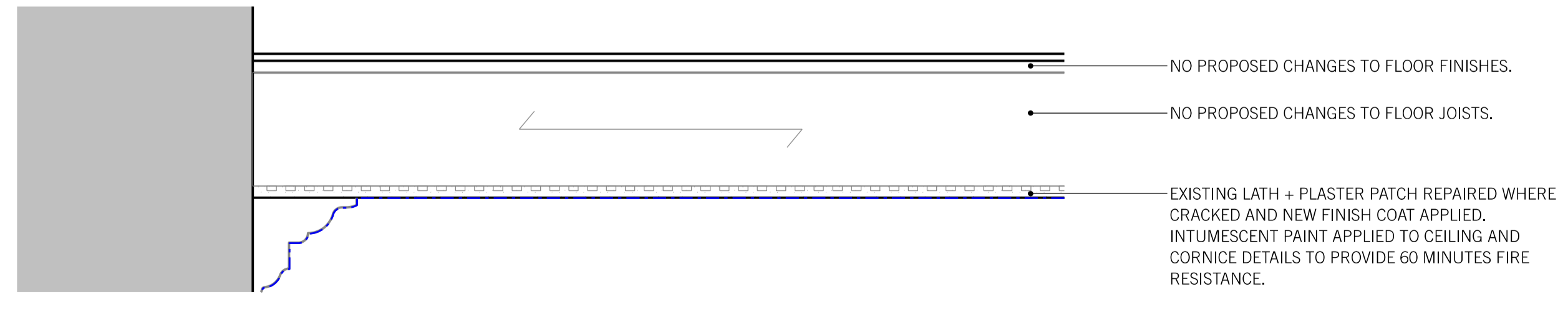

O6: PROPOSED CEILING TYPE 3  
SCALE 1:10

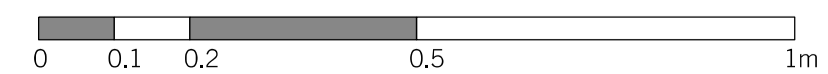

REV.	DATE	REASON FOR ISSUE	CHK. BY

NOTE:  
 - USE FIGURED DIMENSIONS ONLY.  
 - ALL DIMENSIONS TO BE CHECKED ON-SITE.  
 - ANY DISCREPANCIES BETWEEN CONSULTANT DRAWINGS TO BE REPORTED TO THE ARCHITECT BEFORE ANY WORK COMMENCES.  
 - MATTHEW SPRINGETT ASSOCIATES ©

**MSA**  
 MATTHEW SPRINGETT ASSOCIATES Ltd.  
 70 HATTON GARDEN  
 LONDON EC1N 8JT  
 T+44 (0)20 7692 5950  
 F+44 (0)20 7692 5951

CLIENT  
 HATTON GARDEN PROPERTIES LTD.

PROJECT  
 5 GREAT JAMES STREET

TITLE  
 CONSTRUCTION DETAIL.  
 CEILING IMPROVEMENT TO PROVIDE 60 MINUTE FIRE RESISTANCE.

DATE	JOB NO.	DRAWN BY	PURPOSE
25.04.18	177	AT	PL.
SCALE @ A1	NUMBER	REV.	
1:10	177A-710	-	