

1. Curtain Wall Door Head Detail A
SCALE - 1 : 5@A1

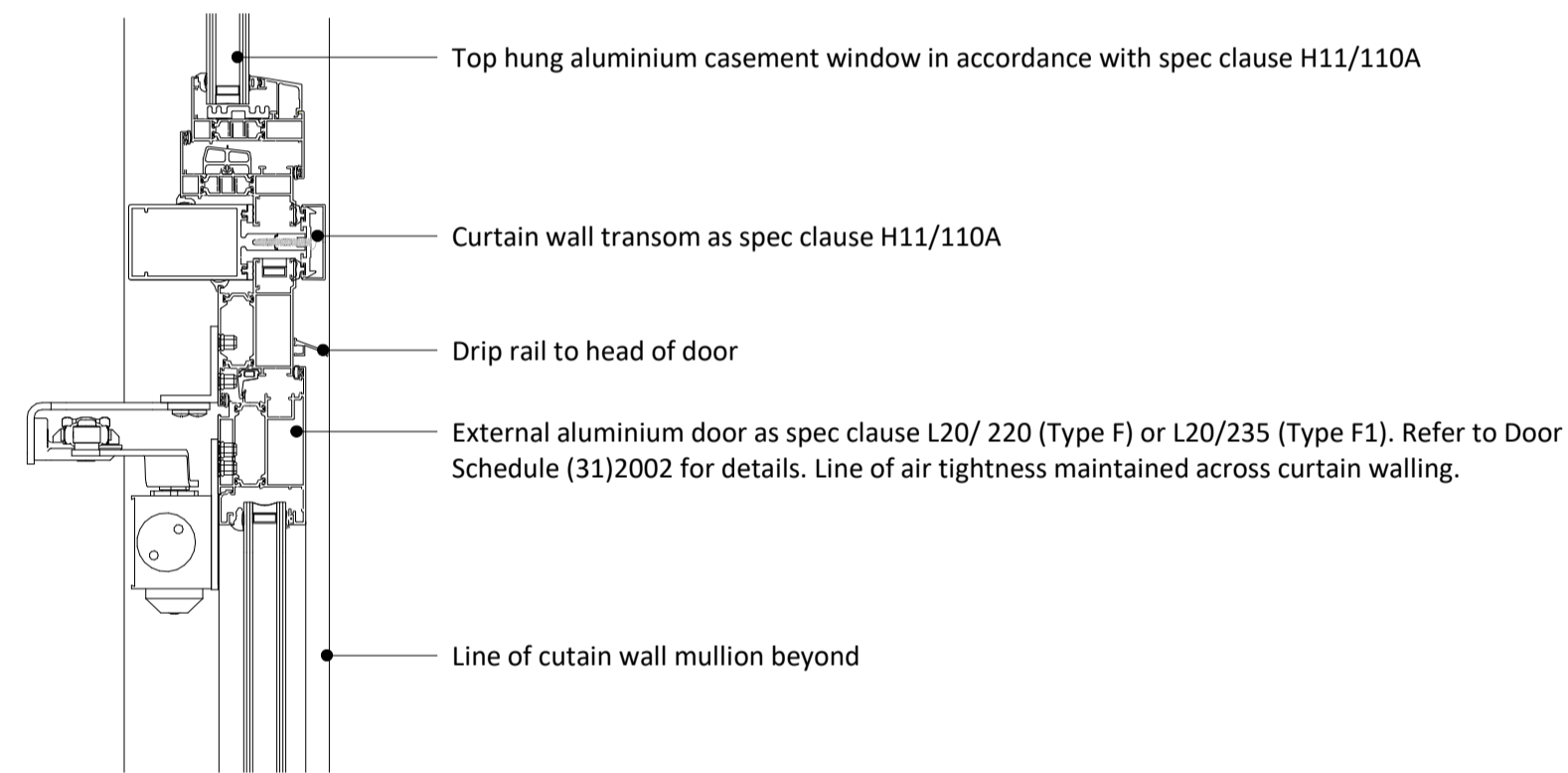

2. Curtain Wall Door Head Detail B
SCALE - 1 : 5@A1

Do not scale from this drawing for construction or acquisition purposes. Responsibility is not accepted for errors made by others in scaling from this drawing. All construction information must be taken from figured dimensions only. All dimensions and levels must be checked on site and discrepancies between drawings and specification must be reported to GSSArchitecture.
 © Copyright GSSArchitecture

Ordnance Survey © Crown Copyright 2017. All rights reserved. Licence number G55 100017356.

Map Data Copyright 2017 Google.

NOTE: Co-ordination of EPDM with VCL to ensure airtightness around curtain walling to be confirmed by curtain walling fabricator & indicated on the fabrication drawings. EPDM to be glazed into curtain wall system & fully bonded to create watertight seal. All penetrations in EPDM to be fully sealed.

Rev.	Date	Drawn	Check	Description
------	------	-------	-------	-------------

gssarchitecture
 35 HEADLANDS, KETTERING,
 NORTHANTS, NN15 7ES
 Telephone: 01536 513 165. Email: gss@gotch.co.uk,
 Web: www.gssarchitecture.com

Gloucester: 01452 525 019, Harrogate: 01423 815 121,
 Milton Keynes: 01908 255 620, Newcastle: 01913 898 917

Project Title:
 Parliament Hill School, William Ellis School
 and LaSWAP Sixth Form

Client:
 Farrans Construction

Drawing Title:
 Curtain Wall Details - Sheet 2

File Number: SCH284

Drawn By: CMB

Checked By: BFLA

Scale@A1: 1 : 5 **Date:** 21/12/17

Dwg No: (31) 2015 **Rev:**