

DO NOT SCALE

CONTRACTORS ARE RESPONSIBLE FOR SATISFYING THEMSELVES THAT THE DIMENSIONS AND DETAILS SHOWN ON THE DRAWINGS ARE CORRECT AND COMPLIANT WITH THE SPECIFICATION PRIOR TO MANUFACTURE. REPORT OMISSIONS AND ERRORS TO WINTECH.

CONTRACTORS ARE TO ENSURE THAT ALL COMPONENTS FORMING PART OF THEIR WORKS ARE FABRICATED AND INSTALLED IN ACCORDANCE WITH THE MANUFACTURERS RECOMMENDATIONS.

ALL ELEVATIONS VIEWED FROM THE OUTSIDE UNLESS OTHERWISE STATED

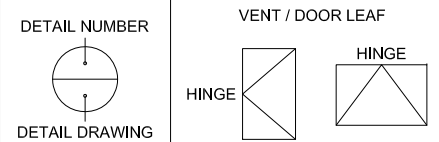

## KEY PLAN

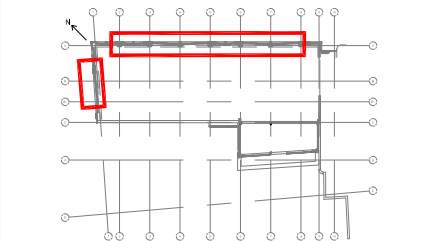

ALL DIMENSIONS SUBJECT TO FINAL BUILDING SURVEY  
FOLLOWING FACADE STRIP OUT

DRAWING BASED ON LATEST INFORMATION AVAILABLE.  
CONTRACTOR TO ALLOW FOR UPDATES TO DRAWINGS AND  
RE-SUBMISSION FOR CONSTRUCTION TO TAKE INTO  
ACCOUNT OF SURVEY BUILDING INFORMATION AND FINAL  
DESIGN/ENGINEERING

09	FIN REVISED	01.05.18	MAV	CA
08	CONSTRUCTION ISSUE	11.04.18	HB	CA
07	REVISED FOR PLANNING ISSUE	06.03.18	MAV	CA
06	FIN POSITION REVISED	06.02.18	MAV	CA
05	SCREEN RESIGN REVISED	12.01.18	MAV	CA
04	GLAZING REVISED	04.09.17	MAV	CA
03	CONSTRUCTION ISSUE	05.07.17	MAV	CA
02	ISSUED FOR INFORMATION	18.05.17	MAV	CA
01	DRAFT ISSUE	28.04.17	MAV	CA
No Revision		Date	Initial	Chk

**WINTech**  
 FAÇADE ENGINEERING CONSULTANCY  
 Quartz House, Pendeford Business Park,  
 Wobaston Road, Wolverhampton. WV9 5HA  
 Tel: +44(0)1902 307430 Email: [enquiries@wintech-group.co.uk](mailto:enquiries@wintech-group.co.uk)

Project Name: 182 - 184 HIGH HOLBORN,  
LONDON

Drawing Title: EWS-01: 1st FLOOR HORIZONTAL FIN  
DETAIL

Status: CONSTRUCTION	Scale: 1:5 @ A3	Date: 13.10.17
----------------------	-----------------	----------------

Project No : <b>02164</b>	Drawing No : <b>D-103</b>	Rev : <b>09</b>
------------------------------	------------------------------	--------------------