

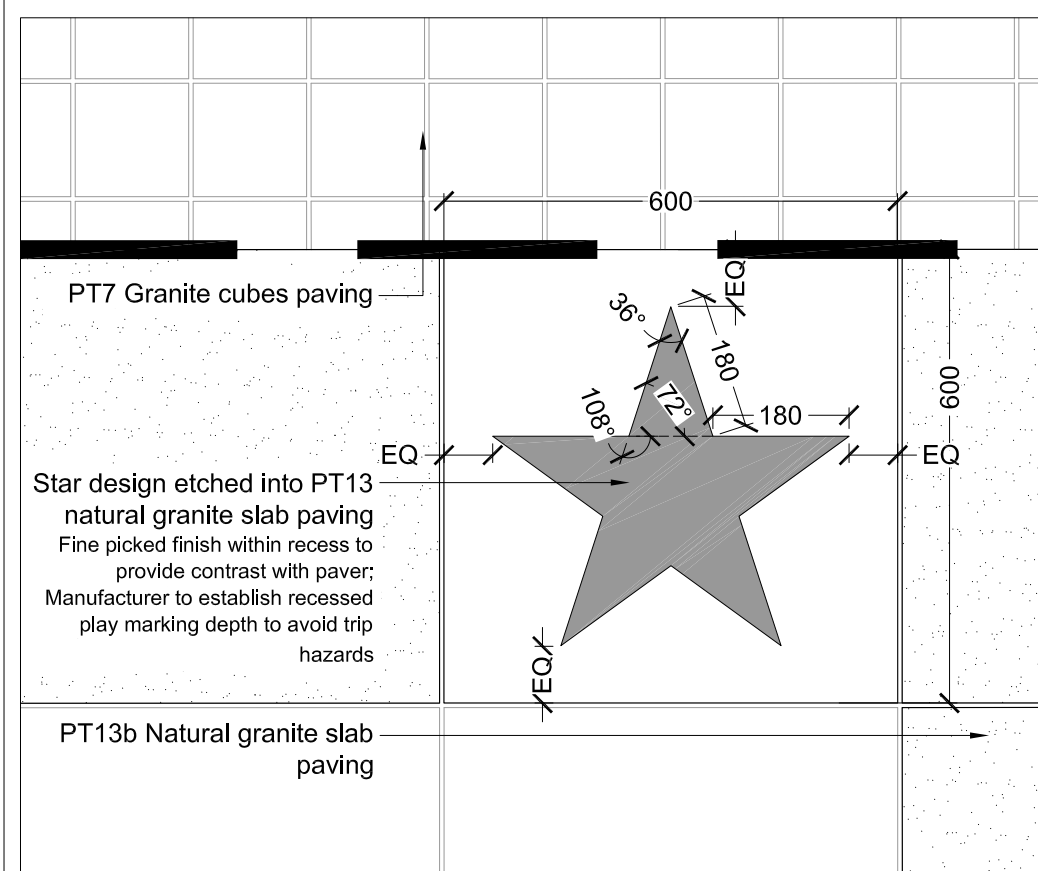

**1** Play Area Detailed Plan  
SCALE 1:50@A1

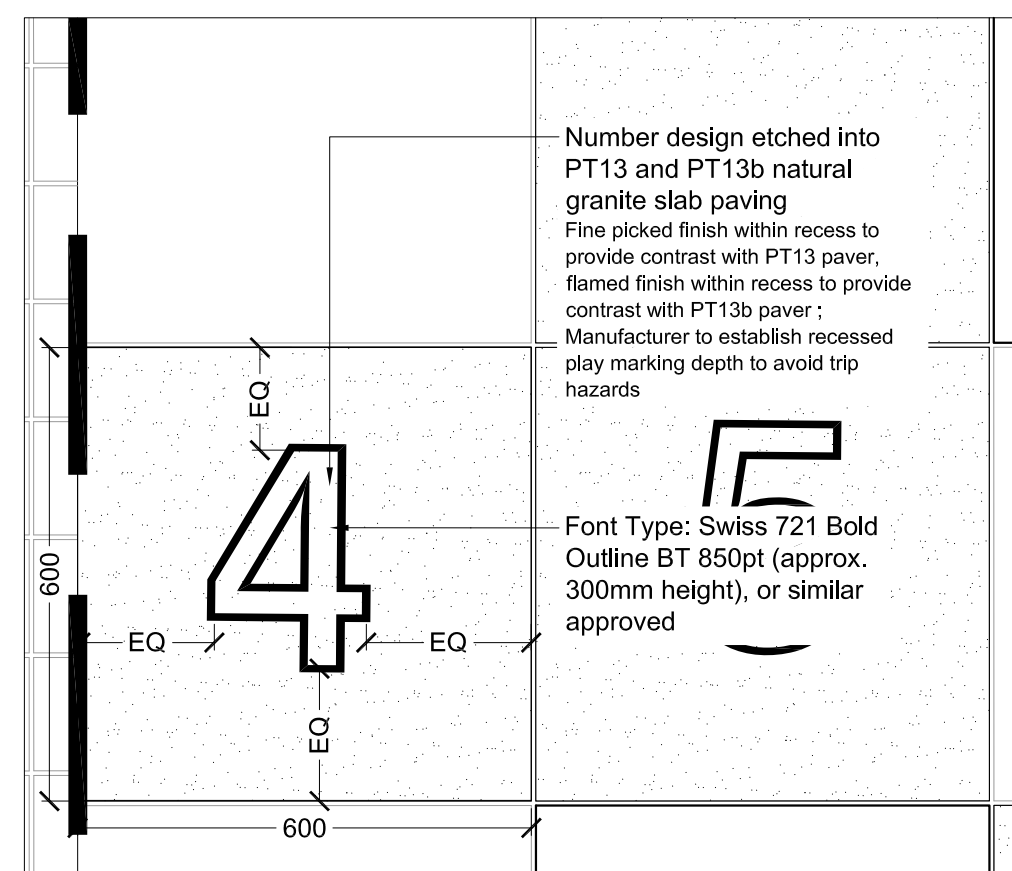

**2** Etched Play Pattern Detailed Plan  
SCALE 1:10@A1



**3** Etched Play Pattern Detailed Plan  
SCALE 1:10@A1

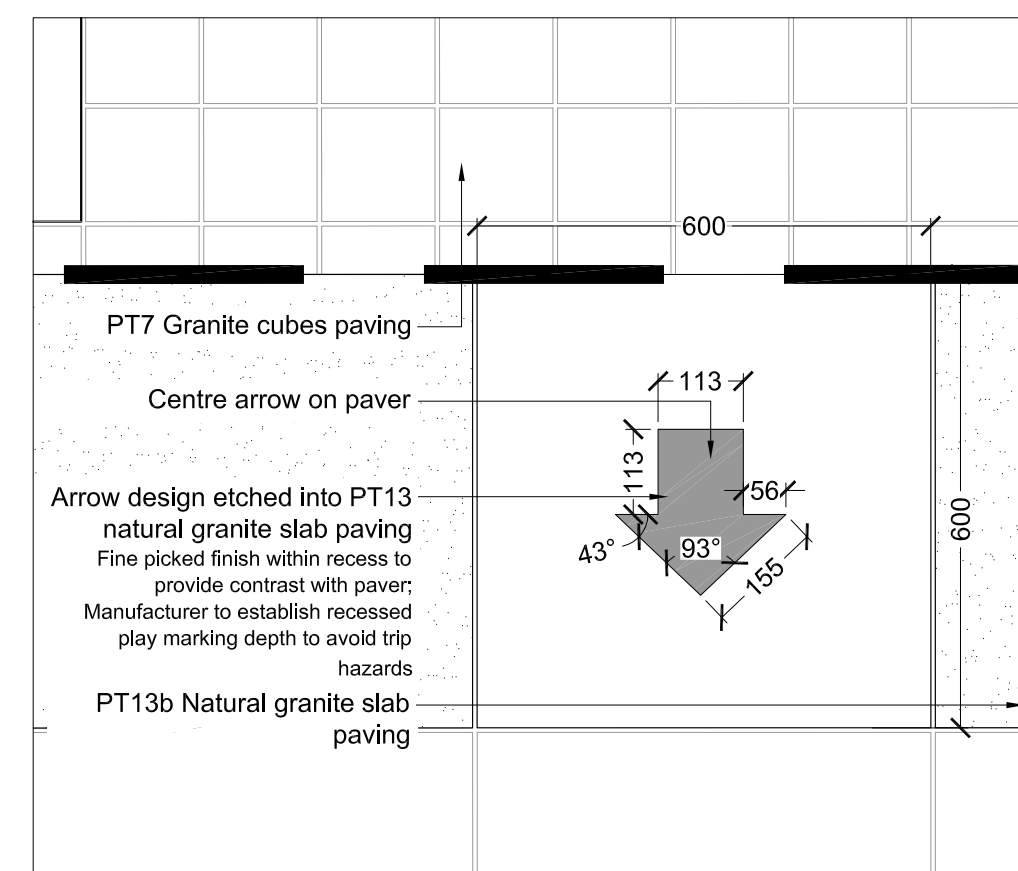

**4** Etched Play Pattern Detailed Plan  
SCALE 1:10@A1

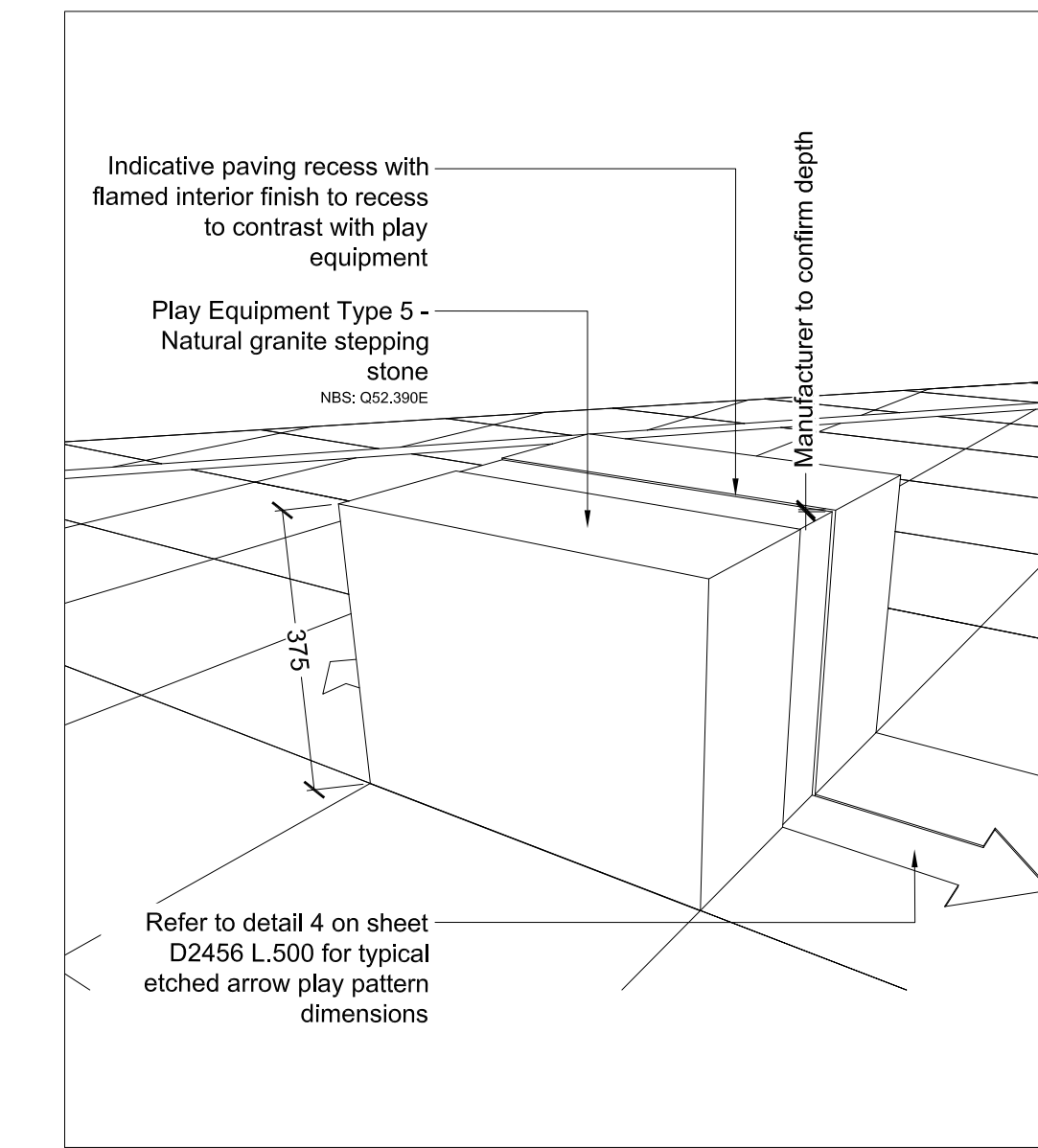

**6** Typical Etched Play Equipment Sketch  
SCALE NTS@A1

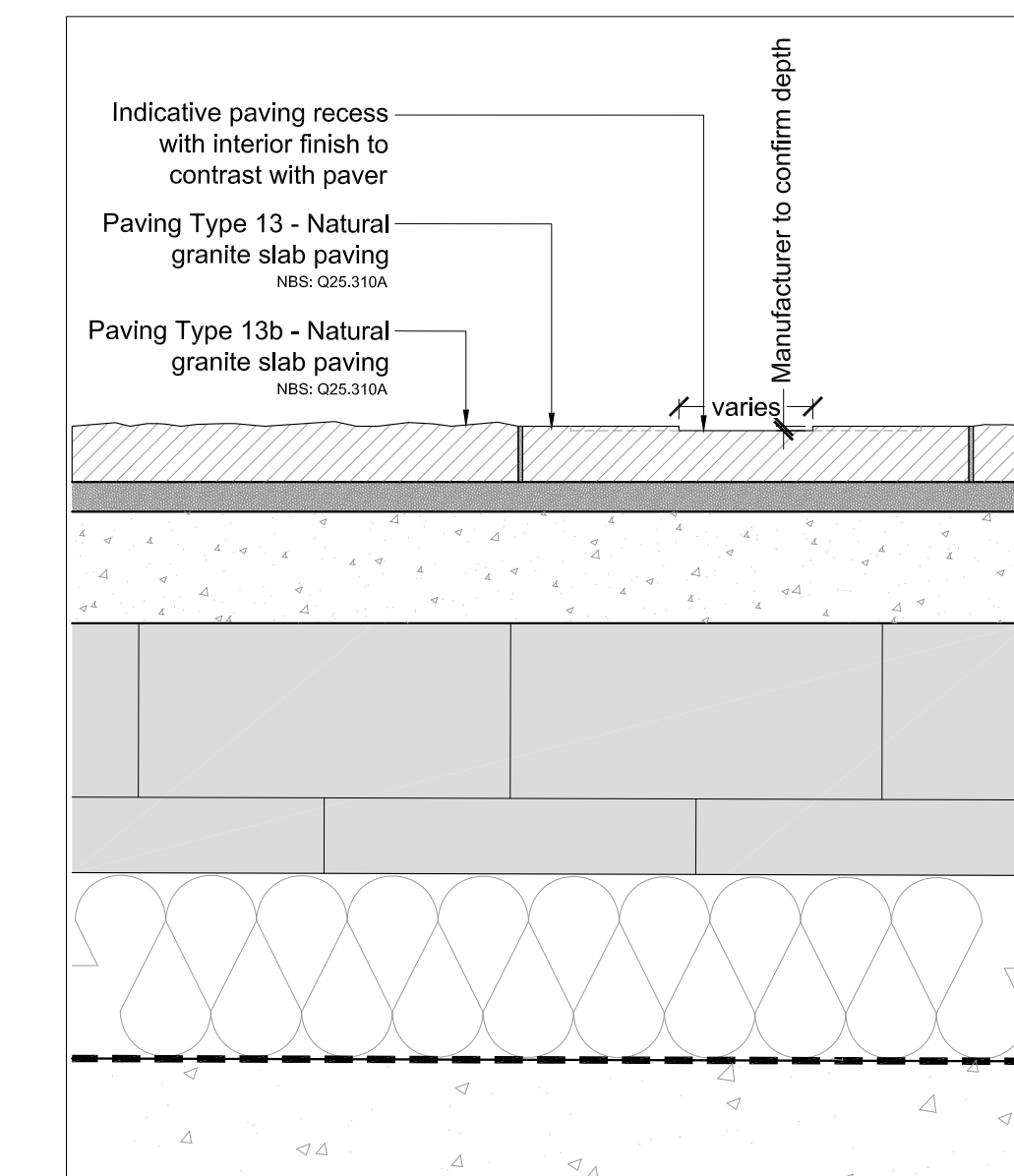

**5** Typical Etched Play Pattern Paver Section  
SCALE 1:10@A1

**General Notes:**

1. This drawing is the property of fabrik ltd. It must not be copied or reproduced without written consent.
2. This drawing shall be read in conjunction with all relevant contract drawings and specification with any conflicting information to be brought to the attention of fabrik ltd. before work commences.
3. All dimensions are in millimetres unless otherwise specified.
4. Only figured dimensions are to be taken from this drawing. All contractors must visit site and be responsible for taking and checking all dimensions related to the works shown on the drawing.
5. All dimensions and sizes of units to be verified by the contractor on shop drawings for each element before the commencement of works.



**Key Legend**

Proposed dimension	Proposed coordinates
1496	E523988,840 N184109,400
Paving folding line	Extent of level landing to be provided at entrance of retail units
Extent of landing to be provided at entrance of retail units	Channel Drain
PT13	Paving Type 13 - 600x600x75mm Natural Granite Slab Paving
PT13b	Paving Type 13b - 600x600x75mm Natural Granite Slab Paving
ST7	Seating Type 7 - 600mm (l) x 600mm (w) x 450mm (h) Granite Seating.
ST7b	Seating Type 7b - 618mm (l) x 618mm (w) x 450mm (h) Granite Seating.
PE5	Play Equipment Type 5 - 600mm (l) x 600mm (w) x 375mm (h) Granite stepping stone
PE5b	Play Equipment Type 5b - 600mm (l) x 600mm (w) x 200mm (h) Granite stepping stone
PE5c	Play Equipment Type 5c - 618mm (l) x 618mm (w) x 375mm (h) Granite stepping stone
PE5d	Play Equipment Type 5d - 618mm (l) x 618mm (w) x 200mm (h) Granite stepping stone

- NOTES:**
1. Application boundary line not shown for clarity, refer to Fabrik GA drawings for location;
  2. Drawing to be read in conjunction with the following fabrik drawings:  
D2456 L.200-L.211 - Ground Floor - Detailed Hard Landscape General Arrangement Plans  
D2456 L.600-L.610 - Ground Floor - Proposed Levels Plans
  3. Where coordinates are provided to paving folding lines, these are intended to set out key levels and falls and should be read in conjunction with drawings D2456 L.600-L.610.
  4. Levels duplicated and shown on the play area detailed plan to illustrate relationship to the paving pattern.

P1	23.04.18	Issued for planning approval	MN	MB
P0	28.07.2017	Issued for Stage F	MB	NB
No.	Date	Reason	Drawn	Checked
Revisions				

- External References:**
- 14045\_AX\_(00)\_1190\_iss7\_revF04
  - 14045\_AX\_(00)\_1200\_iss6\_revF03
  - 14045\_CX\_(00)\_1200\_iss5\_revC01
  - 14045\_EX\_(00)\_1200\_iss4\_revC01
  - 14045\_VX\_(00)\_1200\_iss4\_revF01
  - 14045\_WX\_(00)\_1200\_iss4\_revC01

**fabrik**

First Floor  
4-8 Emerson Street  
London  
SE1 9DU

T : 0207 620 1453  
E : london@fabrik.com  
W : www.fabrik.com

Project  
**Camden Lock Village, Camden Town, London for Mace**

Drawing  
**Ground Floor - Play Area - Detailed Plan**

Scale	Date	Checked	Drawn
1:50 @ A1	July '17	NB	MN
Drawing No.	Revision		
D2456 L.500	P1		

- |  |  |
|--|--|
| <input type="checkbox"/> Preliminary                             | <input type="checkbox"/> Issued for Design/Information |
| <input checked="" type="checkbox"/> Issued for Planning Approval | <input type="checkbox"/> Issued for Tender             |
| <input type="checkbox"/> Issued for Construction                 | <input type="checkbox"/> As Built                      |